



**Lewis Close, Corsham SN13 9EA**

**welcome to**

**Lewis Close, Corsham**

Allen&Harris are delighted to offer this Four Bedroom, Semi-Detached Town House for sale. Pleasantly situated within the ever popular Katherine Park, close to local schools and amenities. Generous Master Suite occupying the second floor.





**Ground Floor**

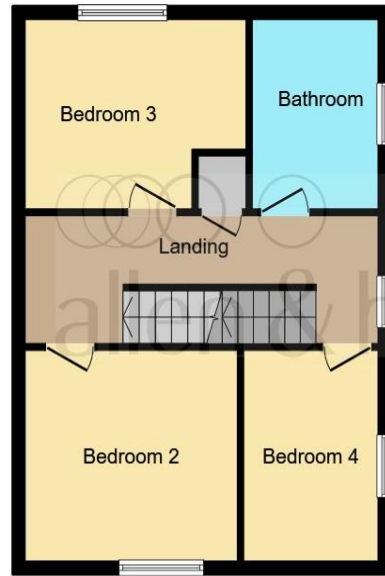

**First Floor**



**Second Floor**

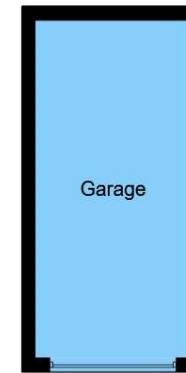

**Garage**

**Entrance Hallway**

**Living Room**

18' 8" x 10' 3" (5.69m x 3.12m)

**Kitchen/diner**

17' 6" x 17' 2" (5.33m x 5.23m)

**First Floor Landing**

**Bedroom Two**

11' 3" x 10' 4" (3.43m x 3.15m)

**Bedroom Three**

10' 4" x 7' 2" (3.15m x 2.18m)

**Bedroom Four**

11' 8" max x 9' 4" max (3.56m max x 2.84m max)

**Family Bathroom**

**Second Floor Landing**

**Master Suite**

**Bedroom**

16' 8" x 10' 3" (5.08m x 3.12m)

**Dressing Room**

15' 4" x 12' 9" (4.67m x 3.89m)

**En-Suite**

**Rear Garden**

**Garage**

This floorplan is for illustrative purposes only and is not drawn to scale. Measurements, floor-areas, openings and orientations are approximate. They should not be relied upon for any purpose and do not form any part of an agreement. No liability is taken for any error or mis-statement. All parties must rely on their own inspections.

welcome to

## Lewis Close, Corsham

- Very well-presented Four Bedroom Semi-Detached Town House.
- Spacious and flexible living accommodation.
- Pleasantly situated within Katherine Park.
- Generous Master Suite.
- Superb kitchen/diner.

Tenure: Freehold EPC Rating: Awaited

# £435,000



**view this property online** [allenandharris.co.uk/Property/COS106529](https://allenandharris.co.uk/Property/COS106529)

Please note the marker reflects the postcode not the actual property



Property Ref:  
COS106529 - 0012

1. MONEY LAUNDERING REGULATIONS Intending purchasers will be asked to produce identification documentation at a later stage and we would ask for your co-operation in order that there is no delay in agreeing the sale. 2. These particulars do not constitute part or all of an offer or contract. 3. The measurements indicated are supplied for guidance only and as such must be considered incorrect. Potential buyers are advised to recheck measurements before committing to any expense. 4. We have not tested any apparatus, equipment, fixtures or services and it is in the buyers interest to check the working condition of any appliances. 5. Where an EPC, or a Home Report (Scotland only) is held for this property, it is available for inspection at the branch by appointment. If you require a printed version of a Home Report, you will need to pay a reasonable production charge reflecting printing and other costs. 6. We are not able to offer an opinion either written or verbal on the content of these reports and this must be obtained from your legal representative. 7. Whilst we take care in preparing these reports, a buyer should ensure that his/her legal representative confirms as soon as possible all matters relating to title including the extent and boundaries of the property and other important matters before exchange of contracts.

Allen & Harris is a trading name of Sequence (UK) Limited which is registered in England and Wales under company number 4268443, Registered Office is Cumbria House, 16-20 Hockliffe Street, Leighton Buzzard, Bedfordshire, LU7 1GN. VAT Registration Number is 500 2481 05.

  
allen & harris



**01249 713877**



[corsham@allenandharris.co.uk](mailto:corsham@allenandharris.co.uk)



28 High Street, CORSHAM, Wiltshire, SN13 0HB



[allenandharris.co.uk](https://allenandharris.co.uk)