



Farme Castle Court, Rutherglen Glasgow G73 1AA

welcome to Farme Castle Court, Rutherglen Glasgow

- Three Bedrooms Including Loft Converted Room
- Driveway Providing Off-Street Parking
- Front & Rear Gardens
- Newly Fitted Kitchen
- Family Bathroom

Tenure: Freehold EPC Rating: D
Council Tax Band: D

offers over
£200,000

Situated on a quiet and popular street in the heart of Rutherglen, this well-presented 3-bedroom semi-detached home offers a perfect blend of comfort, space, and convenience-ideal for modern family living.

The property boasts a spacious driveway, a well-maintained front garden, and a generous rear garden, perfect for outdoor entertaining or children's play.

Inside, the home features a bright and airy dining room with patio doors that open directly onto the back garden, flooding the space with natural light and creating a seamless indoor-outdoor flow. The fitted kitchen and family bathroom are both well-appointed, offering functionality and comfort.

Upstairs, the loft has been professionally converted to create a spacious third bedroom, effectively maximising the living space and adding versatility for growing families or home working needs.

Located just moments from the M74 motorway and within easy reach of Glasgow City Centre, the home benefits from excellent transport links while enjoying the peace and quiet of a well-established neighbourhood.

This property is an excellent opportunity for families seeking a comfortable home in a sought-after area. Early viewing is highly recommended.

Entrance Hallway

Living Room

13' 2" x 12' 6" Max (4.01m x 3.81m Max)

Kitchen

8' 9" x 7' 3" (2.67m x 2.21m)

Dining Room

8' 9" x 8' 1" (2.67m x 2.46m)

Bedroom 1

Irregular Shaped Room 12' 3" x 12' 9" (3.73m x 3.89m)

Bedroom 2

10' 4" x 9' 1" (3.15m x 2.77m)

Bedroom 3

9' 9" x 9' 3" (2.97m x 2.82m)

Study

6' 7" x 5' 8" (2.01m x 1.73m)

Bathroom

6' 5" x 6' 3" (1.96m x 1.91m)

view this property online allenandharris.co.uk/Property/BSD108898



Property Ref:
BSD108898 - 0003

1. MONEY LAUNDERING REGULATIONS Intending purchasers will be asked to produce identification documentation at a later stage and we would ask for your co-operation in order that there is no delay in agreeing the sale. 2. These particulars do not constitute part or all of an offer or contract. 3. The measurements indicated are supplied for guidance only and as such must be considered incorrect. Potential buyers are advised to recheck measurements before committing to any expense. 4. We have not tested any apparatus, equipment, fixtures or services and it is in the buyers interest to check the working condition of any appliances. 5. Where an EPC, or a Home Report (Scotland only) is held for this property, it is available for inspection at the branch by appointment. If you require a printed version of a Home Report, you will need to pay a reasonable production charge reflecting printing and other costs. 6. We are not able to offer an opinion either written or verbal on the content of these reports and this must be obtained from your legal representative. 7. Whilst we take care in preparing these reports, a buyer should ensure that his/her legal representative confirms as soon as possible all matters relating to title including the extent and boundaries of the property and other important matters before exchange of contracts.



0141 613 3992



Burnside@allenandharris.co.uk



240 Stonelaw Road, Rutherglen, GLASGOW,
Lanarkshire, G73 3SA



allenandharris.co.uk

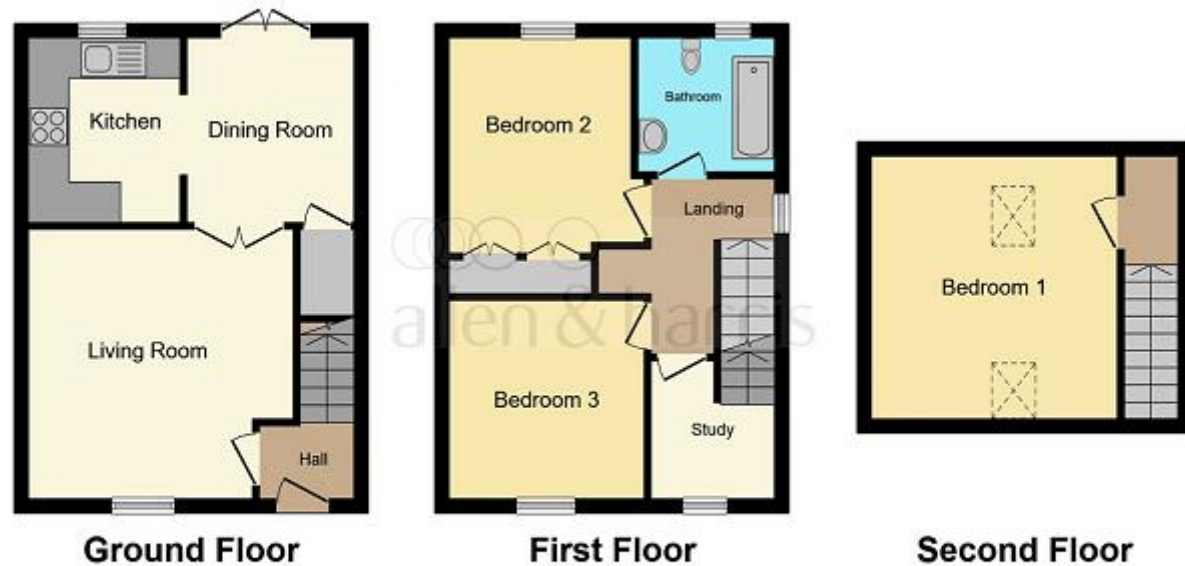

This floor plan is for illustrative purposes only. It is not drawn to scale. Any measurements, floor areas (including any total floor area), openings and orientation are approximate. No details are guaranteed, they cannot be relied upon for any purpose and they do not form part of any agreement. No liability is taken for any error, omission or misstatement. A party must rely upon its own inspection(s). Powered by www.focalagent.com

view this property online allenandharris.co.uk/Property/BSD108898

1. MONEY LAUNDERING REGULATIONS Intending purchasers will be asked to produce identification documentation at a later stage and we would ask for your co-operation in order that there is no delay in agreeing the sale. 2. These particulars do not constitute part or all of an offer or contract. 3. The measurements indicated are supplied for guidance only and as such must be considered incorrect. Potential buyers are advised to recheck measurements before committing to any expense. 4. We have not tested any apparatus, equipment, fixtures or services and it is in the buyers interest to check the working condition of any appliances. 5. Where an EPC, or a Home Report (Scotland only) is held for this property, it is available for inspection at the branch by appointment. If you require a printed version of a Home Report, you will need to pay a reasonable production charge reflecting printing and other costs. 6. We are not able to offer an opinion either written or verbal on the content of these reports and this must be obtained from your legal representative. 7. Whilst we take care in preparing these reports, a buyer should ensure that his/her legal representative confirms as soon as possible all matters relating to title including the extent and boundaries of the property and other important matters before exchange of contracts.

Property Ref:
BSD108898 - 0003

 **allen & harris**



0141 613 3992



Burnside@allenandharris.co.uk



240 Stonelaw Road, Rutherglen, GLASGOW,
Lanarkshire, G73 3SA



allenandharris.co.uk