



Annan Drive, Rutherglen Glasgow G73 3NN

welcome to

Annan Drive, Rutherglen Glasgow

- Semi Detached Bungalow
- Bright Spacious Lounge
- Modern Fitted Kitchen
- Two Bedrooms
- Family Bathroom

Tenure: Freehold EPC Rating: D

offers over

£250,000

Presented to the market is this stunning two bedroom semi detached bungalow with flexible living space, set within a quiet pocket of Rutherglen.

The property consists of entrance hallway, bright spacious bay window lounge, new modern fitted kitchen with a range of base and wall mounted storage units and access to the rear garden, two bedrooms (one can be utilised as dining room) and family bathroom. There is also a fixed staircase leading to two attic rooms.

The property further benefits from gas central heating and driveway. There are stunning gardens to the front and rear of the property. The rear garden has been recently upgraded and is very private.

Located within this popular and established locale the property is well placed for local amenities within nearby Rutherglen which cater for day to day requirements. Alternatively the area benefits from frequent public transport links which provide fast commuter access to nearby East Kilbride and Glasgow city centre. Access paths onto the M74 motorway network are reachable within a respectable 10 minutes drive.

Early viewing is advised.

Entrance Hallway

Lounge

14' 8" Into Bay x 11' 7" Max (4.47m Into Bay x 3.53m Max)

Kitchen

9' 5" x 9' 5" (2.87m x 2.87m)

Bedroom One

13' 8" Into Bay x 11' 1" Max (4.17m Into Bay x 3.38m Max)

Bedroom Two / Dining Room

11' 2" x 10' 2" (3.40m x 3.10m)

Bathroom

6' 3" x 6' 3" (1.91m x 1.91m)

Floored Attic Space 1

Irregular Shaped Room x (x)

Floored Attic Space 2

Irregular Shaped Room x (x)

view this property online allenandharris.co.uk/Property/BSD108541



Property Ref:

BSD108541 - 0002

1. MONEY LAUNDERING REGULATIONS Intending purchasers will be asked to produce identification documentation at a later stage and we would ask for your co-operation in order that there is no delay in agreeing the sale. 2. These particulars do not constitute part or all of an offer or contract. 3. The measurements indicated are supplied for guidance only and as such must be considered incorrect. Potential buyers are advised to recheck measurements before committing to any expense. 4. We have not tested any apparatus, equipment, fixtures or services and it is in the buyers interest to check the working condition of any appliances. 5. Where an EPC, or a Home Report (Scotland only) is held for this property, it is available for inspection at the branch by appointment. If you require a printed version of a Home Report, you will need to pay a reasonable production charge reflecting printing and other costs. 6. We are not able to offer an opinion either written or verbal on the content of these reports and this must be obtained from your legal representative. 7. Whilst we take care in preparing these reports, a buyer should ensure that his/her legal representative confirms as soon as possible all matters relating to title including the extent and boundaries of the property and other important matters before exchange of contracts.



0141 613 3992



Burnside@allenandharris.co.uk



240 Stonelaw Road, Rutherglen, GLASGOW,
Lanarkshire, G73 3SA



allenandharris.co.uk



Ground Floor

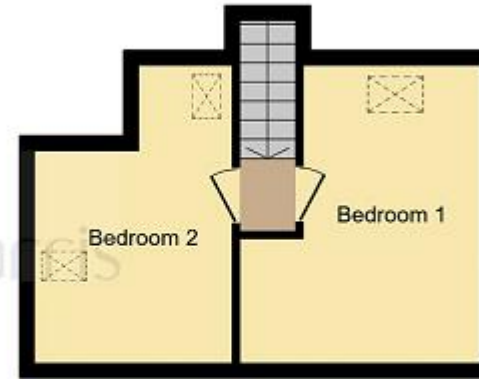

First Floor

This floor plan is for illustrative purposes only. It is not drawn to scale. Any measurements, floor areas (including any total floor area), openings and orientation are approximate. No details are guaranteed, they cannot be relied upon for any purpose and they do not form part of any agreement. No liability is taken for any error, omission or misstatement. A party must rely upon its own inspection(s). Powered by www.focalagent.com

view this property online allenandharris.co.uk/Property/BSD108541

1. MONEY LAUNDERING REGULATIONS Intending purchasers will be asked to produce identification documentation at a later stage and we would ask for your co-operation in order that there is no delay in agreeing the sale. 2. These particulars do not constitute part or all of an offer or contract. 3. The measurements indicated are supplied for guidance only and as such must be considered incorrect. Potential buyers are advised to recheck measurements before committing to any expense. 4. We have not tested any apparatus, equipment, fixtures or services and it is in the buyers interest to check the working condition of any appliances. 5. Where an EPC, or a Home Report (Scotland only) is held for this property, it is available for inspection at the branch by appointment. If you require a printed version of a Home Report, you will need to pay a reasonable production charge reflecting printing and other costs. 6. We are not able to offer an opinion either written or verbal on the content of these reports and this must be obtained from your legal representative. 7. Whilst we take care in preparing these reports, a buyer should ensure that his/her legal representative confirms as soon as possible all matters relating to title including the extent and boundaries of the property and other important matters before exchange of contracts.

Property Ref:
BSD108541 - 0002



0141 613 3992



Burnside@allenandharris.co.uk



240 Stonelaw Road, Rutherglen, GLASGOW,
Lanarkshire, G73 3SA



allenandharris.co.uk