



Kirkwood Drive, Redcar TS10 2SX

welcome to

Kirkwood Drive, Redcar

This well-presented 2-bedroom semi-detached home is located in a popular area of Redcar, perfect for first-time buyers, downsizers, or investors. Externally, the property benefits from a driveway to the front providing off-street parking, and a turfed rear garden, ideal for relaxing or entertaining.

Entrance Hall

Entered via UPVC double glazed door, stairs to first floor, access to downstairs W/C, radiator, understairs storage.

Kitchen

5' 10" x 12' (1.78m x 3.66m)

Range of base and wall units, complementary work surfaces, UPVC double glazed window to front, 1 1/2 bowl sink with draining board and mixer tap, four ring gas hob, integral electric oven, recess for under counter appliances.

lounge

13' 8" x 12' 2" (4.17m x 3.71m)

UPVC double glazed patio doors to rear, radiator, electric fire with decorative fire surround, TV point, telephone point.

Downstairs W/C

W/C, wash hand basin with mixer tap, UPVC double glazed window to front, radiator.

Landing

Void loft access.

Bedroom 1

12' 2" x 10' 6" (3.71m x 3.20m)

UPVC double glazed window to front, radiator, built in storage cupboard, TV point.

Bedroom 2

12' 2" x 8' 2" (3.71m x 2.49m)

UPVC double glazed window to rear, radiator.

Bathroom

Radiator, W/C, wash hand basin with mixer tap, bath with mixer taps, wall mounted shower, UPVC double glazed window to side, spotlights to ceiling,

Externally

Front Garden

Driveway to the front.

Rear Garden

Small patio seating area, turfed rear garden, enclosed by timber fencing.





view this property online mannersandharrison.co.uk/Property/MAR110819



welcome to

Kirkwood Drive, Redcar

- IDEAL FOR FIRST TIME BUYER/INVESTMENT
- DOWNSTAIRS W/C
- SPACIOUS LOUNGE
- MODERN KITCHEN
- DRIVEWAY

Tenure: Freehold EPC Rating: C

£155,000

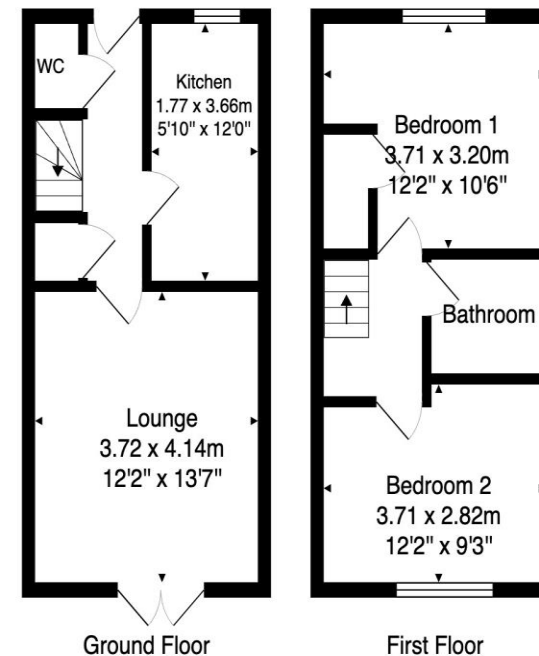

Total Area: 59.2 m² ... 637 ft²

All measurements are approximate and for display purposes only.

No liability is accepted by either the agency or Box Property Solutions Ltd as to the exact measurements of the rooms.
Box Property Solutions Ltd retains the copyright on this plan and allows agents to use it with agreed permission.

view this property online mannersandharrison.co.uk/Property/MAR110819



Property Ref:
MAR110819 - 0003

1. MONEY LAUNDERING REGULATIONS Intending purchasers will be asked to produce identification documentation at a later stage and we would ask for your co-operation in order that there is no delay in agreeing the sale. 2. These particulars do not constitute part or all of an offer or contract. 3. The measurements indicated are supplied for guidance only and as such must be considered incorrect. Potential buyers are advised to recheck measurements before committing to any expense. 4. We have not tested any apparatus, equipment, fixtures or services and it is in the buyers interest to check the working condition of any appliances. 5. Where an EPC, or a Home Report (Scotland only) is held for this property, it is available for inspection at the branch by appointment. If you require a printed version of a Home Report, you will need to pay a reasonable production charge reflecting printing and other costs. 6. We are not able to offer an opinion either written or verbal on the content of these reports and this must be obtained from your legal representative. 7. Whilst we take care in preparing these reports, a buyer should ensure that his/her legal representative confirms as soon as possible all matters relating to title including the extent and boundaries of the property and other important matters before exchange of contracts.

Manners & Harrison is a trading name of Sequence (UK) Limited which is registered in England and Wales under company number 4268443, Registered Office is Cumbria House, 16-20 Hockliffe Street, Leighton Buzzard, Bedfordshire, LU7 1GN. VAT Registration Number is 500 2481 05.

manners & harrison



01642 311133



Marion@mannersandharrison.co.uk



30 & 30a Stokesley Road, Marton,
MIDDLESBROUGH, Cleveland, TS7 8DX



mannersandharrison.co.uk