



**Whin Meadows, Hartlepool TS24 9NT**

**welcome to**

## **Whin Meadows, Hartlepool**

Three bedroomed, detached home in Whin Meadows, close to local amenities, shops and transport links. A great first time buyer opportunity for anyone looking to get on the property ladder.

### **Entrance Hallway**

Entered via wooden double glazed door, wood flooring, radiator, doors leading to all principle rooms.

### **Kitchen**

9' 7" x 7' 9" ( 2.92m x 2.36m )

UPVC double glazed window to front, tiled flooring, radiator, range of grey wall and base units with contrasting working surfaces, tiled splashback, recess and plumbing for dishwasher, stainless steel sink/drainage with swan neck mixer tap, inset electric oven, 4 ring gas hob, recess and plumbing for washing machine, space for free standing fridge freezer.

### **Reception Room 2**

14' 2" x 7' 4" ( 4.32m x 2.24m )

(previously the garage), UPVC double glazed window to front, built in storage cupboard housing boiler.

### **Downstairs W C**

UPVC double glazed window to side, low level low flush WC, wash hand basin on a vanity unit with a tiled splashback, anthracite grey vertical radiator, wood flooring.

### **Lounge / Diner**

14' 3" maximum x 20' 3" ( 4.34m maximum x 6.17m )

UPVC double glazed window to rear, UPVC double glazed sliding doors to rear, 2 radiators, TV point, spotlights to ceiling, wood flooring, stairs leading to first floor.

### **First Floor Landing**

Loft hatch access with pull down ladder, airing cupboard, water tank, radiator.

### **Bedroom 1**

11' 1" x 11' 1" ( 3.38m x 3.38m )

UPVC double glazed window to rear, 2 door mirrored built in sliding wardrobes.

### **En Suite**

UPVC double glazed window to side, low level low flush WC, wash hand basin on a vanity unit with tiled splashback, walk in shower cubicle with tiled surround with rainfall shower head and hand held attachment, spotlights to ceiling, chrome heated towel rail, extractor fan.

### **Bedroom 2**

11' 1" maximum x 12' 10" ( 3.38m maximum x 3.91m )

UPVC double glazed window to front, radiator, 2 door built in sliding mirrored wardrobes.

### **Bedroom 3**

9' 1" onto wardrobes x 8' 11" maximum ( 2.77m onto wardrobes x 2.72m maximum )

UPVC double glazed window to front, radiator, 2 door sliding mirrored wardrobe.

### **Bathroom**

UPVC double glazed window to rear, low level low flush WC, pedestal wash hand basin, panelled bath with shower over, extractor fan, vinyl flooring, radiator.





### Externally

#### Front

Block paved driveway for 2 cars, open plan lawned area.

#### Rear Garden

Fence enclosed, predominately laid to lawn with patio area, shed, access to the front of the property from the side gate.



***view this property online*** [mannersandharrison.co.uk/Property/HAR118936](https://mannersandharrison.co.uk/Property/HAR118936)



welcome to

## Whin Meadows, Hartlepool

- 2 RECEPTION ROOMS
- 3 DOUBLE BEDROOMS
- MASTER BEDROOM WITH ENSUITE
- DRIVEWAY
- CLOSE TO LOCAL AMENITIES

Tenure: Freehold EPC Rating: C  
Council Tax Band: C

**£165,000**

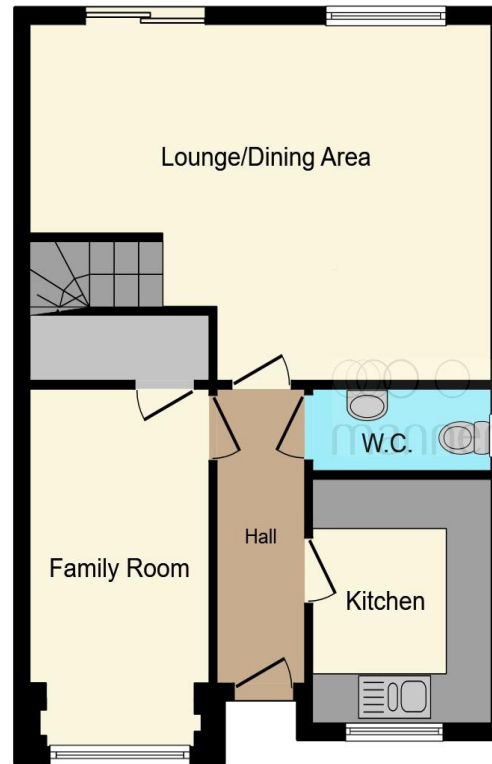

**Ground Floor**



**First Floor**

This floor plan is for illustrative purposes only. It is not drawn to scale. Any measurements, floor areas (including any total floor area), openings and orientation are approximate. No details are guaranteed, they cannot be relied upon for any purpose and they do not form part of any agreement. No liability is taken for any error, omission or misstatement. A party must rely upon its own inspection(s). Powered by [www.focalagent.com](http://www.focalagent.com)

**view this property online** [mannersandharrison.co.uk/Property/HAR118936](http://mannersandharrison.co.uk/Property/HAR118936)

Under the terms of the Estate Agency Act 1979 (Section 21), please note that the vendor is an Employee of the Connells



Property Ref:  
HAR118936 - 0003

1. MONEY LAUNDERING REGULATIONS Intending purchasers will be asked to produce identification documentation at a later stage and we would ask for your co-operation in order that there is no delay in agreeing the sale. 2. These particulars do not constitute part or all of an offer or contract. 3. The measurements indicated are supplied for guidance only and as such must be considered incorrect. Potential buyers are advised to recheck measurements before committing to any expense. 4. We have not tested any apparatus, equipment, fixtures or services and it is in the buyers interest to check the working condition of any appliances. 5. Where an EPC, or a Home Report (Scotland only) is held for this property, it is available for inspection at the branch by appointment. If you require a printed version of a Home Report, you will need to pay a reasonable production charge reflecting printing and other costs. 6. We are not able to offer an opinion either written or verbal on the content of these reports and this must be obtained from your legal representative. 7. Whilst we take care in preparing these reports, a buyer should ensure that his/her legal representative confirms as soon as possible all matters relating to title including the extent and boundaries of the property and other important matters before exchange of contracts.

Manners & Harrison is a trading name of Sequence (UK) Limited which is registered in England and Wales under company number 4268443, Registered Office is Cumbria House, 16-20 Hockliffe Street, Leighton Buzzard, Bedfordshire, LU7 1GN. VAT Registration Number is 500 2481 05.

manners & harrison



**01429 261351**



[Hartlepool@mannersandharrison.co.uk](mailto:Hartlepool@mannersandharrison.co.uk)



Shrewsbury House 129 York Road,  
HARTLEPOOL, Durham, TS26 9DW



**[mannersandharrison.co.uk](http://mannersandharrison.co.uk)**