



**Chester Road, Hartlepool TS24 8FD**

**welcome to**

## **Chester Road, Hartlepool**

Deceptively spacious, this wonderful three bedroomed end terrace town house is bright and airy throughout. Suitable for a range of buyers including first time buyers and young families. Viewings come highly recommended to appreciate everything this modern home has to offer.

### **Entrance Hallway**

Entered via composite double glazed door, stairs to first floor, doors leading to all principal rooms, radiator, built in storage cupboard.

### **Kitchen**

7' 10" Max x 16' 8" Max ( 2.39m Max x 5.08m Max )  
UPVC double glazed window to front, range of wood effect wall and base units with contrasting working surfaces, tiled splashback, inset electric oven, 4-ring gas hob, wall mounted combi boiler housed in a cupboard, stainless steel sink/drainage unit with mixer tap, space for dining table, radiator, vinyl flooring.

### **Ground Floor Wc**

UPVC double glazed window to side, wall mounted wash hand basin, radiator, low level low flush wc, vinyl flooring, extractor fan.

### **Lounge**

13' 8" x 12' 10" ( 4.17m x 3.91m )  
UPVC double glazed French doors to the rear garden with window panels either side, two radiators, TV point.

### **First Floor**

### **Landing**

Stairs from first floor, UPVC double glazed window to side, radiator.

### **Bedroom 2**

12' 5" x 12' 10" ( 3.78m x 3.91m )  
UPVC double glazed window to rear, radiator.

### **Family Bathroom**

Panelled bath with mixer tap and hand held shower attachment, decorative tiled surround, pedestal wash hand basin with matching tiled surround, low level low flush wc, radiator, extractor fan, vinyl flooring.

### **Bedroom 3**

6' 3" x 11' 1" ( 1.91m x 3.38m )  
UPVC double glazed window to front, radiator, TV point.

### **Second Floor Landing**

UPVC double glazed window to side, radiator.

### **Bedroom 1**

12' 11" x 11' 9" Excluding dressing area ( 3.94m x 3.58m Excluding dressing area )  
Two skylight windows to rear, radiator, TV point, part restricted headheight, walk in dressing area ( 5'7 x 5'9 ) with a large storage cupboard, loft hatch access.

### **Ensuite**

UPVC double glazed window to front, radiator, low level low flush wc, pedestal wash hand basin with tiled splashback, walk-in double shower cubicle with electric shower, vinyl flooring.







### **Externally**

#### **Rear Garden**

Fence enclosed with artificial lawn, gated side access leading to the garage.

#### **Front Garden**

Wrought iron enclosed low maintenance garden with flagstones and artificial turf, driveway with space for 3 cars leading to the garage to rear.

#### **Garage**

Up and over door.



***view this property online*** [mannersandharrison.co.uk/Property/HAR119126](http://mannersandharrison.co.uk/Property/HAR119126)



welcome to

## Chester Road, Hartlepool

- KITCHEN/DINER
- GROUND FLOOR WC
- MASTER BEDROOM WITH ENSUITE & DRESSING AREA
- FRONT AND REAR GARDENS
- LONG DRIVEWAY & GARAGE

Tenure: Freehold EPC Rating: C

**£145,000**

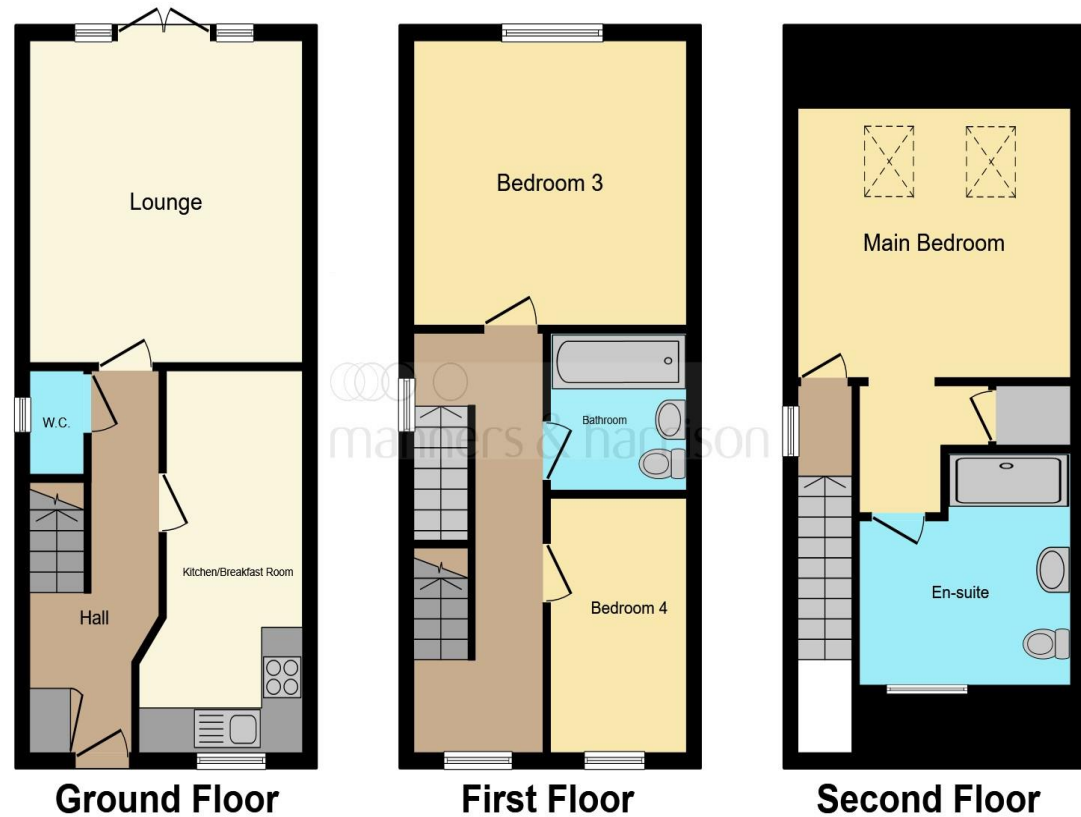

This floor plan is for illustrative purposes only. It is not drawn to scale. Any measurements, floor areas (including any total floor area), openings and orientation are approximate. No details are guaranteed, they cannot be relied upon for any purpose and they do not form part of any agreement. No liability is taken for any error, omission or misstatement. A party must rely upon its own inspection(s). Powered by [www.focalagent.com](http://www.focalagent.com)

**view this property online** [mannersandharrison.co.uk/Property/HAR119126](http://mannersandharrison.co.uk/Property/HAR119126)



Property Ref:  
HAR119126 - 0002

1. MONEY LAUNDERING REGULATIONS Intending purchasers will be asked to produce identification documentation at a later stage and we would ask for your co-operation in order that there is no delay in agreeing the sale. 2. These particulars do not constitute part or all of an offer or contract. 3. The measurements indicated are supplied for guidance only and as such must be considered incorrect. Potential buyers are advised to recheck measurements before committing to any expense. 4. We have not tested any apparatus, equipment, fixtures or services and it is in the buyers interest to check the working condition of any appliances. 5. Where an EPC, or a Home Report (Scotland only) is held for this property, it is available for inspection at the branch by appointment. If you require a printed version of a Home Report, you will need to pay a reasonable production charge reflecting printing and other costs. 6. We are not able to offer an opinion either written or verbal on the content of these reports and this must be obtained from your legal representative. 7. Whilst we take care in preparing these reports, a buyer should ensure that his/her legal representative confirms as soon as possible all matters relating to title including the extent and boundaries of the property and other important matters before exchange of contracts.

Manners & Harrison is a trading name of Sequence (UK) Limited which is registered in England and Wales under company number 4268443, Registered Office is Cumbria House, 16-20 Hockliffe Street, Leighton Buzzard, Bedfordshire, LU7 1GN. VAT Registration Number is 500 2481 05.

  
manners & harrison



**01429 261351**



[Hartlepool@mannersandharrison.co.uk](mailto:Hartlepool@mannersandharrison.co.uk)



Shrewsbury House 129 York Road,  
HARTLEPOOL, Durham, TS26 9DW



**[mannersandharrison.co.uk](http://mannersandharrison.co.uk)**