



**Teesbrooke Avenue, HARTLEPOOL TS25 5JF**

**welcome to**

## **Teesbrooke Avenue, HARTLEPOOL**

A superb 3 bedroomed, extended, semi detached house situated on this popular residential development.

### **Entrance Hallway**

Accessed via composite door, understairs storage cupboard, staircase to first floor, radiator.

### **Front Reception**

14' 8" into bay x 13' 5" ( 4.47m into bay x 4.09m )  
UPVC box bay window to front, attractive solid wood fireplace with marble effect surround and hearth with living flame gas fire, coved cornicing, radiator.

### **Open Living Dining Kitchen**

All open plan.

Living area 12ft 2in by 11ft 2 in maximum - a stunning fireplace with inset gas fire, coved cornicing, radiator, arch to:-

Dining area 20ft 1in by 8ft 6in - continuation of kitchen wall and base units, vertical radiator, French doors and patio doors overlooking rear garden.

Kitchen Area 8ft 3in by 7ft 7in - fitted with wall and base units with butcher block style working surfaces and complementing splashback, inset sink/drainage unit with chrome mixer tap, recess for cooker with brushed stainless steel splashback and extractor hood over.

### **First Floor Landing**

UPVC double glazed window to side, cupboard, loft void access.

### **Bedroom 1**

11' 1" x 9' 2" excluding door recess & alcove ( 3.38m x 2.79m excluding door recess & alcove )  
UPVC double glazed window to front, built in mirror fronted sliding wardrobes, radiator.

### **Bedroom 2**

12' 6" x 9' 5" excluding wardrobes ( 3.81m x 2.87m excluding wardrobes )  
UPVC double glazed window to rear, built in wardrobes, radiator.

### **Bedroom 3**

8' 1" x 9' 5" including overstairs bulk head ( 2.46m x 2.87m including overstairs bulk head )  
UPVC double glazed window to front, radiator.

### **Bathroom**

UPVC double glazed window to rear, panelled bath with chrome mixer tap and spray attachment, pedestal wash hand basin, radiator.

### **Separate W C**

UPVC double glazed opaque window to side, low level low flush WC.

### **Externally**

#### **Front**

Block paved, driveway offering off street parking, leading to:-

#### **Garage**

Up and over door, plumbing, power and lighting.

#### **Rear Garden**

Enclosed, south facing, surrounded with mature trees and shrubbery with patio area, greenhouse.







***view this property online*** [mannersandharrison.co.uk/Property/HAR118216](http://mannersandharrison.co.uk/Property/HAR118216)



welcome to

## Teesbrooke Avenue, HARTLEPOOL

- GARAGE
- SOUTH FACING REAR GARDEN
- EXTENDED
- POPULAR AREA
- DRIVEWAY

Tenure: Freehold EPC Rating: D

**£175,000**



**Ground Floor**

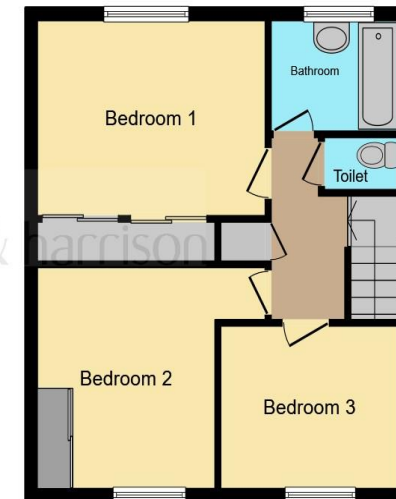

**First Floor**

This floor plan is for illustrative purposes only. It is not drawn to scale. Any measurements, floor areas (including any total floor area), openings and orientation are approximate. No details are guaranteed, they cannot be relied upon for any purpose and they do not form part of any agreement. No liability is taken for any error, omission or misstatement. A party must rely upon its own inspection(s). Powered by [www.focalagent.com](http://www.focalagent.com)

**view this property online** [mannersandharrison.co.uk/Property/HAR118216](http://mannersandharrison.co.uk/Property/HAR118216)



Property Ref:  
HAR118216 - 0005

1. MONEY LAUNDERING REGULATIONS Intending purchasers will be asked to produce identification documentation at a later stage and we would ask for your co-operation in order that there is no delay in agreeing the sale. 2. These particulars do not constitute part or all of an offer or contract. 3. The measurements indicated are supplied for guidance only and as such must be considered incorrect. Potential buyers are advised to recheck measurements before committing to any expense. 4. We have not tested any apparatus, equipment, fixtures or services and it is in the buyers interest to check the working condition of any appliances. 5. Where an EPC, or a Home Report (Scotland only) is held for this property, it is available for inspection at the branch by appointment. If you require a printed version of a Home Report, you will need to pay a reasonable production charge reflecting printing and other costs. 6. We are not able to offer an opinion either written or verbal on the content of these reports and this must be obtained from your legal representative. 7. Whilst we take care in preparing these reports, a buyer should ensure that his/her legal representative confirms as soon as possible all matters relating to title including the extent and boundaries of the property and other important matters before exchange of contracts.

Manners & Harrison is a trading name of Sequence (UK) Limited which is registered in England and Wales under company number 4268443, Registered Office is Cumbria House, 16-20 Hockliffe Street, Leighton Buzzard, Bedfordshire, LU7 1GN. VAT Registration Number is 500 2481 05.

manners & harrison



**01429 261351**



[Hartlepool@mannersandharrison.co.uk](mailto:Hartlepool@mannersandharrison.co.uk)



Shrewsbury House 129 York Road,  
HARTLEPOOL, Durham, TS26 9DW



[mannersandharrison.co.uk](http://mannersandharrison.co.uk)