



Pannell Place, Hartlepool TS27 3QD

welcome to

Pannell Place, Hartlepool

A beautiful, 3 bedroomed, end of terraced house in the Clavering Estate. This home benefits from gardens to front, side and rear with a driveway for off street parking.

Lounge

14' 6" including staircase x 15' 9" (4.42m including staircase x 4.80m)

Open plan, box bay window to front, coved cornicing, door to front, radiator, understairs storage, storage cupboard.

Kitchen

14' 6" x 8' 2" (4.42m x 2.49m)

Newly fitted wall and base grey high gloss units with complimenting working surfaces and co-ordinating splashback tiles, stainless steel sink drainer with mixer tap, combination boiler, built in oven with hob and hood, understairs storage, 2 x windows to rear, door to rear.

First Floor Landing

Loft with ladders, mostly boarded.

Bedroom 1

8' 3" x 13' 10" (2.51m x 4.22m)

Window to front, coved cornicing, radiator.

Bedroom 2

8' 3" x 10' 1" (2.51m x 3.07m)

Window to rear, radiator, coved corning.

Bedroom 3

9' 11" x 5' 10" (3.02m x 1.78m)

Window to front, overstairs storage cupboard, radiator.

Bathroom

"P" shaped bath with mixer tap and shower attached, pedestal wash hand basin with mixer tap, dual flush WC, mosaic effect tiled walls, window to rear, radiator.

Externally

Gardens

Lawn to 3 sides, offering ample scope for extension if required (subject to obtaining usual planning permission), enclosed with patio in front of house, 2 x driveways (one in front of garage).

Garage

In a separate block (third one in).





view this property online mannersandharrison.co.uk/Property/HAR117846



welcome to

Pannell Place, Hartlepool

- GARDEN TO 3 SIDES
- DRIVEWAY
- SEPARATE GARAGE
- 3 GOOD SIZED BEDROOMS
- NO ONWARD CHAIN

Tenure: Freehold EPC Rating: B

£130,000

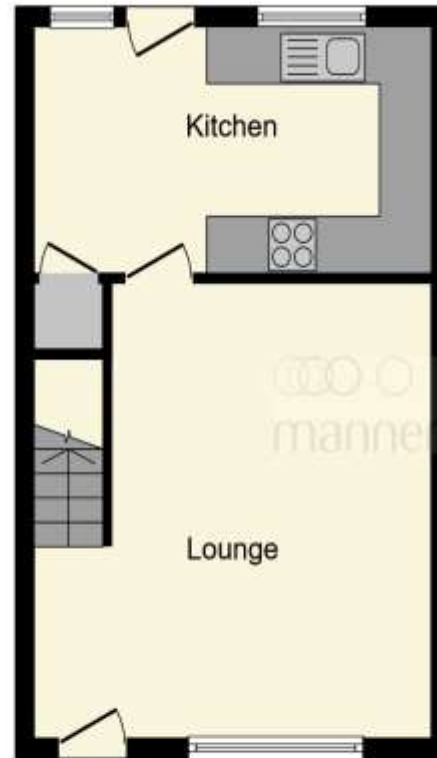

Ground Floor

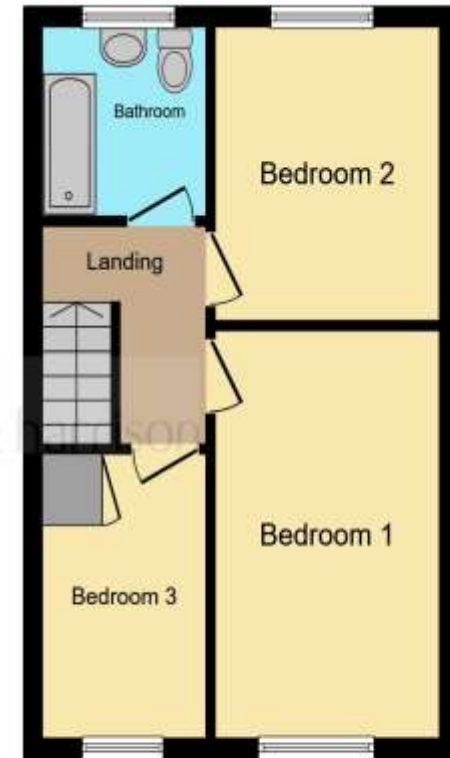

First Floor

This floorplan is for illustrative purposes only. It is not drawn to scale. Any measurements, floor areas (including any total floor area), openings and orientation are approximate. No details are guaranteed, they should not be relied upon for any purpose and do not form any part of any agreement. No liability is taken for any error, omission or misstatement. A party must rely on its own inspection(s). Plan produced for Manners & Harrison. Powered by www.focalagent.com

view this property online mannersandharrison.co.uk/Property/HAR117846



Property Ref:
HAR117846 - 0003

1. MONEY LAUNDERING REGULATIONS Intending purchasers will be asked to produce identification documentation at a later stage and we would ask for your co-operation in order that there is no delay in agreeing the sale. 2. These particulars do not constitute part or all of an offer or contract. 3. The measurements indicated are supplied for guidance only and as such must be considered incorrect. Potential buyers are advised to recheck measurements before committing to any expense. 4. We have not tested any apparatus, equipment, fixtures or services and it is in the buyers interest to check the working condition of any appliances. 5. Where an EPC, or a Home Report (Scotland only) is held for this property, it is available for inspection at the branch by appointment. If you require a printed version of a Home Report, you will need to pay a reasonable production charge reflecting printing and other costs. 6. We are not able to offer an opinion either written or verbal on the content of these reports and this must be obtained from your legal representative. 7. Whilst we take care in preparing these reports, a buyer should ensure that his/her legal representative confirms as soon as possible all matters relating to title including the extent and boundaries of the property and other important matters before exchange of contracts.

Manners & Harrison is a trading name of Sequence (UK) Limited which is registered in England and Wales under company number 4268443, Registered Office is Cumbria House, 16-20 Hockliffe Street, Leighton Buzzard, Bedfordshire, LU7 1GN. VAT Registration Number is 500 2481 05.

manners & harrison



01429 261351



Hartlepool@mannersandharrison.co.uk



Shrewsbury House 129 York Road,
HARTLEPOOL, Durham, TS26 9DW



mannersandharrison.co.uk