



**Gowy Court, Ellesmere Port CH66 1RG**

**welcome to**

**Gowy Court, Ellesmere Port**

A stunning two bedroom first floor apartment with a modern contemporary feel and spacious accommodation. The living room and primary bedroom both boast enviable views across Rivacre Valley and make for an apartment that benefits from a convenient central location yet with a sense of space around.



# Floor Plan

Approx. 65.0 sq. metres (699.2 sq. feet)

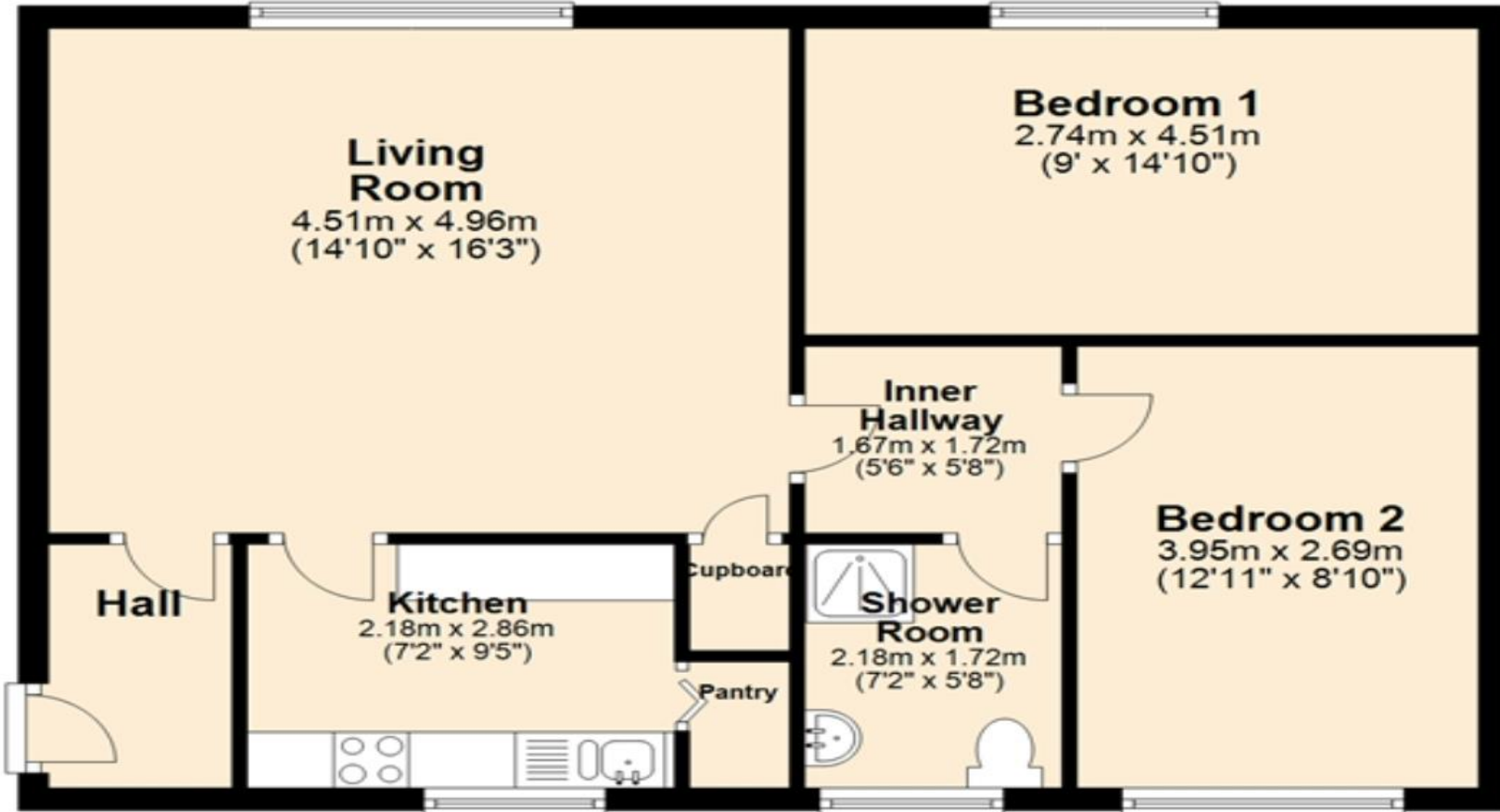

Total area: approx. 65.0 sq. metres (699.2 sq. feet)

## Living Room

14' 10" x 16' 3" ( 4.52m x 4.95m )

## Kitchen

7' 2" x 9' 5" ( 2.18m x 2.87m )

## Bedroom One

9' x 14' 10" ( 2.74m x 4.52m )

## Bedroom Two

12' 11" x 8' 10" ( 3.94m x 2.69m )

## Shower Room

welcome to

## Gowy Court, Ellesmere Port

- Council Tax Band A
- First Floor Apartment
- Two Bedrooms
- Spacious Living Area
- Aspect Over Rivacre Valley

Tenure: Leasehold EPC Rating: C

This is a Leasehold property with details as follows; Term of Lease 125 years from 10 Aug 1987. Should you require further information please contact the branch. Please Note additional fees could be incurred for items such as Leasehold packs.

# £120,000



Please note the marker reflects the postcode not the actual property

**view this property online** [jonesandchapman.co.uk/Property/LSU107946](https://www.jonesandchapman.co.uk/Property/LSU107946)



Property Ref:  
LSU107946 - 0006

1. MONEY LAUNDERING REGULATIONS Intending purchasers will be asked to produce identification documentation at a later stage and we would ask for your co-operation in order that there is no delay in agreeing the sale. 2. These particulars do not constitute part or all of an offer or contract. 3. The measurements indicated are supplied for guidance only and as such must be considered incorrect. Potential buyers are advised to recheck measurements before committing to any expense. 4. We have not tested any apparatus, equipment, fixtures or services and it is in the buyers interest to check the working condition of any appliances. 5. Where an EPC, or a Home Report (Scotland only) is held for this property, it is available for inspection at the branch by appointment. If you require a printed version of a Home Report, you will need to pay a reasonable production charge reflecting printing and other costs. 6. We are not able to offer an opinion either written or verbal on the content of these reports and this must be obtained from your legal representative. 7. Whilst we take care in preparing these reports, a buyer should ensure that his/her legal representative confirms as soon as possible all matters relating to title including the extent and boundaries of the property and other important matters before exchange of contracts.

  
jones & chapman



**0151 339 4878**



[LittleSutton@jonesandchapman.co.uk](mailto:LittleSutton@jonesandchapman.co.uk)



349 Chester Road, Little Sutton, LITTLE SUTTON, Cheshire, CH66 3RG



[jonesandchapman.co.uk](https://www.jonesandchapman.co.uk)