



**Norman Close, Great Sutton Ellesmere Port CH66 2YE**

**welcome to**

**Norman Close, Great Sutton Ellesmere Port**

\*\*\*NO ONWARD CHAIN\*\*\* Well-presented and maintained bungalow situated within a cul-de-sac in the Great Sutton area. Benefiting from a conservatory and detached garage. Viewing is advised to fully appreciate all this property has to offer.



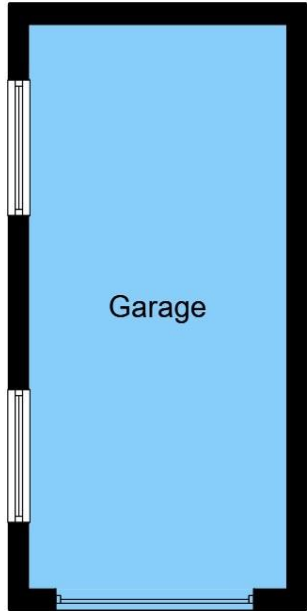

**Garage**

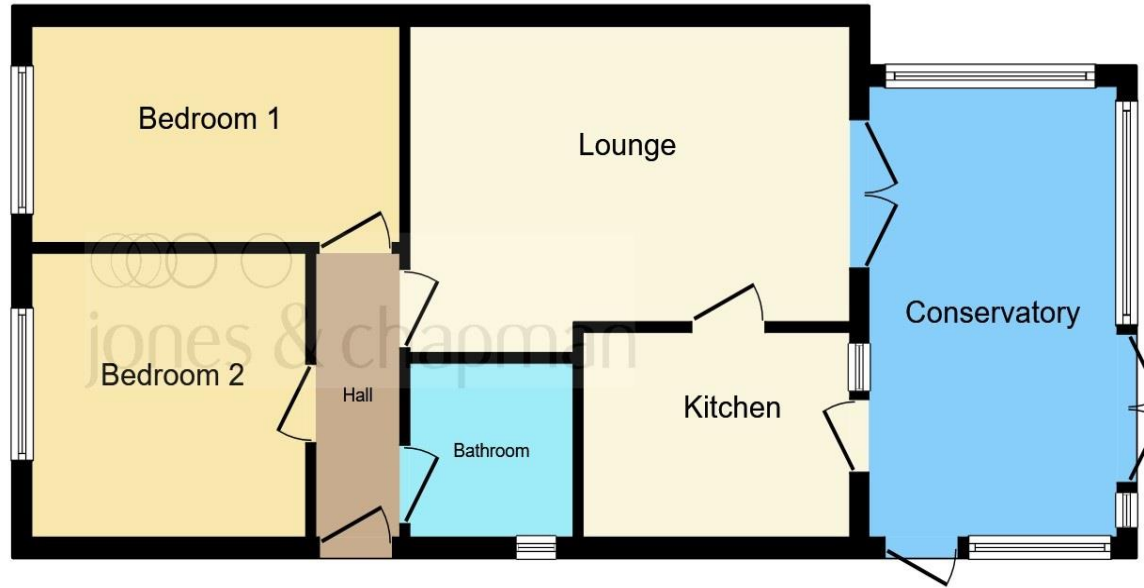

**Floor Plan**

**Entrance Hall**

**Lounge**

15' 10" x 14' 4" ( 4.83m x 4.37m )

**Kitchen**

9' 9" x 7' 1" ( 2.97m x 2.16m )

**Conservatory**

15' x 8' 8" ( 4.57m x 2.64m )

**Bedroom One**

10' 4" x 10' 1" max ( 3.15m x 3.07m max )

**Bedroom Two**

13' 6" x 7' 2" ( 4.11m x 2.18m )

**Bathroom**

**Front Garden**

**Rear Garden**

This floorplan is for illustrative purposes only and is not drawn to scale. Measurements, floor-areas, openings and orientations are approximate. They should not be relied upon for any purpose and do not form any part of an agreement. No liability is taken for any error or mis-statement. All parties must rely on their own inspections.

welcome to

## Norman Close, Great Sutton Ellesmere Port

- Council Tax Band C
- Two Bedroom Semi Detached Bungalow
- Cul-De-Sac Location
- Spacious Lounge
- Conservatory

Tenure: Freehold EPC Rating: C

**£250,000**



Please note the marker reflects the postcode not the actual property

**view this property online** [jonesandchapman.co.uk/Property/LSU107918](https://www.jonesandchapman.co.uk/Property/LSU107918)



Property Ref:  
LSU107918 - 0004

1. MONEY LAUNDERING REGULATIONS Intending purchasers will be asked to produce identification documentation at a later stage and we would ask for your co-operation in order that there is no delay in agreeing the sale. 2. These particulars do not constitute part or all of an offer or contract. 3. The measurements indicated are supplied for guidance only and as such must be considered incorrect. Potential buyers are advised to recheck measurements before committing to any expense. 4. We have not tested any apparatus, equipment, fixtures or services and it is in the buyers interest to check the working condition of any appliances. 5. Where an EPC, or a Home Report (Scotland only) is held for this property, it is available for inspection at the branch by appointment. If you require a printed version of a Home Report, you will need to pay a reasonable production charge reflecting printing and other costs. 6. We are not able to offer an opinion either written or verbal on the content of these reports and this must be obtained from your legal representative. 7. Whilst we take care in preparing these reports, a buyer should ensure that his/her legal representative confirms as soon as possible all matters relating to title including the extent and boundaries of the property and other important matters before exchange of contracts.

 jones & chapman



**0151 339 4878**



[LittleSutton@jonesandchapman.co.uk](mailto:LittleSutton@jonesandchapman.co.uk)



349 Chester Road, Little Sutton, LITTLE SUTTON, Cheshire, CH66 3RG



[jonesandchapman.co.uk](https://www.jonesandchapman.co.uk)