



Kentmere Drive, Pensby Wirral CH61 5XN

welcome to

Kentmere Drive, Pensby Wirral

Jones and Chapman are proud to present this fantastic two-bedroom semi-detached home, just a short walk from many local amenities and excellent transport links into Heswall and Liverpool.





Ground Floor

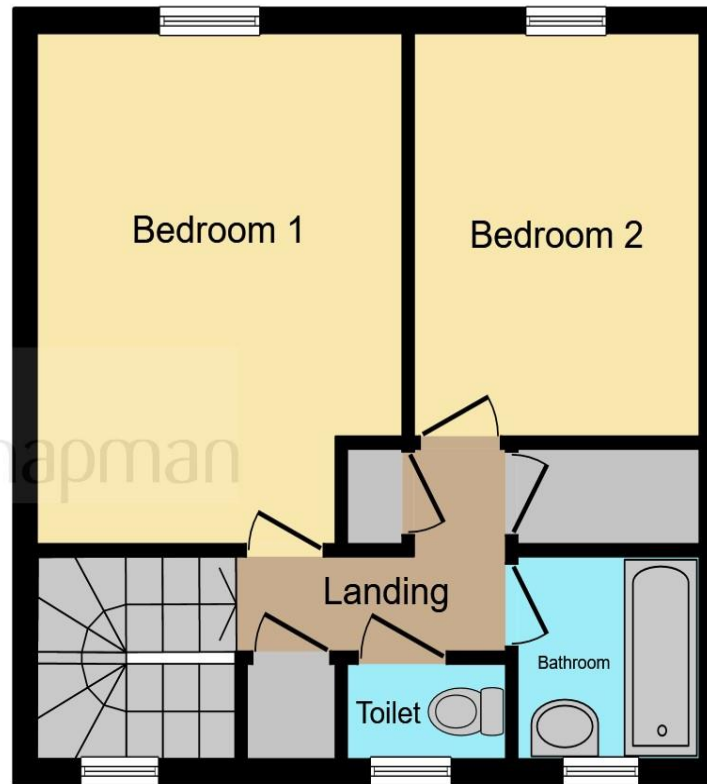

First Floor

Hall

Downstairs W.C.

Living Room

12' 6" x 10' 8" (3.81m x 3.25m)

Dining Room

8' 8" x 8' 5" (2.64m x 2.57m)

Kitchen

10' 4" x 8' 5" (3.15m x 2.57m)

Bedroom One

15' x 10' 8" (4.57m x 3.25m)

Bedroom Two

12' 4" x 8' 5" (3.76m x 2.57m)

Bathroom

5' 9" x 5' 2" (1.75m x 1.57m)

Separate W.C.

2' 6" x 4' 6" (0.76m x 1.37m)

Landing

Externally

This floor plan is for illustrative purposes only. It is not drawn to scale. Any measurements, floor areas (including any total floor area), openings and orientation are approximate. No details are guaranteed, they cannot be relied upon for any purpose and they do not form part of any agreement. No liability is taken for any error, omission or misstatement. A party must rely upon its own inspection(s). Powered by www.focalagent.com

welcome to

Kentmere Drive, Pensby Wirral

- Semi detached home
- Two double bedrooms
- Located in the popular residential area of Pensby
- Close to many local amenities
- Potential to extend into the loft - subject to planning

Tenure: Freehold EPC Rating: D

offers in the region of

£190,000



Please note the marker reflects the postcode not the actual property

view this property online jonesandchapman.co.uk/Property/GRE105485



Property Ref:
GRE105485 - 0009

1. MONEY LAUNDERING REGULATIONS Intending purchasers will be asked to produce identification documentation at a later stage and we would ask for your co-operation in order that there is no delay in agreeing the sale. 2. These particulars do not constitute part or all of an offer or contract. 3. The measurements indicated are supplied for guidance only and as such must be considered incorrect. Potential buyers are advised to recheck measurements before committing to any expense. 4. We have not tested any apparatus, equipment, fixtures or services and it is in the buyers interest to check the working condition of any appliances. 5. Where an EPC, or a Home Report (Scotland only) is held for this property, it is available for inspection at the branch by appointment. If you require a printed version of a Home Report, you will need to pay a reasonable production charge reflecting printing and other costs. 6. We are not able to offer an opinion either written or verbal on the content of these reports and this must be obtained from your legal representative. 7. Whilst we take care in preparing these reports, a buyer should ensure that his/her legal representative confirms as soon as possible all matters relating to title including the extent and boundaries of the property and other important matters before exchange of contracts.

Jones & Chapman is a trading name of Sequence (UK) Limited which is registered in England and Wales under company number 4268443, Registered Office is Cumbria House, 16-20 Hockliffe Street, Leighton Buzzard, Bedfordshire, LU7 1GN. VAT Registration Number is 500 2481 05.

jones & chapman



0151 677 9473



Greasby@jonesandchapman.co.uk



142 Greasby Road, Greasby, Merseyside, CH49 3NQ



jonesandchapman.co.uk