



Bailbrook Lane, Bath, BA1 7AL

welcome to

Bailbrook Lane, Bath

An exceptional grade II listed two bedroom period home situated within the semi-rural hamlet of Bailbrook on the edge of Bath, nestling into the side of Solsbury Hill.



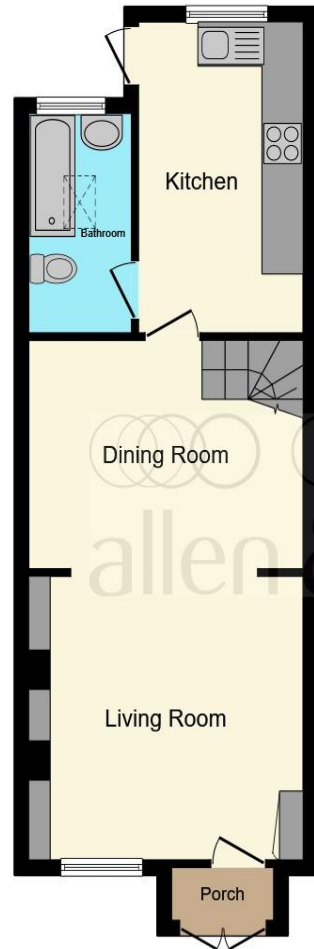

Ground Floor



First Floor

Living Room

23' 1" Max x 13' 2" Max (7.04m Max x 4.01m Max)

Kitchen

13' 8" x 7' 9" (4.17m x 2.36m)

Bedroom One

12' 5" x 13' 2" Max (3.78m x 4.01m Max)

Bedroom Two

13' 1" x 13' 4" Max (3.99m x 4.06m Max)

Bathroom

9' 8" x 4' 9" (2.95m x 1.45m)

This floor plan is for illustrative purposes only. It is not drawn to scale. Any measurements, floor areas (including any total floor area), openings and orientation are approximate. No details are guaranteed, they cannot be relied upon for any purpose and they do not form part of any agreement. No liability is taken for any error, omission or misstatement. A party must rely upon its own inspection(s). Powered by www.focalagent.com

welcome to

Bailbrook Lane, Bath

- Grade II listed
- Period features throughout
- Spectacular views from its elevated positioning
- Two double bedrooms
- Front and rear gardens, as well as an extra section of land to the rear.

Tenure: Freehold EPC Rating: Awaited

offers in excess of

£450,000



Please note the marker reflects the postcode not the actual property

view this property online allenandharris.co.uk/Property/LAR105263



Property Ref:
LAR105263 - 0003

1. MONEY LAUNDERING REGULATIONS Intending purchasers will be asked to produce identification documentation at a later stage and we would ask for your co-operation in order that there is no delay in agreeing the sale. 2. These particulars do not constitute part or all of an offer or contract. 3. The measurements indicated are supplied for guidance only and as such must be considered incorrect. Potential buyers are advised to recheck measurements before committing to any expense. 4. We have not tested any apparatus, equipment, fixtures or services and it is in the buyers interest to check the working condition of any appliances. 5. Where an EPC, or a Home Report (Scotland only) is held for this property, it is available for inspection at the branch by appointment. If you require a printed version of a Home Report, you will need to pay a reasonable production charge reflecting printing and other costs. 6. We are not able to offer an opinion either written or verbal on the content of these reports and this must be obtained from your legal representative. 7. Whilst we take care in preparing these reports, a buyer should ensure that his/her legal representative confirms as soon as possible all matters relating to title including the extent and boundaries of the property and other important matters before exchange of contracts.

allen & harris



01225 482244



BathLarkhall@allenandharris.co.uk



1 Balustrade, Larkhall, Bath, Somerset, BA1 6QA



allenandharris.co.uk