



Connells

Alma Street
AYLESBURY

Alma Street AYLESBURY HP18 0FU

for sale offers over
£280,000



Property Description

Ideal First-Time Buyer Home in Berryfields – Mid-Terraced Convenience.

Located in the popular Berryfields area, this mid-terraced home presents a fantastic opportunity for first-time buyers looking for a modern and well-equipped property.

Upon entering, the welcoming hallway leads to a downstairs WC for added convenience. The spacious lounge/dining area benefits from an understairs storage cupboard and French doors that open up to the rear garden, creating a bright and airy living space.

The fully integrated kitchen is designed for ease, featuring a gas hob, electric oven, integrated dishwasher, washing machine, and fridge/freezer—providing everything needed for a streamlined culinary experience.

Upstairs, the property boasts two generous double bedrooms, both finished with comfortable carpet underfoot. They share access to the modern family bathroom, complete with a bath/mixer, overhead shower, and towel radiator.

Externally, the large rear garden offers a peaceful retreat, featuring laid lawn, patio slabs, and enclosed fencing for privacy. Additionally, a private driveway ensures convenient parking.

Berryfields is a modern development situated on the northern outskirts of Aylesbury surrounded by open countryside. The development is home to a train station and shops on the development including a Sainsbury local, coffee shop, fish and chip shop and more, as well as three schools within catchment area.

Entrance Hall

Door to front, laminate flooring underfoot, radiator

Cloakroom

WC, WHB, radiator, vinyl underfoot

Lounge/Diner

14' 5" x 12' 9" (4.39m x 3.89m)

French doors to rear, carpet underfoot, radiator, understairs cupboard

Kitchen

9' 9" x 6' 2" (2.97m x 1.88m)

Window to front, wall and base units, gas hob and electric oven, sink/drainage, boiler, integrated dishwasher, washing machine and fridge/freezer

Bedroom One

12' 9" x 8' 11" (3.89m x 2.72m)

Window to rear, carpet underfoot, radiator

Bedroom Two

12' 9" x 7' 6" (3.89m x 2.29m)

Window to front, carpet underfoot, radiator

Bathroom

WC, WHB, Bath/mixer with shower, towel radiator, vinyl underfoot







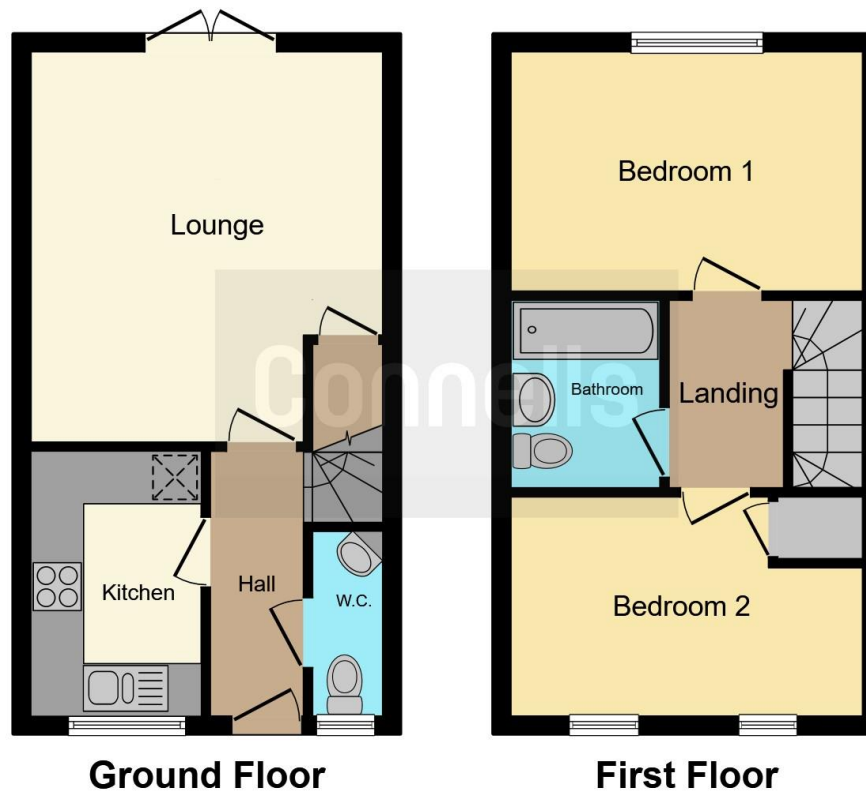

This floor plan is for illustrative purposes only. It is not drawn to scale. Any measurements, floor areas (including any total floor area), openings and orientation are approximate. No details are guaranteed, they cannot be relied upon for any purpose and they do not form part of any agreement. No liability is taken for any error, omission or misstatement. A party must rely upon its own inspection(s). Powered by www.focalagent.com

To view this property please contact Connells on

T 01296 395 111
E aylesbury@connells.co.uk

2 Temple Street
 AYLESBURY HP20 2RH

EPC Rating: C Council Tax
 Band: C

Tenure: Freehold

view this property online connells.co.uk/Property/ALS312334



1. MONEY LAUNDERING REGULATIONS Intending purchasers will be asked to produce identification documentation at a later stage and we would ask for your co-operation in order that there will be no delay in agreeing the sale. 2. These particulars do not constitute part or all of an offer or contract. 3. The measurements indicated are supplied for guidance only and as such must be considered incorrect. Potential buyers are advised to recheck measurements before committing to any expense. 4. We have not tested any apparatus, equipment, fixtures, fittings or services and it is in the buyers interest to check the working condition of any appliances.

Connells Residential is registered in England and Wales under company number 1489613, Registered Office is Cumbria House, 16-20 Hockliffe Street, Leighton Buzzard, Bedfordshire, LU7 1GN. VAT Registration Number is 500 2481 05.

See all our properties at www.connells.co.uk | www.rightmove.co.uk | www.zoopla.co.uk

Property Ref: ALS312334 - 0006