



**Connells**

Argyle Avenue  
Aylesbury





## Property Description

CONNELLS are happy to bring to the market this THREE bedroom terraced house, located on the north side of Aylesbury town centre just off the A41 and close to the new Aylesbury Parkway railway station linking with London Marylebone. The area has a wealth of facilities locally including a Tesco Express, Doctors surgery and a large sports ground and community centre. Primary – Thomas Hickman & Secondary – Aylesbury Vale Academy Aylesbury Grammar Schools.

The property comprises of a spacious entrance hall with carpet underfoot and stairs leading to the first floor, with a storage cupboard underneath. The lounge/dining room provides ample space for a family size dining table aswell as sofas/living room furniture, with patio doors leading to the rear garden.

The bright kitchen fitted with a gas hob and electric oven, and offers space for fridge/freezer, dishwasher and washing machine. On the first floor there are three good size bedrooms, the master with additional storage cupboards, all rooms have access to the family bathroom which comes with a bath/mixer and has a separate shower cubicle.

The rear garden has laid lawn and patio and is enclosed by fencing. Property also comes with driveway parking.

Calls CONNELLS to arrange a viewing!

## Lounge

10' x 19' 8" ( 3.05m x 5.99m )

Window to rear

French doors to rear

Carpet underfoot

Radiator

## Entrance Hall

Door to Front

Carpet underfoot

## Kitchen

10' 9" x 9' 8" ( 3.28m x 2.95m )

Window to rear

Wall & base units

gas hob & electric oven

Part tiling

Sink/drain

Space for FF,WM & DW

## Utility Room

9' 9" x 6' 4" ( 2.97m x 1.93m )

Window to rear

Carpet underfoot

Understairs cupboard

radiator

## Landing

Airing cupboard

Loft access

Carpet underfoot

Enclosed fencing

## Bedroom One

11' 9" max x 10' 7" max ( 3.58m max x 3.23m max )

Window to rear

Carpet underfoot

Radiator

Storage cupboard

## Bedroom Two

12' 7" max x 8' 9" max ( 3.84m max x 2.67m max )

Window to rear

Radiator

Carpet underfoot

## Bedroom Three

10' 7" x 6' 4" ( 3.23m x 1.93m )

Window to front

radiator

carpet underfoot

## Bathroom

Window to rear

Vinyl floor

WC, WHB

Separate shower cubicle

Bath/mixer

Part tiling

radiator

ex fan

## Rear Garden

Patio

Laid lawn













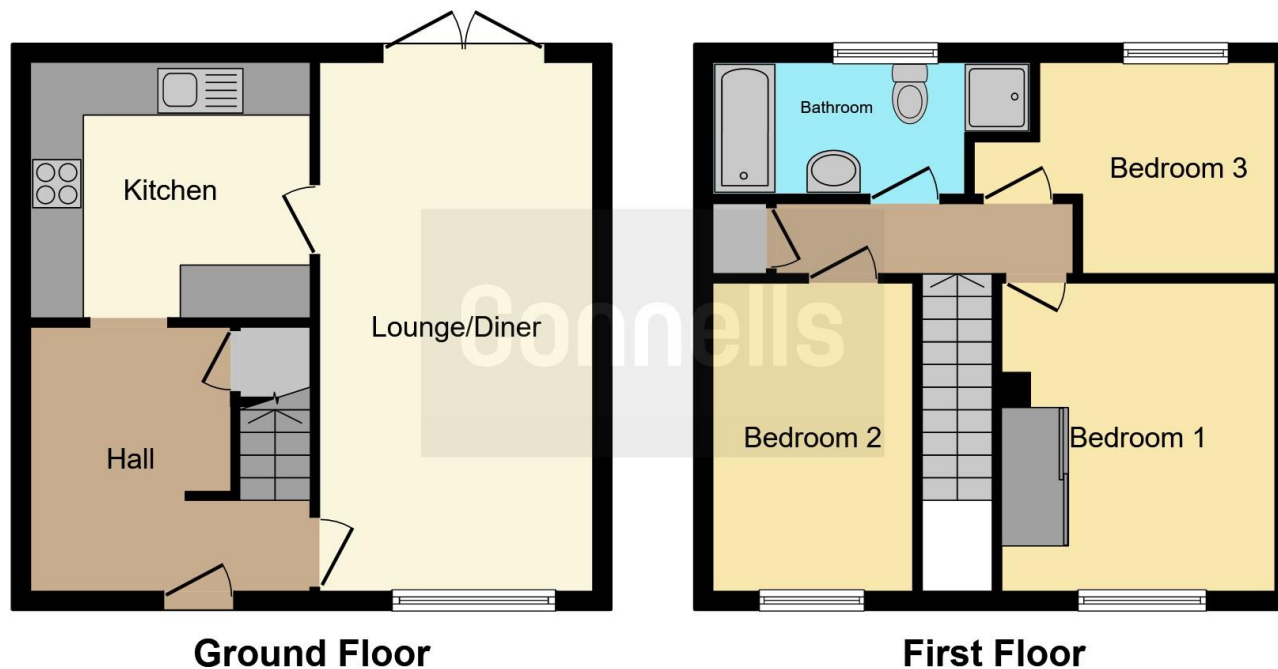

This floor plan is for illustrative purposes only. It is not drawn to scale. Any measurements, floor areas (including any total floor area), openings and orientation are approximate. No details are guaranteed, they cannot be relied upon for any purpose and they do not form part of any agreement. No liability is taken for any error, omission or misstatement. A party must rely upon its own inspection(s). Powered by [www.focalagent.com](http://www.focalagent.com)

To view this property please contact Connells on

**T 01296 395 111**  
**E [aylesbury@connells.co.uk](mailto:aylesbury@connells.co.uk)**

2 Temple Street  
 AYLESBURY HP20 2RH

**EPC Rating: C**

Tenure: Freehold

**check out more properties at [connells.co.uk](http://connells.co.uk)**



1. MONEY LAUNDERING REGULATIONS Intending purchasers will be asked to produce identification documentation at a later stage and we would ask for your co-operation in order that there will be no delay in agreeing the sale. 2. These particulars do not constitute part or all of an offer or contract. 3. The measurements indicated are supplied for guidance only and as such must be considered incorrect. Potential buyers are advised to recheck measurements before committing to any expense. 4. We have not tested any apparatus, equipment, fixtures, fittings or services and it is in the buyers interest to check the working condition of any appliances.

Connells Residential is registered in England and Wales under company number 1489613, Registered Office is Cumbria House, 16-20 Hockliffe Street, Leighton Buzzard, Bedfordshire, LU7 1GN. VAT Registration Number is 500 2481 05.

**See all our properties at [www.connells.co.uk](http://www.connells.co.uk) | [www.rightmove.co.uk](http://www.rightmove.co.uk) | [www.zoopla.co.uk](http://www.zoopla.co.uk)**

Property Ref: ALS311963 - 0004