



Connells

Britannia House New Street
AYLESBURY

Britannia House New Street AYLESBURY HP20 2NY

for sale shared ownership
£62,500



Property Description

**** 25% SHARED OWNERSHIP ****
CONNELLS are delighted to bring to the market this UNIQUE opportunity of a STUNNING penthouse apartment situated in the HEART OF AYLESBURY TOWN CENTRE and within walking distance to Aylesbury Train Station.

This bright and airy property comprises of:

Entrance hall, open plan modern fitted kitchen/living/dining area, two double bedrooms with en-suite to master all with access to a modern family bathroom. To the front of the property is a stunning balcony overlooking Aylesbury town making this IDEAL for first time buyers!

Entrance Hall

Front door, storage cupboard.

Lounge / Kitchen

16' 2" x 20' 7" (4.93m x 6.27m)

Balcony to side aspect, window to rear aspect, television point, telephone point.

Fitted kitchen comprised of wall and base units with work surfaces and tiling to complement, window to side aspect, sink with drainer, electric oven and hob with extractor hood, integrated washing machine, dishwasher & fridge/freezer.

Bedroom One

12' 7" x 13' 3" (3.84m x 4.04m)

Window to side aspect, door to en-suite.

En-Suite

Window to rear aspect, shower cubicle, WC, wash hand basin.

Bedroom Two

9' 8" x 14' 6" (2.95m x 4.42m)

Window to rear and side aspect.

Bathroom

Bath with mixer taps, WC, wash hand basin.

Outside

Communal Garden

Gated entrance, courtyard area.







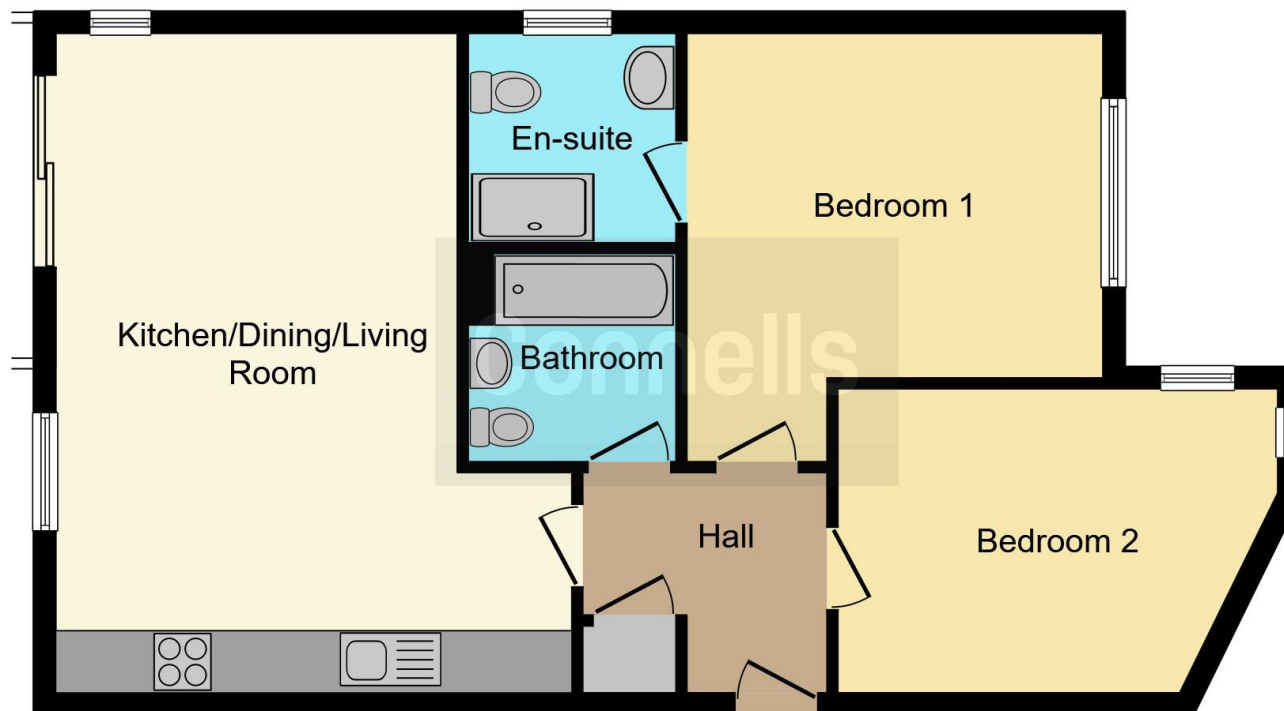

This floor plan is for illustrative purposes only. It is not drawn to scale. Any measurements, floor areas (including any total floor area), openings and orientation are approximate. No details are guaranteed, they cannot be relied upon for any purpose and they do not form part of any agreement. No liability is taken for any error, omission or misstatement. A party must rely upon its own inspection(s). Powered by www.focalagent.com

To view this property please contact Connells on

T 01296 395 111
E aylesbury@connells.co.uk

2 Temple Street
 AYLESBURY HP20 2RH

EPC Rating: B

Tenure: Leasehold

view this property online connells.co.uk/Property/ALS311549

This is a Leasehold property. We are awaiting further details about the Term of the lease. For further information please contact the branch. Please note additional fees could be incurred for items such as Leasehold packs.



1. MONEY LAUNDERING REGULATIONS Intending purchasers will be asked to produce identification documentation at a later stage and we would ask for your co-operation in order that there will be no delay in agreeing the sale. 2. These particulars do not constitute part or all of an offer or contract. 3. The measurements indicated are supplied for guidance only and as such must be considered incorrect. Potential buyers are advised to recheck measurements before committing to any expense. 4. We have not tested any apparatus, equipment, fixtures, fittings or services and it is in the buyers interest to check the working condition of any appliances.

Connells Residential is registered in England and Wales under company number 1489613, Registered Office is Cumbria House, 16-20 Hockliffe Street, Leighton Buzzard, Bedfordshire, LU7 1GN. VAT Registration Number is 500 2481 05.

See all our properties at www.connells.co.uk | www.rightmove.co.uk | www.zoopla.co.uk

Property Ref: ALS311549 - 0002