



**Connells**

Gatehouse Road  
Aylesbury





### Property Description

Located within walking distance to town centre. Investment opportunity with large spot. Large front and rear garden. Offering generous family room with patio doors to garden and size access via out house. Refitted kitchen with storage cupboards. Recently updated modern bathroom and two bedrooms to first floor.

### Entrance Hall

Door to front. Laminate flooring.

### Lounge

19' 4" max x 10' 2" max ( 5.89m max x 3.10m max )

Window to front and patio doors to rear. Radiator. Laminate flooring.

### Kitchen

10' 6" max x 8' 8" max ( 3.20m max x 2.64m max )

Window to rear. Space for white goods. Fully tiled. Tiled flooring. Wall and base units. Gas hob, electric oven.

### Utility Room

10' 5" max x 6' 5" max ( 3.17m max x 1.96m max )

Doors to front and rear. Window to rear. Tiling underfoot.

### Landing

Carpet, airing cupboard. Loft hatch.

### Bedroom One

16' 3" max x 8' 7" max ( 4.95m max x 2.62m max )

Window to front. Carpet. Radiator.

### Bedroom Two

10' 1" max x 10' 10" max ( 3.07m max x 3.30m max )

Window to rear. Radiator. Carpet.

### Bathroom

WC, wash hand basin. Shower cubicle. Fully tiled. Windows to side and rear.

### Front Garden

Laid to lawn with central footpath.

### Rear Garden

Fencing. Patio and lawn.





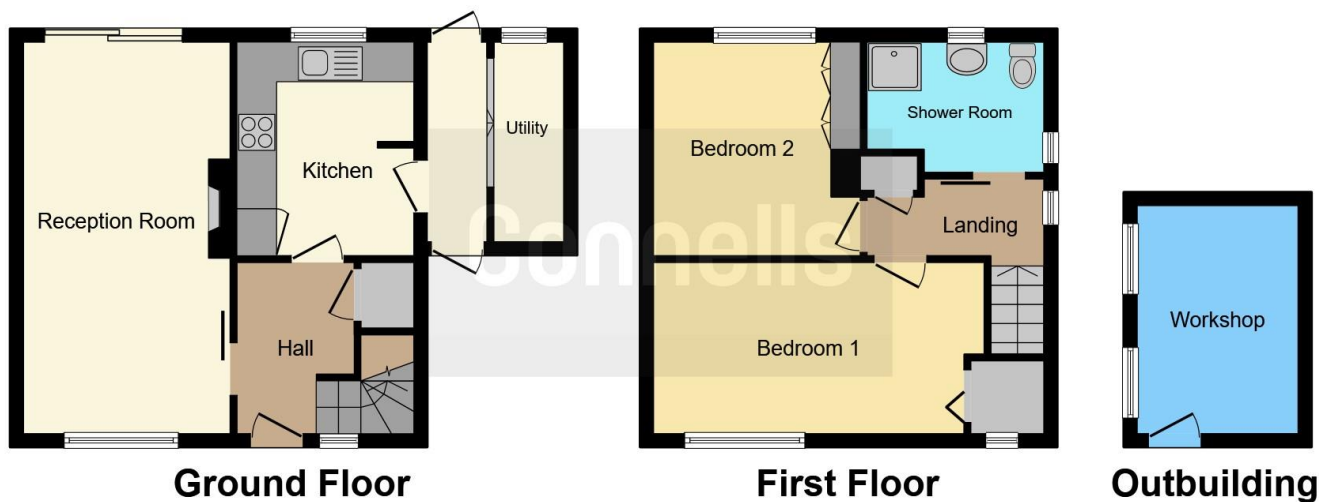

This floor plan is for illustrative purposes only. It is not drawn to scale. Any measurements, floor areas (including any total floor area), openings and orientation are approximate. No details are guaranteed, they cannot be relied upon for any purpose and they do not form part of any agreement. No liability is taken for any error, omission or misstatement. A party must rely upon its own inspection(s). Powered by [www.focalagent.com](http://www.focalagent.com)

To view this property please contact Connells on

**T 01296 395 111**  
**E [aylesbury@connells.co.uk](mailto:aylesbury@connells.co.uk)**

2 Temple Street  
 AYLESBURY HP20 2RH

**EPC Rating: D**

**view this property online [connells.co.uk/Property/ALS311964](http://connells.co.uk/Property/ALS311964)**



Tenure: Freehold



1. MONEY LAUNDERING REGULATIONS Intending purchasers will be asked to produce identification documentation at a later stage and we would ask for your co-operation in order that there will be no delay in agreeing the sale. 2. These particulars do not constitute part or all of an offer or contract. 3. The measurements indicated are supplied for guidance only and as such must be considered incorrect. Potential buyers are advised to recheck measurements before committing to any expense. 4. We have not tested any apparatus, equipment, fixtures, fittings or services and it is in the buyers interest to check the working condition of any appliances.

Connells Residential is registered in England and Wales under company number 1489613, Registered Office is Cumbria House, 16-20 Hockliffe Street, Leighton Buzzard, Bedfordshire, LU7 1GN. VAT Registration Number is 500 2481 05.

**See all our properties at [www.connells.co.uk](http://www.connells.co.uk) | [www.rightmove.co.uk](http://www.rightmove.co.uk) | [www.zoopla.co.uk](http://www.zoopla.co.uk)**

Property Ref: ALS311964 - 0006