



Connells

Newton Avenue
Aylesbury



Property Description

Connells are delighted to welcome to the market this detached two bedroom coach house. This beautiful property has a carport under the property a enclosed garden with a laid lawn and fencing. The property is located in the Berryfield area of Aylesbury town.

Entrance

Door to front, stairs to first floor, carpet, radiator

Lounge Area (open Plan)

11' 9" x 10' 7" (3.58m x 3.23m)

Window to front, radiator, carpet

Kitchen/Diner

16' 1" x 9' 9" (4.90m x 2.97m)

Skylight, window, wall and base units, sink/drainer, integrated gas/hob, electric oven, washing machine, dishwasher, fridge/freezer, radiator, laminated floor underneath

Bedroom 1

13' 7" max x 9' 2" max (4.14m max x 2.79m max)

Window to front, build in wardrobe, radiator, carpet

Bedroom 2

10' 3" max x 7' 11" max (3.12m max x 2.41m max)

Window to front, radiator, carpet

Bathroom

Skylight window, wc, wash hand basin, bath with shower, partial tiling, radiator

Side Garden

Side garden, laid lawn and enclosed fencing

Parking

Carport under property with additional storage







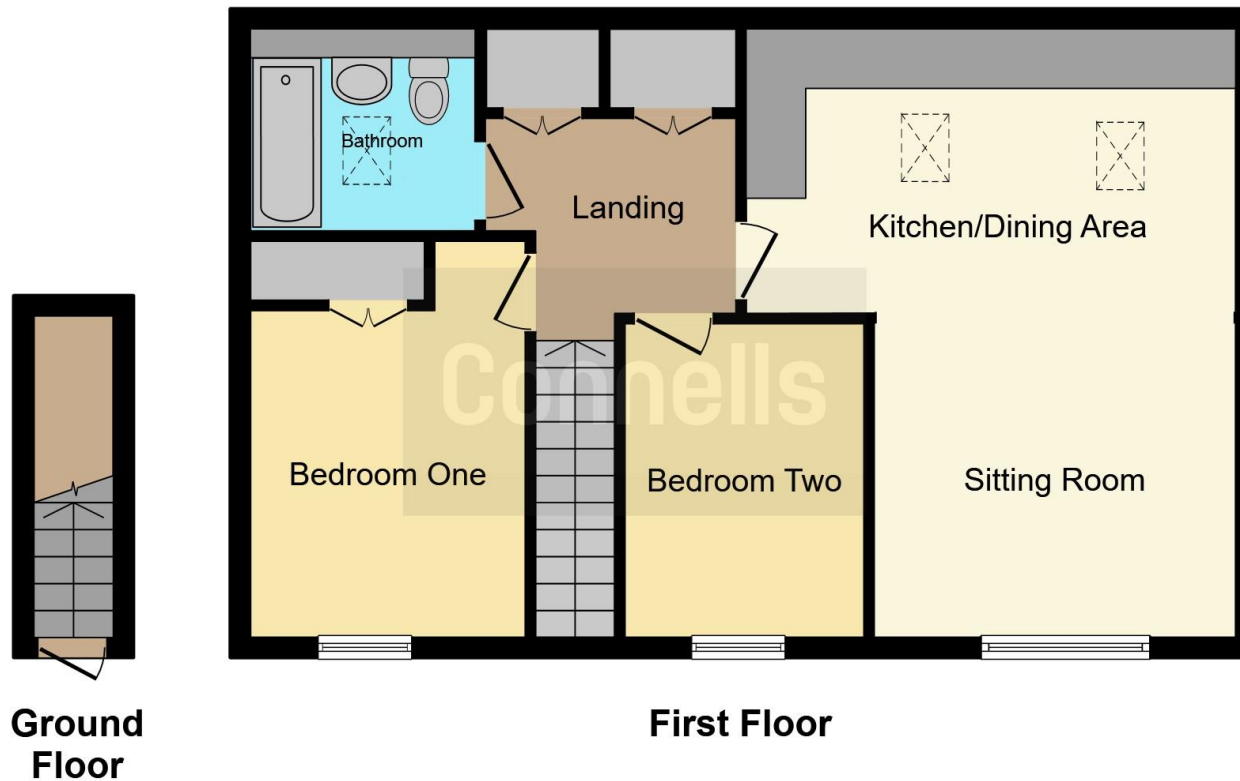

This floor plan is for illustrative purposes only. It is not drawn to scale. Any measurements, floor areas (including any total floor area), openings and orientation are approximate. No details are guaranteed, they cannot be relied upon for any purpose and they do not form part of any agreement. No liability is taken for any error, omission or misstatement. A party must rely upon its own inspection(s). Powered by www.focalagent.com

To view this property please contact Connells on

T 01296 395 111
E aylesbury@connells.co.uk

2 Temple Street
 AYLESBURY HP20 2RH

EPC Rating: D

Tenure: Freehold

view this property online connells.co.uk/Property/ALS311739



1. MONEY LAUNDERING REGULATIONS Intending purchasers will be asked to produce identification documentation at a later stage and we would ask for your co-operation in order that there will be no delay in agreeing the sale. 2. These particulars do not constitute part or all of an offer or contract. 3. The measurements indicated are supplied for guidance only and as such must be considered incorrect. Potential buyers are advised to recheck measurements before committing to any expense. 4. We have not tested any apparatus, equipment, fixtures, fittings or services and it is in the buyers interest to check the working condition of any appliances.

Connells Residential is registered in England and Wales under company number 1489613, Registered Office is Cumbria House, 16-20 Hockliffe Street, Leighton Buzzard, Bedfordshire, LU7 1GN. VAT Registration Number is 500 2481 05.

See all our properties at www.connells.co.uk | www.rightmove.co.uk | www.zoopla.co.uk

Property Ref: ALS311739 - 0006