



Connells

Shakespeare Orchard
Grendon Underwood Aylesbury

Shakespeare Orchard Grendon Underwood Aylesbury HP18 0SQ

for sale
£280,000



Property Description

NO CHAIN AVAILABLE* Connells are delighted to bring to the market this SPACIOUS two bedroom terraced property with converted loft space. Located in the quiet village of Grendon Underwood.

This property is BEAUTIFULLY PRESENTED and comprises of: Front RURAL GARDEN with pathway leading to entrance porch, MODERN fitted kitchen with INTEGRATED APPLIANCES, additional utility area & BREAKFAST BAR work top, separate dining area, SPACIOUS AND BRIGHT lounge with French doors to rear LANDSCAPED garden with access to rear.

Carpet underfoot staircase to first floor consisting of: Bedroom (one) with front facing double glazed windows and, family bathroom, Bedroom (two) with rear facing double glazed windows.

Staircase from bedroom one to loft converted room with built in storage with rear facing double glazed windows, & additional storage areas.

Allocated & Residential Off Street parking to the rear of the property.

Primary Schools can be found in the village & Secondary Schools include Waddesdon Secondary School and Grammar Schools in Aylesbury.

Entrance Hall

Door to front, laminate wood flooring underfoot

Kitchen

11' 8" max x 9' 9" max (3.56m max x 2.97m max)

Window to front, laminate wood flooring underfoot, wall and base units with integrated fridge/freezer, electric oven and hob. Freestanding washing machine and stainless steel sink/drainer. Breakfast bar area

Living Room

13' 7" max x 11' 9" max (4.14m max x 3.58m max)

French doors to rear with window paneling, carpet underfoot, radiator, TV and Tel point

Dinning Room

11' 9" max x 9' 11" max (3.58m max x 3.02m max)

Door to front, laminate flooring underfoot, radiator.

Landing

Carpet underfoot, loft latch, storage cupboard

Bedroom One

11' 8" max x 9' 11" max (3.56m max x 3.02m max)

Window to front, carpet underfoot, radiator, staircase to loft room

Bedroom Two

11' 9" max x 8' 9" max (3.58m max x 2.67m max)

Window to rear, carpet underfoot,radiator

Bathroom

Vinyl flooring underfoot, wc,whb, bath with shower head, towel radiator, part tiling to walls.

Converted Loft

20' 11" restircted head height x 11' 11" (6.38m restircted head height x 3.63m)

Skylight window to front,built in wardrobes,carpet underfoot, fitted cupboard

Garden

Block paved patio, astro turf lawn,rear access

Parking

Allocated parking to the rear







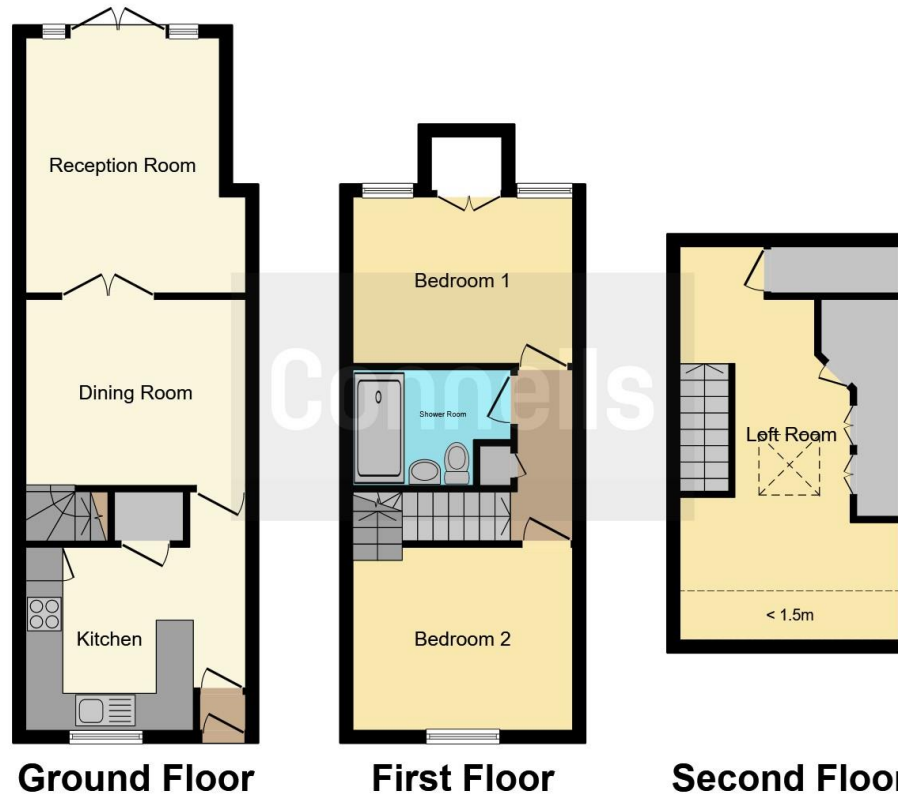

This floor plan is for illustrative purposes only. It is not drawn to scale. Any measurements, floor areas (including any total floor area), openings and orientation are approximate. No details are guaranteed, they cannot be relied upon for any purpose and they do not form part of any agreement. No liability is taken for any error, omission or misstatement. A party must rely upon its own inspection(s). Powered by www.focalagent.com

To view this property please contact Connells on

T 01296 395 111

E aylesbury@connells.co.uk

2 Temple Street
AYLESBURY HP20 2RH

EPC Rating: E

Tenure: Freehold

[check out more properties at connells.co.uk](http://connells.co.uk)



1. MONEY LAUNDERING REGULATIONS Intending purchasers will be asked to produce identification documentation at a later stage and we would ask for your co-operation in order that there will be no delay in agreeing the sale. 2. These particulars do not constitute part or all of an offer or contract. 3. The measurements indicated are supplied for guidance only and as such must be considered incorrect. Potential buyers are advised to recheck measurements before committing to any expense. 4. We have not tested any apparatus, equipment, fixtures, fittings or services and it is in the buyers interest to check the working condition of any appliances.

Connells Residential is registered in England and Wales under company number 1489613, Registered Office is Cumbria House, 16-20 Hockliffe Street, Leighton Buzzard, Bedfordshire, LU7 1GN. VAT Registration Number is 500 2481 05.

See all our properties at www.connells.co.uk | www.rightmove.co.uk | www.zoopla.co.uk

Property Ref: ALS311675 - 0003