



Connells

Tipton Crescent
Broughton Aylesbury

Tipton Crescent Broughton Aylesbury HP22 7BJ

for sale offers over
£425,000



Property Description

CONNELLS, Aylesbury are very pleased to welcome to the market this very well-presented David Wilson Leeman Style town house being situated within a very popular development on the Southside of Aylesbury.

This stunning home comprises of:

Entrance hall with ample storage, downstairs shower room, ground floor bedroom / reception room, rear lounge with storage and French doors to garden, generous modern fitted kitchen / diner with integrated appliances, upper floor second reception room / bedroom, two further spacious bedrooms with en-suite to master and all with access to a family bathroom.

To the rear of the property is a very well-maintained landscaped garden and to the front of the property offers off street parking for two vehicles.

Internal viewing of this property is highly recommended!

Entrance Hall

Door to front, vinyl underfoot, double door storage.

Ground Floor Wc

WC, wash hand basin, vinyl underfoot, walk-in shower.

Lounge / Bedroom Four

15' 7" x 14' 4" (4.75m x 4.37m)

Two juliet doors to front, carpet underfoot, radiator.

Ground Floor Lounge

18' 2" x 10' 7" (5.54m x 3.23m)

French doors to rear, vinyl underfoot, radiator.

Kitchen / Diner

18' 4" L shaped x 13' 5" L shaped (5.59m L shaped x 4.09m L shaped)

Two windows to rear, vinyl underfoot, part tiling, wall and base units, integrated dishwasher, washing machine, gas hob and electric ovens, fridge / freezer.

Landing

Carpet underfoot.

Bedroom One

15' 7" x 10' 9" (4.75m x 3.28m)

Two windows to front, carpet underfoot, radiator.

En-Suite

WC, wash hand basin, walk-in shower, heated towel radiator, part tiling, vinyl underfoot.

Bedroom Two

18' 8" x 9' 8" (5.69m x 2.95m)

Two windows to rear, carpet underfoot, radiator, loft hatch with ladder offering part boarding loft.

Bedroom Three

10' 7" x 9' 5" (3.23m x 2.87m)

Window to front, carpet underfoot, radiator.

Family Bathroom

WC, wash hand basin, bath / mixer with over head shower, part tiling, vinyl underfoot, heated towel radiator.

Rear Garden

Patio with surrounding pathway, mainly laid to lawn, enclosed fencing with rear access.

Parking

Two allocated parking spaces located in front of the property

Agent Note

Currently the vendors details do not match the registered title at Land Registry. Please ask the branch for more details.







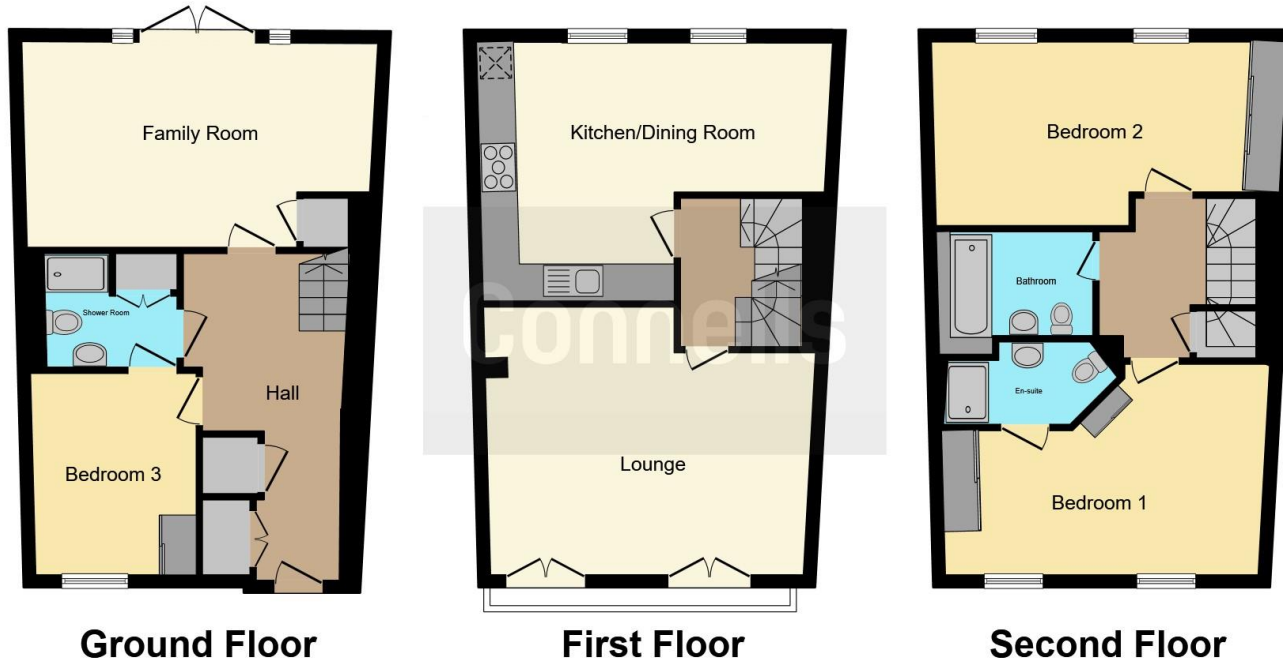

This floor plan is for illustrative purposes only. It is not drawn to scale. Any measurements, floor areas (including any total floor area), openings and orientation are approximate. No details are guaranteed, they cannot be relied upon for any purpose and they do not form part of any agreement. No liability is taken for any error, omission or misstatement. A party must rely upon its own inspection(s). Powered by www.focalagent.com

To view this property please contact Connells on

T 01296 395 111

E aylesbury@connells.co.uk

2 Temple Street
AYLESBURY HP20 2RH

EPC Rating: B

view this property online connells.co.uk/Property/ALS311094

Tenure: Freehold



1. MONEY LAUNDERING REGULATIONS Intending purchasers will be asked to produce identification documentation at a later stage and we would ask for your co-operation in order that there will be no delay in agreeing the sale. 2. These particulars do not constitute part or all of an offer or contract. 3. The measurements indicated are supplied for guidance only and as such must be considered incorrect. Potential buyers are advised to recheck measurements before committing to any expense. 4. We have not tested any apparatus, equipment, fixtures, fittings or services and it is in the buyers interest to check the working condition of any appliances.

Connells Residential is registered in England and Wales under company number 1489613, Registered Office is Cumbria House, 16-20 Hockliffe Street, Leighton Buzzard, Bedfordshire, LU7 1GN. VAT Registration Number is 500 2481 05.

See all our properties at www.connells.co.uk | www.rightmove.co.uk | www.zoopla.co.uk

Property Ref: ALS311094 - 0004