



Connells

Totteridge Road
High Wycombe



Property Description

Connells are delighted to present this three bedroom semi detached family home which is offered chain free and would make an ideal investment. Located close to popular and sought after primary/secondary schools & nurseries with the added benefit from being only 0.6 miles away from Town & High Wycombe Station.

The property boasts spacious living, a very large private rear garden and own drive with off street parking. With potential to extend subject to relevant planning permissions and offering the opportunity to make it your own the property has been priced to sell.

Entrance Hall

Reception Room

10' 10" max x 11' 1" max (3.30m max x 3.38m max)

Dining Room

12' 6" max x 9' 5" max (3.81m max x 2.87m max)

Kitchen

8' 1" max x 13' 7" max (2.46m max x 4.14m max)

Landing

Bedroom One

8' 10" max x 10' max (2.69m max x 3.05m max)

Bedroom Two

11' 7" max x 11' 1" max (3.53m max x 3.38m max)

Bedroom Three

9' 7" max x 12' 6" max (2.92m max x 3.81m max)

Bathroom

6' 1" max x 5' 9" max (1.85m max x 1.75m max)



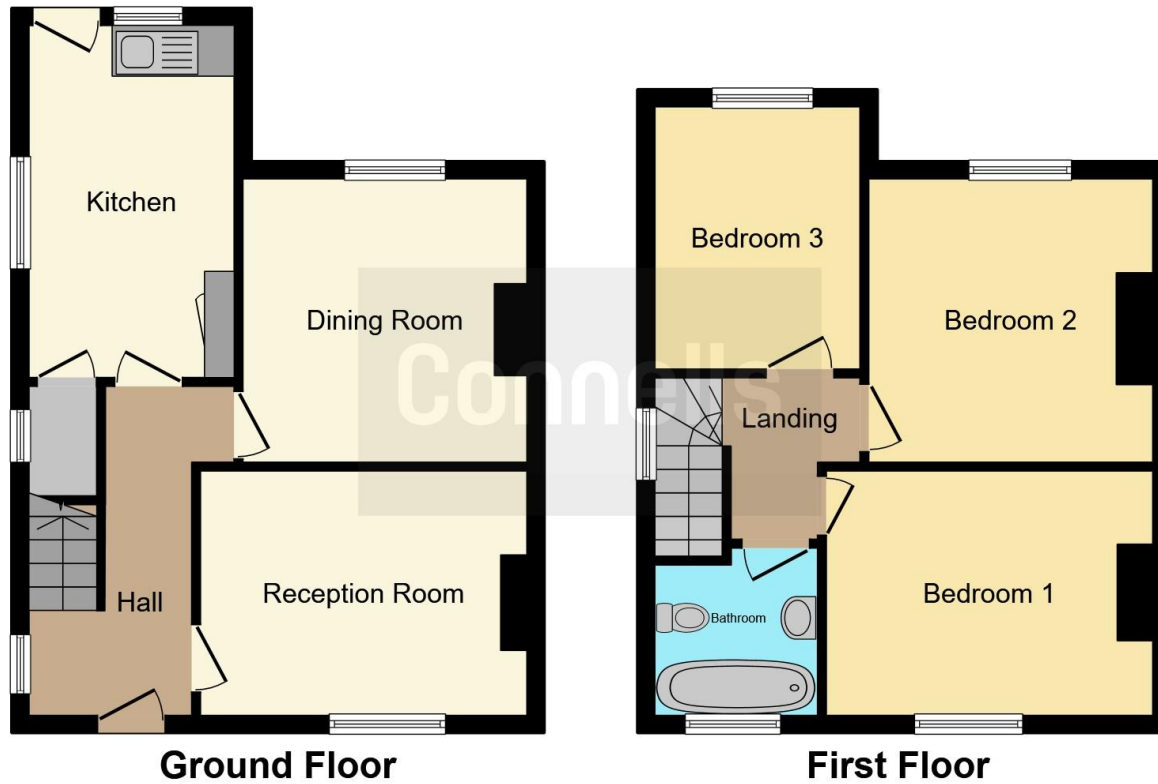

This floor plan is for illustrative purposes only. It is not drawn to scale. Any measurements, floor areas (including any total floor area), openings and orientation are approximate. No details are guaranteed, they cannot be relied upon for any purpose and they do not form part of any agreement. No liability is taken for any error, omission or misstatement. A party must rely upon its own inspection(s). Powered by www.focalagent.com

To view this property please contact Connells on

T 01494 534 822
E highwycombe@connells.co.uk

1-3 Queen Victoria Road
 HIGH WYCOMBE HP11 1BA

EPC Rating: C

[check out more properties at connells.co.uk](http://www.connells.co.uk)

Tenure: Freehold



1. MONEY LAUNDERING REGULATIONS Intending purchasers will be asked to produce identification documentation at a later stage and we would ask for your co-operation in order that there will be no delay in agreeing the sale. 2. These particulars do not constitute part or all of an offer or contract. 3. The measurements indicated are supplied for guidance only and as such must be considered incorrect. Potential buyers are advised to recheck measurements before committing to any expense. 4. We have not tested any apparatus, equipment, fixtures, fittings or services and it is in the buyers interest to check the working condition of any appliances.

Connells Residential is registered in England and Wales under company number 1489613, Registered Office is Cumbria House, 16-20 Hockliffe Street, Leighton Buzzard, Bedfordshire, LU7 1GN. VAT Registration Number is 500 2481 05.

See all our properties at www.connells.co.uk | www.rightmove.co.uk | www.zoopla.co.uk

Property Ref: WYC312657 - 0003