



Connells

Bushey Close
High Wycombe



Property Description

Connells are delighted to bring to the market this terraced three-bedroom family home found in a residential cul-de-sac. The accommodation comprises entrance hall, lounge/dining room, kitchen, first floor landing, three bedrooms, bathroom, gas heating to radiators, double glazing and front and rear gardens.

Living Room

24' 11" max x 15' 11" max (7.59m max x 4.85m max)

Kitchen

8' 11" max x 7' 10" max (2.72m max x 2.39m max)

Bathroom

7' 9" max x 6' 7" max (2.36m max x 2.01m max)

Bedroom One

7' 9" max x 6' 8" max (2.36m max x 2.03m max)

Bedroom Two

11' 5" max x 9' 2" max (3.48m max x 2.79m max)

Bedroom Three

13' 4" max x 9' 3" max (4.06m max x 2.82m max)

Bathroom

7' 9" max x 6' 7" max (2.36m max x 2.01m max)





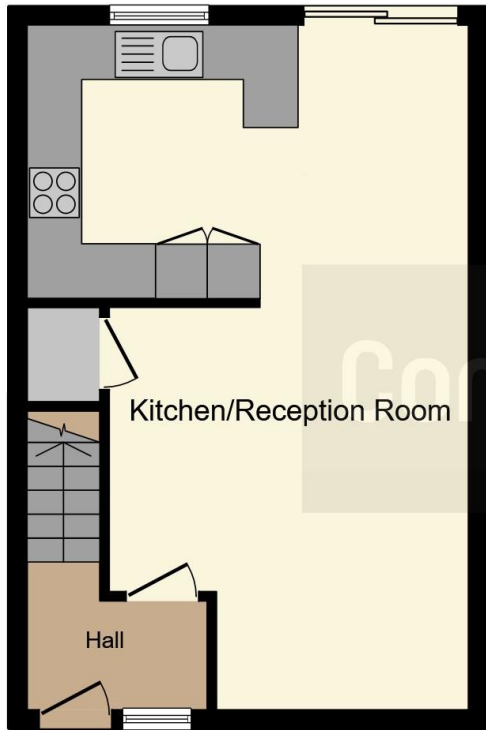

Ground Floor

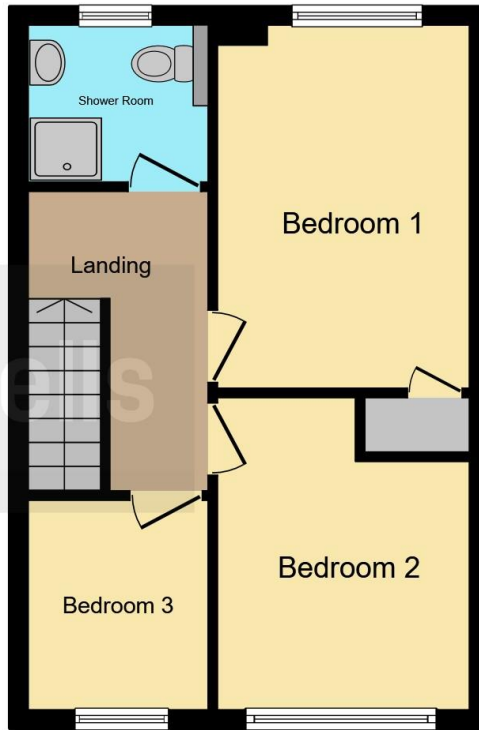

First Floor

This floor plan is for illustrative purposes only. It is not drawn to scale. Any measurements, floor areas (including any total floor area), openings and orientation are approximate. No details are guaranteed, they cannot be relied upon for any purpose and they do not form part of any agreement. No liability is taken for any error, omission or misstatement. A party must rely upon its own inspection(s). Powered by www.focalagent.com

To view this property please contact Connells on

T 01494 534 822
E highwycombe@connells.co.uk

1-3 Queen Victoria Road
 HIGH WYCOMBE HP11 1BA

EPC Rating: B

view this property online connells.co.uk/Property/WYC312667



Tenure: Freehold



1. MONEY LAUNDERING REGULATIONS Intending purchasers will be asked to produce identification documentation at a later stage and we would ask for your co-operation in order that there will be no delay in agreeing the sale. 2. These particulars do not constitute part or all of an offer or contract. 3. The measurements indicated are supplied for guidance only and as such must be considered incorrect. Potential buyers are advised to recheck measurements before committing to any expense. 4. We have not tested any apparatus, equipment, fixtures, fittings or services and it is in the buyers interest to check the working condition of any appliances.

Connells Residential is registered in England and Wales under company number 1489613, Registered Office is Cumbria House, 16-20 Hockliffe Street, Leighton Buzzard, Bedfordshire, LU7 1GN. VAT Registration Number is 500 2481 05.

See all our properties at www.connells.co.uk | www.rightmove.co.uk | www.zoopla.co.uk

Property Ref: WYC312667 - 0003