



Connells

Bevelwood Gardens
High Wycombe



Property Description

Offered to the market with no onward chain is this one bedroom house in Bevelwood Gardens. The property is in excellent decorative order and has a reception room which is open plan to the kitchen with wall and base units and integrated oven, hob, washer/dryer and dishwasher. Stairs to the first floor landing leading to the double bedroom with fitted wardrobes. The bathroom is fully tiled and comprises bath with shower over, WC and wash hand basin. Further benefits from communal garden and residents parking. This property would be ideal for a first time buyer or investor.

Ideally located to the west of the town centre the property benefits from a number of amenities within walking distance and a flat walk into the town centre.

Kitchen / Reception Room

18' 5" max x 12' 2" max (5.61m max x 3.71m max)

Bedroom

10' 4" max x 11' 1" max (3.15m max x 3.38m max)

Bathroom

7' 1" max x 5' 7" max (2.16m max x 1.70m max)





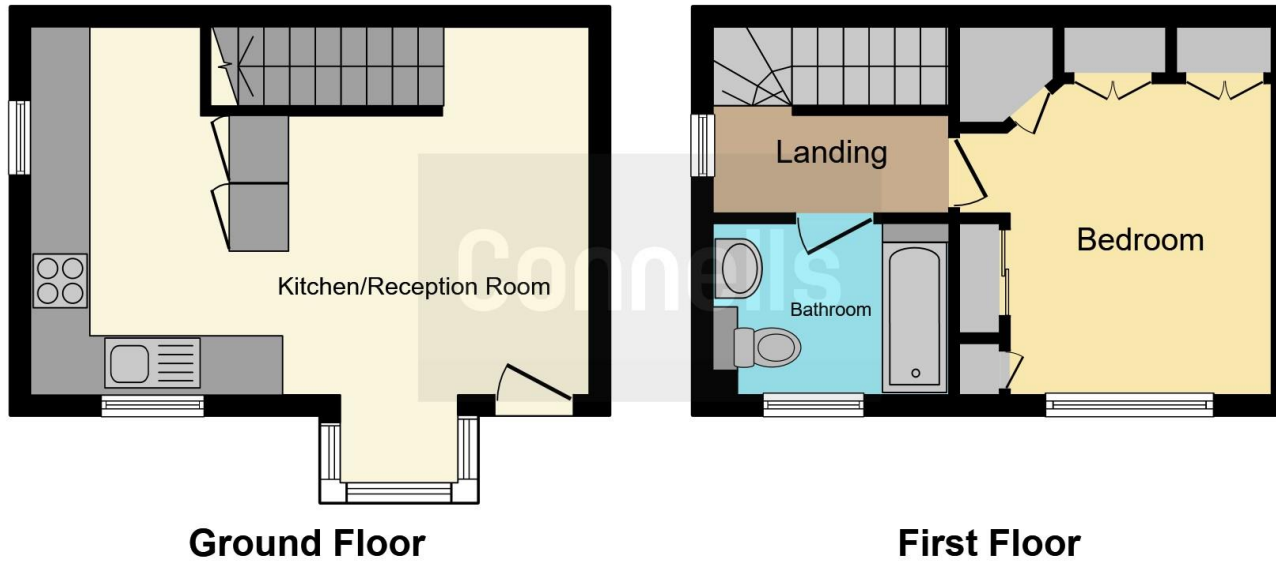

This floor plan is for illustrative purposes only. It is not drawn to scale. Any measurements, floor areas (including any total floor area), openings and orientation are approximate. No details are guaranteed, they cannot be relied upon for any purpose and they do not form part of any agreement. No liability is taken for any error, omission or misstatement. A party must rely upon its own inspection(s). Powered by www.focalagent.com

To view this property please contact Connells on

T 01494 534 822
E highwycombe@connells.co.uk

1-3 Queen Victoria Road
 HIGH WYCOMBE HP11 1BA

EPC Rating: F

view this property online connells.co.uk/Property/WYC312294

This is a Leasehold property with details as follows; Term of Lease 999 years from 01 Jan 1985. Should you require further information please contact the branch. Please Note additional fees could be incurred for items such as Leasehold packs.

Tenure: Leasehold



1. MONEY LAUNDERING REGULATIONS Intending purchasers will be asked to produce identification documentation at a later stage and we would ask for your co-operation in order that there will be no delay in agreeing the sale. 2. These particulars do not constitute part or all of an offer or contract. 3. The measurements indicated are supplied for guidance only and as such must be considered incorrect. Potential buyers are advised to recheck measurements before committing to any expense. 4. We have not tested any apparatus, equipment, fixtures, fittings or services and it is in the buyers interest to check the working condition of any appliances.

Connells Residential is registered in England and Wales under company number 1489613, Registered Office is Cumbria House, 16-20 Hockliffe Street, Leighton Buzzard, Bedfordshire, LU7 1GN. VAT Registration Number is 500 2481 05.

See all our properties at www.connells.co.uk | www.rightmove.co.uk | www.zoopla.co.uk

Property Ref: WYC312294 - 0004