



**Connells**

Jubilee Cottage Marlow Road  
Lane End High Wycombe



# Jubilee Cottage Marlow Road Lane End High Wycombe HP14 3JP

for sale offers over  
**£500,000**



## Property Description

Semi-detached house located in the village of Lane End. Offered to the market in excellent condition with versatile accommodation. The property boasts a large open plan reception room which spans from front to back of the property and is currently set up as three separate areas, front reception room with fireplace and a bay window, leading into the living room and on into the dining room which has door leading to the rear garden. The kitchen / utility is light and airy with windows overlooking the rear garden and side aspect; the wall and base level units provide plenty of storage, integrated oven and hob with cooker hood, and space for white goods.

Bedroom four, which could also be used as a study, is located on the ground floor, with a partly tiled ensuite with shower cubicle, WC and wash hand basin with vanity.

The principal bedroom, located on the first floor, has bay window to the front aspect and chimney breast. There are two further bedrooms on this floor and the family bathroom with bath, WC and wash hand basin with vanity.

The property benefits from driveway parking for four cars, and gated side access to the garden. There are two outbuildings, one of which has been set up as a bar, great for entertaining on a summers evening; and a workshop. The mature rear garden is fully enclosed and south facing. With a range of beds, chicken coup, pond, swing, green house. The garden backs on to an orchard and fields.

## Entrance Hall

15' 3" max x 6' 4" max (4.65m max x 1.93m max)

## Reception Room

11' 5" max x 10' 8" max (3.48m max x 3.25m max)

## Living Room

33' 6" max x 10' 8" max (10.21m max x 3.25m max)

## Dining Room

9' 3" max x 9' 9" max (2.82m max x 2.97m max)

## Kitchen

17' 3" max x 13' 1" max (5.26m max x 3.99m max)

## Utility

7' 3" max x 6' 4" max (2.21m max x 1.93m max)

## Bedroom Four/Study

8' 7" max x 6' 4" max (2.62m max x 1.93m max)

## Ensuite

7' 6" max x 6' 3" max (2.29m max x 1.91m max)

### **Landing**

9' 1" max x 6' 9" max (2.77m max x 2.06m max)

### **Bedroom One**

13' 8" max x 10' 1" max (4.17m max x 3.07m max)

### **Bedroom Two**

12' 7" max x 10' 1" max (3.84m max x 3.07m max)

### **Bedroom Three**

8' 5" max x 6' 5" max (2.57m max x 1.96m max)

### **Bathroom**

7' 1" max x 6' 5" max (2.16m max x 1.96m max)



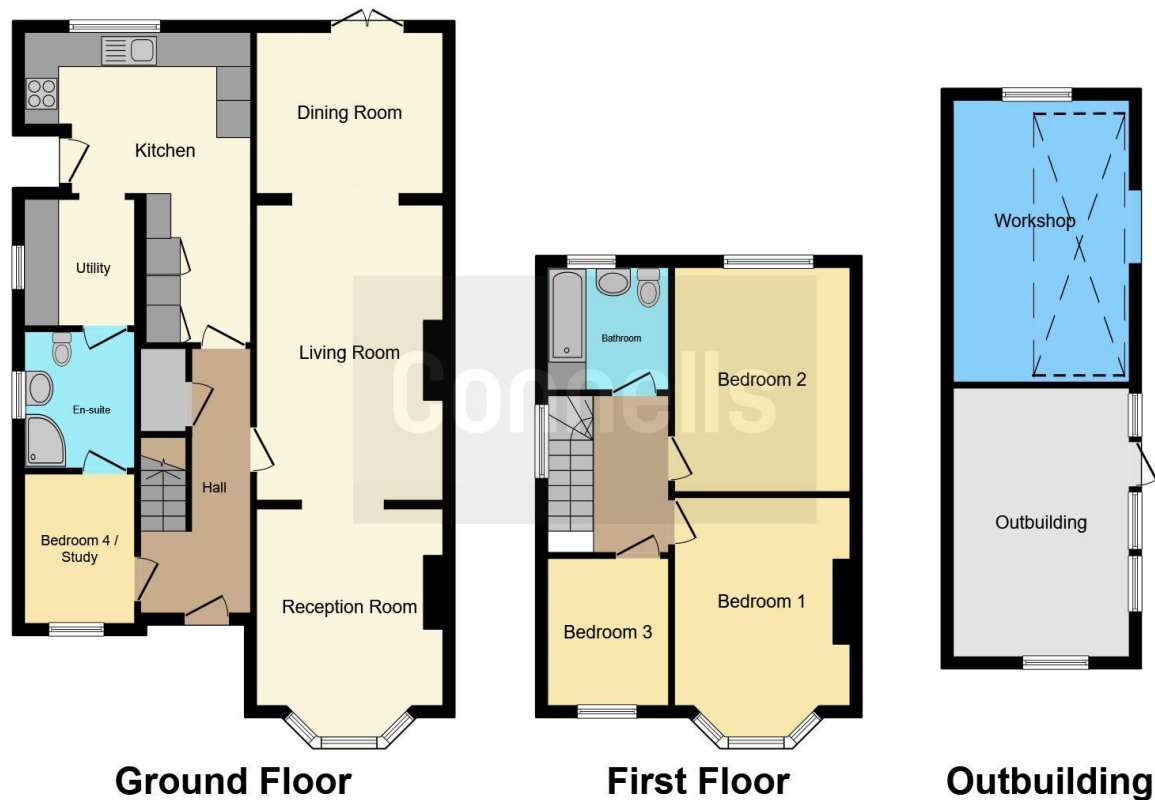

This floor plan is for illustrative purposes only. It is not drawn to scale. Any measurements, floor areas (including any total floor area), openings and orientation are approximate. No details are guaranteed, they cannot be relied upon for any purpose and they do not form part of any agreement. No liability is taken for any error, omission or misstatement. A party must rely upon its own inspection(s). Powered by [www.focalagent.com](http://www.focalagent.com)

To view this property please contact Connells on

**T 01494 534 822**  
**E [highwycombe@connells.co.uk](mailto:highwycombe@connells.co.uk)**

1-3 Queen Victoria Road  
 HIGH WYCOMBE HP11 1BA

**EPC Rating: C**

**view this property online [connells.co.uk/Property/WYC311835](http://connells.co.uk/Property/WYC311835)**

Tenure: Freehold



1. MONEY LAUNDERING REGULATIONS Intending purchasers will be asked to produce identification documentation at a later stage and we would ask for your co-operation in order that there will be no delay in agreeing the sale. 2. These particulars do not constitute part or all of an offer or contract. 3. The measurements indicated are supplied for guidance only and as such must be considered incorrect. Potential buyers are advised to recheck measurements before committing to any expense. 4. We have not tested any apparatus, equipment, fixtures, fittings or services and it is in the buyers interest to check the working condition of any appliances.

Connells Residential is registered in England and Wales under company number 1489613, Registered Office is Cumbria House, 16-20 Hockliffe Street, Leighton Buzzard, Bedfordshire, LU7 1GN. VAT Registration Number is 500 2481 05.

**See all our properties at [www.connells.co.uk](http://www.connells.co.uk) | [www.rightmove.co.uk](http://www.rightmove.co.uk) | [www.zoopla.co.uk](http://www.zoopla.co.uk)**

Property Ref: WYC311835 - 0015