



Connells

Anglesey Close  
Basingstoke

# Anglesey Close Basingstoke RG24 9PP

for sale  
**£300,000**



## Property Description

Situated in Anglesey Close in Popley is this Three Bedroom End Of Terrace Home which benefits from access to Chineham business Park, Basingstoke Hospital, schools and further local amenities. It also offers easy access to the A33 towards Reading and there is a regular bus service into Basingstoke Town Centre where you can find Festival Place shopping centre. The town centre also has a main line railway station with a fast train to London-Waterloo in approximately 45 minutes.

## Cloakroom/Utility

Double glazed window to front, low level wc, wash hand basin with splash tiles, plumbing for washing machine, tiled floor.

## Lounge / Diner

19' 10" Max x 11' 10" Max ( 6.05m Max x 3.61m Max )

Double glazed window and patio doors to rear, part carpet, part tiled floor, fireplace feature, radiator?

## Kitchen

11' 6" x 8' 10" ( 3.51m x 2.69m )

Double glazed window to front, fitted kitchen wall/base units, integrated oven, gas hob, space for fridge/freezer, part tiled, tiled floor.

## Bedroom One

15' 1" Max x 9' 10" Max ( 4.60m Max x 3.00m Max )

Double glazed window to front, wardrobes, radiator.

## Bedroom Two

12' 2" x 9' 6" ( 3.71m x 2.90m )

Double glazed window to front, carpet, radiator.

## Bedroom Three

10' Max x 8' 6" Max ( 3.05m Max x 2.59m Max )

Double glazed window to rear, carpet, radiator.

## Bathroom

Double glazed window to rear wash hand basin, low level wc, corner bath, part tiled, radiator.







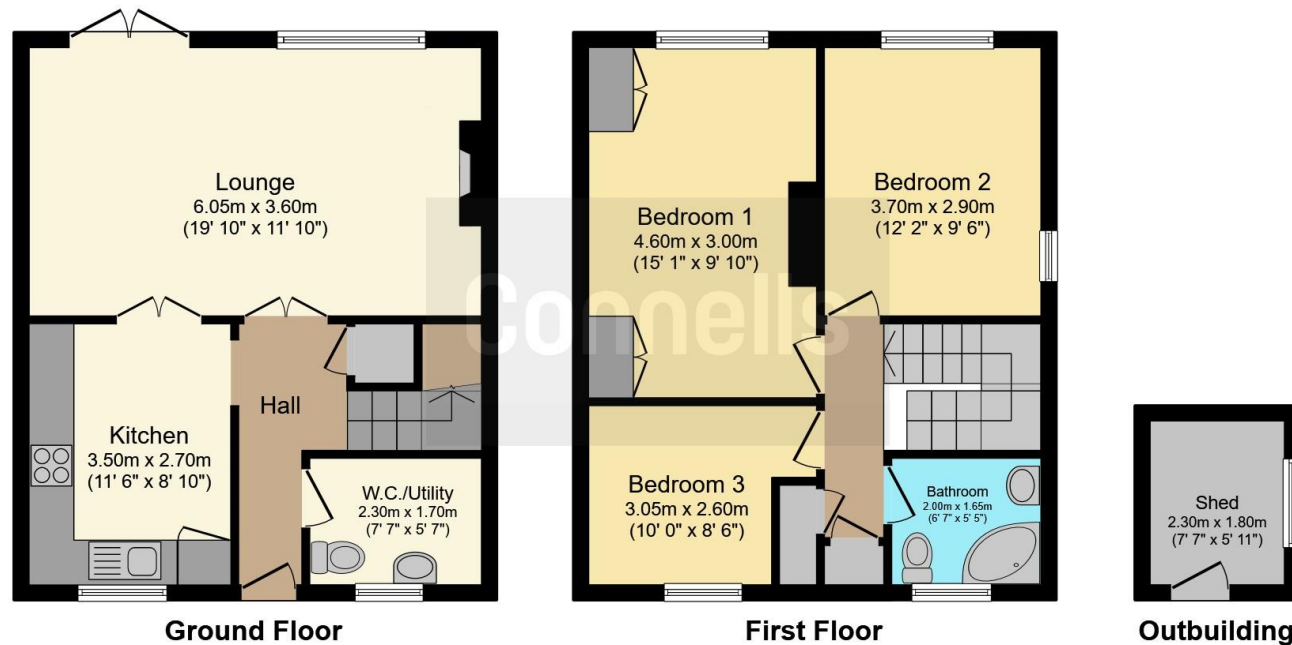

This floor plan is for illustrative purposes only. It is not drawn to scale. Any measurements, floor areas (including any total floor area), openings and orientation are approximate. No details are guaranteed, they cannot be relied upon for any purpose and they do not form part of any agreement. No liability is taken for any error, omission or misstatement. A party must rely upon its own inspection(s). Powered by [www.focalagent.com](http://www.focalagent.com)

To view this property please contact Connells on

**T 01256 464566**  
**E [basingstoke@connells.co.uk](mailto:basingstoke@connells.co.uk)**

1 Wote Street  
 BASINGSTOKE RG21 7NE

EPC Rating: D Council Tax  
 Band: C

Tenure: Freehold

**view this property online [connells.co.uk/Property/BTK313574](http://connells.co.uk/Property/BTK313574)**



1. MONEY LAUNDERING REGULATIONS Intending purchasers will be asked to produce identification documentation at a later stage and we would ask for your co-operation in order that there will be no delay in agreeing the sale. 2. These particulars do not constitute part or all of an offer or contract. 3. The measurements indicated are supplied for guidance only and as such must be considered incorrect. Potential buyers are advised to recheck measurements before committing to any expense. 4. We have not tested any apparatus, equipment, fixtures, fittings or services and it is in the buyers interest to check the working condition of any appliances.

Connells Residential is registered in England and Wales under company number 1489613, Registered Office is Cumbria House, 16-20 Hockliffe Street, Leighton Buzzard, Bedfordshire, LU7 1GN. VAT Registration Number is 500 2481 05.

**See all our properties at [www.connells.co.uk](http://www.connells.co.uk) | [www.rightmove.co.uk](http://www.rightmove.co.uk) | [www.zoopla.co.uk](http://www.zoopla.co.uk)**

Property Ref: BTK313574 - 0010