



Property Description

Located within the ever-popular Kingsmere development, this well-presented two-bedroom coach house is offered for sale with no onward chain.

The home features a bright and spacious open-plan living area, complete with a modern fitted kitchen that includes integrated appliances. There are two comfortable double bedrooms and a stylish family bathroom, providing practical and well-balanced accommodation throughout.

A particular benefit of this property is the garage with internal access, offering both convenience and additional storage options.

To the rear, a private courtyard garden provides a pleasant outdoor space.

Well maintained and ideally located close to local amenities, schools, and transport links, this delightful coach house makes an excellent first home, or investment opportunity.



Entrance Hall

Carpet, access to stairs, door to integral garage

Landing

Newly fitted carpet, access to living area, bedrooms and bathroom. Double door built in storage cupboard. Windows to rear of property

Open Plan Living Area

Partially tiles and newly fitted carpet area, window to front of property. Wall and base units, integrated oven, gas hob, extractor, dish washer and fridge freezer. Built in storage cupboard

Bedroom One

Newly fitted carpet, double bedroom, carpet, built in sliding door storage, window to front of property

Bedroom Two

Newly fitted carpet, double bedroom, carpet, built in sliding door storage, window to front of property

Family Bathroom

Tiled floor, partially tiled walls, bath with overhead shower, WC, basin, towel rail, window to rear of property



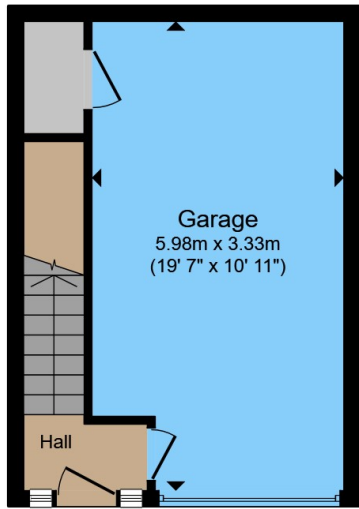

Ground Floor

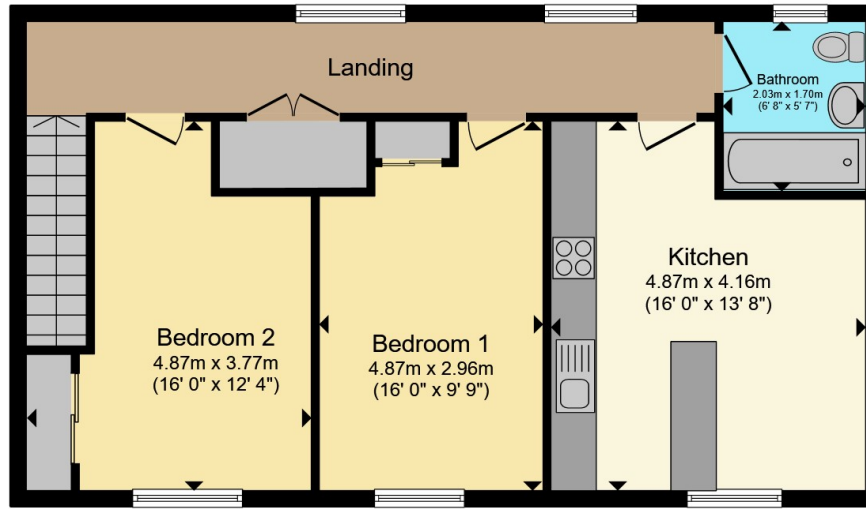

First Floor

Total floor area 95.1 m² (1,024 sq.ft.) approx

This floor plan is for illustrative purposes only. It is not drawn to scale. Any measurements, floor areas (including any total floor area), openings and orientation are approximate. No details are guaranteed, they cannot be relied upon for any purpose and they do not form part of any agreement. No liability is taken for any error, omission or misstatement. A party must rely upon its own inspection(s). Powered by www.propertybox.io

Connells



To view this property please contact Connells on

T 01869 244761

E bicester@connells.co.uk

5 Market Square
BICESTER OX26 6AA

EPC Rating: C Council Tax
Band: B

Tenure: Freehold

view this property online connells.co.uk/Property/BIC309606



1. MONEY LAUNDERING REGULATIONS Intending purchasers will be asked to produce identification documentation at a later stage and we would ask for your co-operation in order that there will be no delay in agreeing the sale. 2. These particulars do not constitute part or all of an offer or contract. 3. The measurements indicated are supplied for guidance only and as such must be considered incorrect. Potential buyers are advised to recheck measurements before committing to any expense. 4. We have not tested any apparatus, equipment, fixtures, fittings or services and it is in the buyers interest to check the working condition of any appliances.

Connells Residential is registered in England and Wales under company number 1489613, Registered Office is Cumbria House, 16-20 Hockliffe Street, Leighton Buzzard, Bedfordshire, LU7 1GN. VAT Registration Number is 500 2481 05.

See all our properties at www.connells.co.uk | www.rightmove.co.uk | www.zoopla.co.uk

Property Ref: BIC309606 - 0002