



Connells

Sherwood Close
Launton, Bicester

Sherwood Close Launton, Bicester, OX26 5DR

for sale offers in excess of
£450,000



Property Description

Situated in the desirable village of Launton, this well-presented four-bedroom detached family home offers spacious and versatile living. The ground floor features a stylish kitchen diner, a bright and welcoming living room, and an additional reception room that can be used as a home office, playroom, or formal dining space. A convenient ground-floor shower room adds to the practicality of the layout.

Upstairs, the home boasts four generously sized bedrooms, with the main bedroom benefiting from an en-suite, while a modern family bathroom serves the remaining rooms.

Launton offers a primary school, shops, choice of two public houses, a social club and playing field. Located only two miles from Bicester town centre providing access to all of Bicester's facilities as well as both mainline railway stations. The property heating system is supplied via oil, as there is no gas within Launton Village.

Outside, the rear garden provides a private outdoor space, perfect for relaxation or entertaining. Off-street driveway parking

ensures ample space for multiple vehicles. Offering a blend of comfort and functionality, this home is ideal for families seeking village living with excellent amenities nearby.

Entrance Hall

Carpet, access stairs to first floor, access to Living Room, Kitchen Diner and shower room, under stairs storage.

Groundfloor Shower Room

Shower, WC, Basin, Towel Rail, located under stairwell.

Kitchen Diner

Kitchen area- Tiled Floor, integral double oven electric hob, dishwasher, door access to garden

Dining Area- engineered wooden flooring, built in worktop and storage, access to living area and doors to garden.

Living Room

Carpeted, window to front of property, access to dining area and entrance hall.

Additional Reception Room

Carpeted, window to front of property, multi-use room, (office, playroom, additional reception room, bedroom). Access via kitchen.

Landing

Access to all four bedrooms and family bathroom, carpet, loft access point.

Bedroom One

Double Bedroom, Carpeted, Built in Storage, Window to front of property, access to Ensuite.

Ensuite- Tiled Floor and Walls, Shower Cubicle, WC, Basin.

Bedroom Two

Double Bedroom, Carpet, Window to rear of property.

Bedroom Three

Double Bedroom, Carpet, Window to Front of Property

Bedroom Four

Single Bedroom, Carpet, window to front of property, built in over stairs storage.



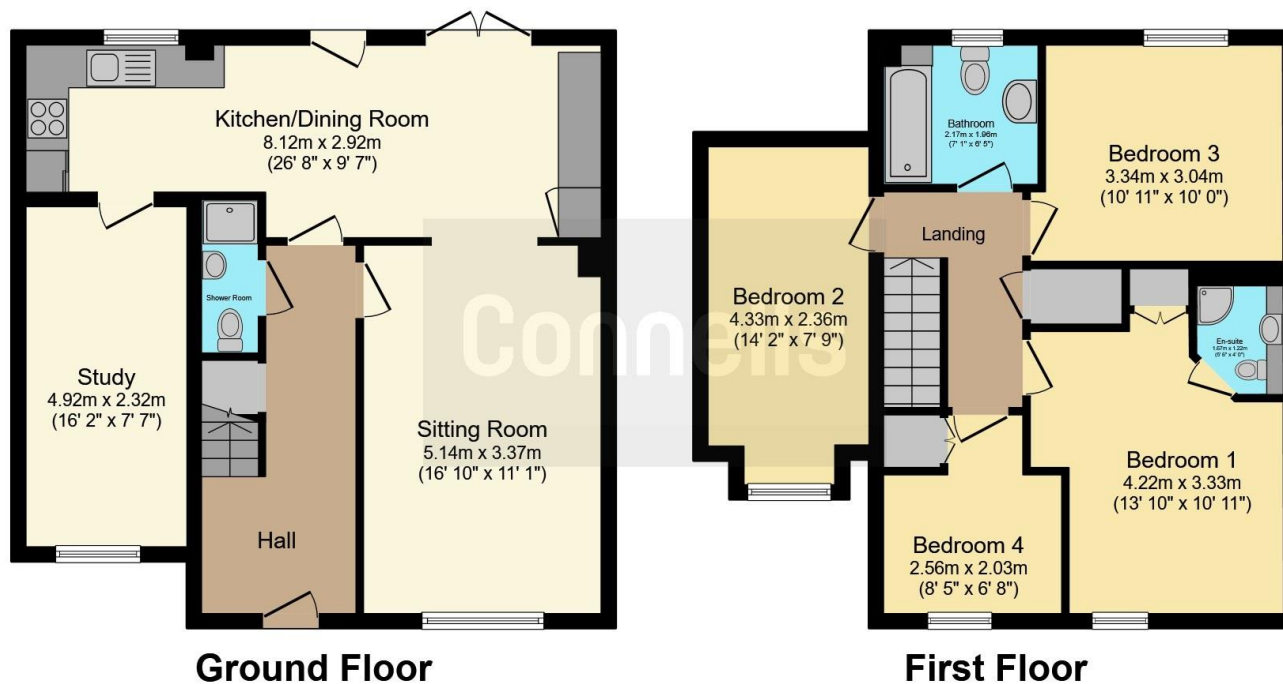

This floor plan is for illustrative purposes only. It is not drawn to scale. Any measurements, floor areas (including any total floor area), openings and orientation are approximate. No details are guaranteed, they cannot be relied upon for any purpose and they do not form part of any agreement. No liability is taken for any error, omission or misstatement. A party must rely upon its own inspection(s). Powered by www.focalagent.com

To view this property please contact Connells on

T 01869 244761
E bicester@connells.co.uk

5 Market Square
 BICESTER OX26 6AA

EPC Rating: C

view this property online connells.co.uk/Property/BIC309145



Tenure: Freehold



1. MONEY LAUNDERING REGULATIONS Intending purchasers will be asked to produce identification documentation at a later stage and we would ask for your co-operation in order that there will be no delay in agreeing the sale. 2. These particulars do not constitute part or all of an offer or contract. 3. The measurements indicated are supplied for guidance only and as such must be considered incorrect. Potential buyers are advised to recheck measurements before committing to any expense. 4. We have not tested any apparatus, equipment, fixtures, fittings or services and it is in the buyers interest to check the working condition of any appliances.

Connells Residential is registered in England and Wales under company number 1489613, Registered Office is Cumbria House, 16-20 Hockliffe Street, Leighton Buzzard, Bedfordshire, LU7 1GN. VAT Registration Number is 500 2481 05.

See all our properties at www.connells.co.uk | www.rightmove.co.uk | www.zoopla.co.uk

Property Ref: BIC309145 - 0004