



**Connells**

Longworth Close  
Banbury





## Property Description

A WELL PRESENTED THREE BEDROOM DETACHED PROPERTY SITUATED IN THE NEW GRIMSBURY AREA OF BANBURY.

Comprising of entrance hall, kitchen / diner, lounge, en-suite to master bedroom, bathroom, downstairs cloakroom and has front and rear gardens, garage and off road parking for three vehicles. The property benefits from, double glazed windows and patio doors and a en suite shower room.

### Entrance Hall

Access to ground floor rooms. Stairs rising to the first floor.

### Cloakroom

Double glazed window to the front aspect, Suite comprises of a low level wc, wash hand basin and radiator.

### Kitchen

11' 9" x 8' 6" ( 3.58m x 2.59m )

Double glazed window to the front aspect. A range of wall & base mounted units with worksurfaces over and incorporating a sink unit with tiles splashbacks.

### Lounge

14' 8" x 11' 9" ( 4.47m x 3.58m )

Double glazed window to the rear aspect and patio doors to the rear garden. Radiator.

### First Floor

Airing cupboard

### Bedroom One

11' 1" x 10' 3" ( 3.38m x 3.12m )

Double glazed window to the front aspect

### Ensuite

### Bedroom Two

8' 5" x 6' 9" ( 2.57m x 2.06m )

Double glazed window to the rear aspect, radiator.

### Bedroom Three

9' 3" x 5' 9" ( 2.82m x 1.75m )

Double glazed window to the rear aspect, radiator

### Bathroom

Double glazed window to the side aspect. Suite comprises of a paneled bath with shower over, wash hand basin and low level wc. Radiator.

### Outside

### Front Garden

A private drive for three homes nestled at the end of this cul-de-sac. Ample parking to the

garage.. Lovely lawn area with flower border.

## Rear Garden

An Enclosed Rear garden with patio area and gated side access to the Driveway. Then mainly laid to lawn with flower and plant borders. Greenhouse. In the valuers opinion offers a high degree of privacy.

## Garage

Good size driveway. Up and Over steel door and power and light.











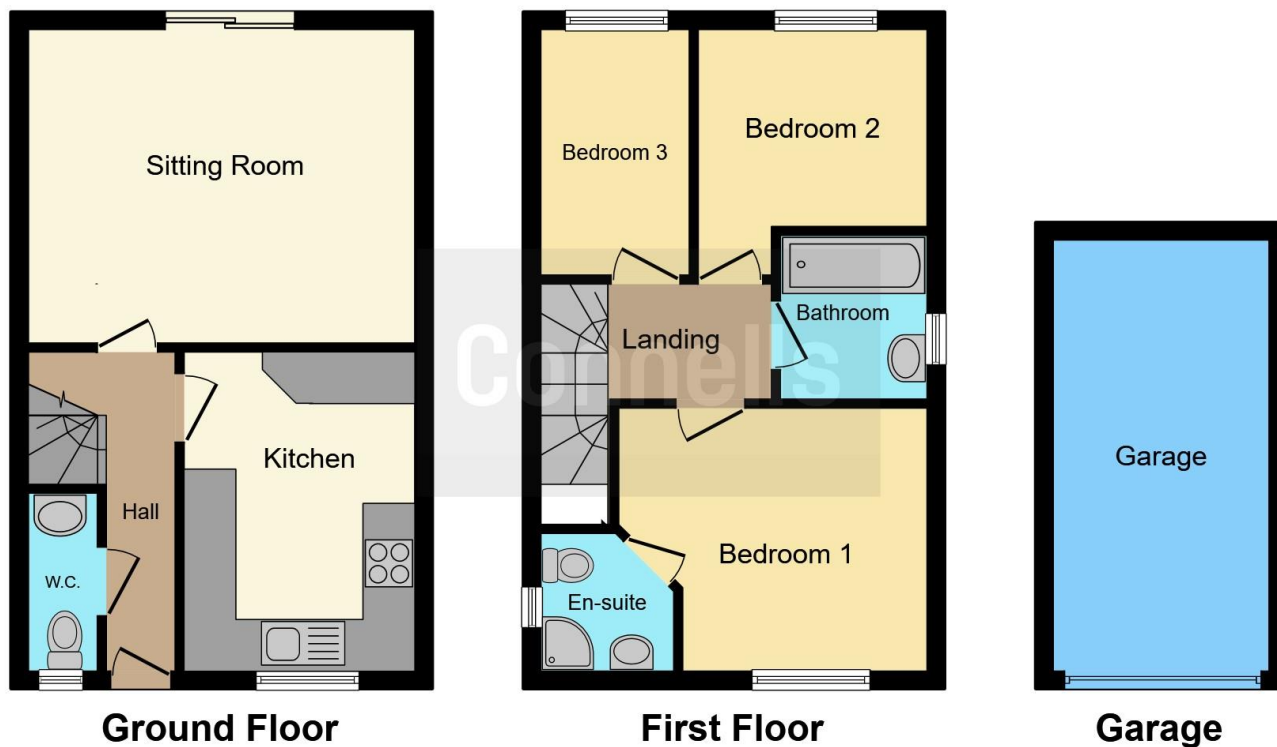

This floor plan is for illustrative purposes only. It is not drawn to scale. Any measurements, floor areas (including any total floor area), openings and orientation are approximate. No details are guaranteed, they cannot be relied upon for any purpose and they do not form part of any agreement. No liability is taken for any error, omission or misstatement. A party must rely upon its own inspection(s). Powered by [www.focalagent.com](http://www.focalagent.com)

To view this property please contact Connells on

**T 01295 268 101**  
**E [banbury@connells.co.uk](mailto:banbury@connells.co.uk)**

33 Bridge Street  
 BANBURY OX16 5PN

**EPC Rating: Awaited**

Tenure: Freehold

**view this property online [connells.co.uk/Property/BAN308943](http://connells.co.uk/Property/BAN308943)**



1. MONEY LAUNDERING REGULATIONS Intending purchasers will be asked to produce identification documentation at a later stage and we would ask for your co-operation in order that there will be no delay in agreeing the sale. 2. These particulars do not constitute part or all of an offer or contract. 3. The measurements indicated are supplied for guidance only and as such must be considered incorrect. Potential buyers are advised to recheck measurements before committing to any expense. 4. We have not tested any apparatus, equipment, fixtures, fittings or services and it is in the buyers interest to check the working condition of any appliances.

Connells Residential is registered in England and Wales under company number 1489613, Registered Office is Cumbria House, 16-20 Hockliffe Street, Leighton Buzzard, Bedfordshire, LU7 1GN. VAT Registration Number is 500 2481 05.

**See all our properties at [www.connells.co.uk](http://www.connells.co.uk) | [www.rightmove.co.uk](http://www.rightmove.co.uk) | [www.zoopla.co.uk](http://www.zoopla.co.uk)**

Property Ref: BAN308943 - 0002