



**Connells**

Bretch Hill  
Banbury



### Property Description

This property is situated within close proximity to Banbury Town Centre, transport links and popular schools.

This family home benefits from a spacious living room, with downstairs shower room added by the current owners, a kitchen/diner and from the first floor landing there are three bedrooms and a family bathroom.

Externally the property has a good size front garden and private enclosed small rear garden

Internal inspection is highly recommended.

### Entrance Hall

Door to front aspect, stairs rising from ground floor to first floor.

### Lounge

13' 4" x 11' 4" ( 4.06m x 3.45m )  
Double glazed window to both front and rear aspects, television point and telephone point. Owners have built a downstairs shower room.

### Showerroom

Comprises of a shower, low level wc and wash hand basin.

### Kitchen/ Diner

17' 1" x 13' 4" ( 5.21m x 4.06m )

Double glazed window to front and rear aspect and patio doors leading to rear aspect, a fitted kitchen with a range of wall and base cupboards, 1 1/2 sink/drainers, space for washing machine and fridge freezer.

### Bedroom One

12' x 7' 7" ( 3.66m x 2.31m )  
Double glazed window to front aspect, built in wardrobes and radiator.

### Bedroom Two

9' 1" x 7' 1" ( 2.77m x 2.16m )  
Double glazed window to front aspect, built in wardrobes and radiator.

### Bedroom Three

10' 4" x 10' 4" ( 3.15m x 3.15m )  
Double glazed window to rear aspect and radiator.

### Bathroom

Double glazed windows to side aspect, a three piece suite comprising of WC, wash hand basin and bath.

### Outside

A good size front garden with pathway to front entrance door and mainly laid to lawn with flower and

plant borders

### KEY FEATURES

- Three Bedrooms
- Semi Detached
- Spacious Kitchen/Diner
- Popular Location
- Spacious Living Room
- Featuring solar panels, a modern combi-boiler, and double glazing



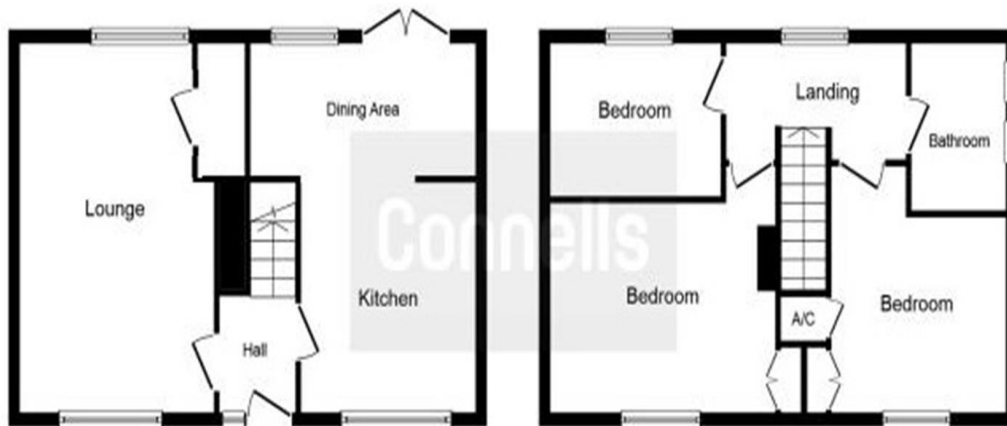

**Ground Floor**

**First Floor**

This plan is for illustration purposes only and may not be representative of the property. Plan not to scale.

Powered by audioagent.com



To view this property please contact Connells on

**T 01295 268 101**  
**E banbury@connells.co.uk**

33 Bridge Street  
 BANBURY OX16 5PN

**EPC Rating: D**

**view this property online [connells.co.uk/Property/BAN308727](http://connells.co.uk/Property/BAN308727)**

Tenure: Freehold



1. MONEY LAUNDERING REGULATIONS Intending purchasers will be asked to produce identification documentation at a later stage and we would ask for your co-operation in order that there will be no delay in agreeing the sale. 2. These particulars do not constitute part or all of an offer or contract. 3. The measurements indicated are supplied for guidance only and as such must be considered incorrect. Potential buyers are advised to recheck measurements before committing to any expense. 4. We have not tested any apparatus, equipment, fixtures, fittings or services and it is in the buyers interest to check the working condition of any appliances.

Connells Residential is registered in England and Wales under company number 1489613, Registered Office is Cumbria House, 16-20 Hockliffe Street, Leighton Buzzard, Bedfordshire, LU7 1GN. VAT Registration Number is 500 2481 05.

**See all our properties at [www.connells.co.uk](http://www.connells.co.uk) | [www.rightmove.co.uk](http://www.rightmove.co.uk) | [www.zoopla.co.uk](http://www.zoopla.co.uk)**

Property Ref: BAN308727 - 0003