



Connells

Cherry Tree Way
Witney



Property Description

Connells are delighted to market this OUTSTANDING SIX BEDROOM DETACHED FAMILY HOME located in the popular Madley Park development. Extended and improved by the current owners, this home offers the modern open plan family living on the ground floor with the addition of a separate home office.

The first floor offers four bedrooms including the master with an en suite and family bathroom. The second floor offers a further two bedrooms with a shower room, there is always a laundry cupboard with washing machine and dryer.

Externally there is a double garage with parking for four vehicles. Rear garden mainly laid to lawn with patio area.



Room Description

Living Room

17' 5" x 10' 8" (5.31m x 3.25m)

Spacious living room with oak door through to hallway and bi-fold door through to rear reception room. Oak flooring, Farmington stone fireplace, window to the front!

Kitchen/ Dining / Family Room

23' 6" Max x 30' 1" Max (7.16m Max x 9.17m Max)

Beautiful spacious and extended L shape room. Fitted kitchen with wall and base units. Granite work surfaces, fitted electric oven, gas hob, dishwasher, fridge/freezer. The boiler is housed in the kitchen, windows to the side and rear with doors onto the rear garden.

Study

10' 3" x 7' 5" (3.12m x 2.26m)

Home office set up with window to the front.

Bedroom One

17' 5" x 11' 1" (5.31m x 3.38m)

Dual aspect room with windows front & rear. Carpet and radiator. Door into en-suite.

En-Suite

Modern fitted en-suite comprising double walk in shower, vanity wash hand basin, low level wc. Window to the front.

Bedroom Two

13' 4" x 9' 5" (4.06m x 2.87m)

Window to the rear with carpet and radiator.

Bedroom Three

9' 6" x 10' 6" (2.90m x 3.20m)

Window to the front with fitted wardrobes and carpet.

Bedroom Four

8' 8" x 12' 3" (2.64m x 3.73m)

Window to the front and carpet.

Family Bathroom

Fitted bathroom suite comprising bath shower over, vanity wash hand basin and low level wc. Window to the side.

Bedroom Five

8' 8" x 10' 2" (2.64m x 3.10m)

Window to the front and carpet.

Bedroom Six

10' 6" x 7' 2" (3.20m x 2.18m)

Window to the side and carpet.

Shower Room

Fitted shower room with walk in shower unit, wash hand basin and low level wc. Velux window.

Laundry Room

Located on the second floor, there is a fitted washing machine and tumble dryer.



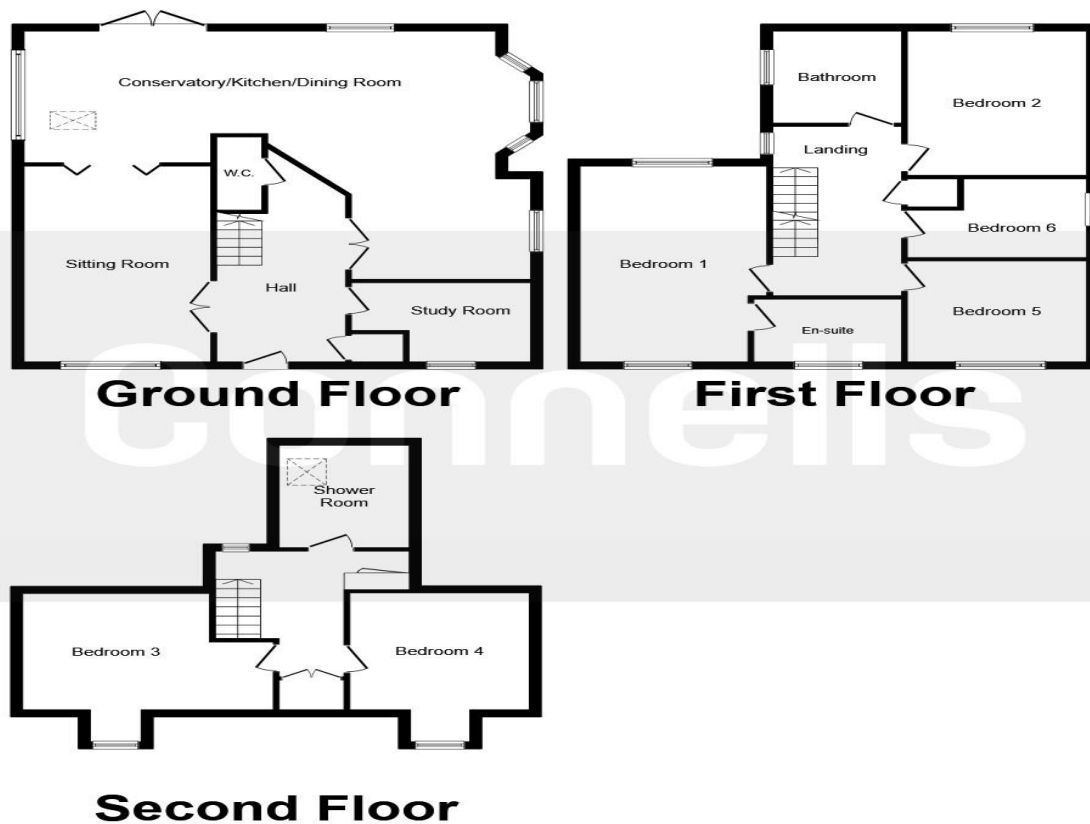

This floor plan is for illustrative purposes only. It is not drawn to scale. Any measurements, floor areas (including any total floor area), openings and orientation are approximate. No details are guaranteed, they cannot be relied upon for any purpose and they do not form part of any agreement. No liability is taken for any error, omission or misstatement. A party must rely upon its own inspection(s). Plan produced for Connells. Powered by www.focalagent.com

To view this property please contact Connells on

T 01993 778 281
E witney@connells.co.uk

13 Corn Street
 WITNEY OX28 6DB

EPC Rating: Awaited

view this property online connells.co.uk/Property/ref-WNY304209



Tenure: Freehold



1. MONEY LAUNDERING REGULATIONS Intending purchasers will be asked to produce identification documentation at a later stage and we would ask for your co-operation in order that there will be no delay in agreeing the sale. 2. These particulars do not constitute part or all of an offer or contract. 3. The measurements indicated are supplied for guidance only and as such must be considered incorrect. Potential buyers are advised to recheck measurements before committing to any expense. 4. We have not tested any apparatus, equipment, fixtures, fittings or services and it is in the buyers interest to check the working condition of any appliances.

See all our properties at www.connells.co.uk | www.rightmove.co.uk | www.zoopla.co.uk

Property Ref: WNY304209 - 0004