



Connells

Meadow Way
Yarnton Kidlington



Property Description

Situated on Meadow Way in the popular village of Yarnton is this beautifully presented one-bedroom semi-detached home.

The accommodation on offer includes an entrance porch, sitting room, modern kitchen, bathroom, and a good-sized double bedroom. Externally there is two allocated parking spaces and well-established garden to the rear.

The property is well located to Oxford and the Oxford Parkway which provides train links to London.

Entrance Porch

Door to front

Sitting Room

13' x 11' 2" (3.96m x 3.40m)

Double glazed to side and door to garden

Kitchen

13' x 5' 4" (3.96m x 1.63m)

Double glazed window to side, base units, wall units, work surfaces, sink with drainer, plumbing for washing machine, electric oven and gas hob, also has an integrated dishwasher. 1 Years warranty left on new boiler installed 4 years ago

Bathroom

Double glazed window to side, WC, wash hand basin and bath with shower over.

Garden



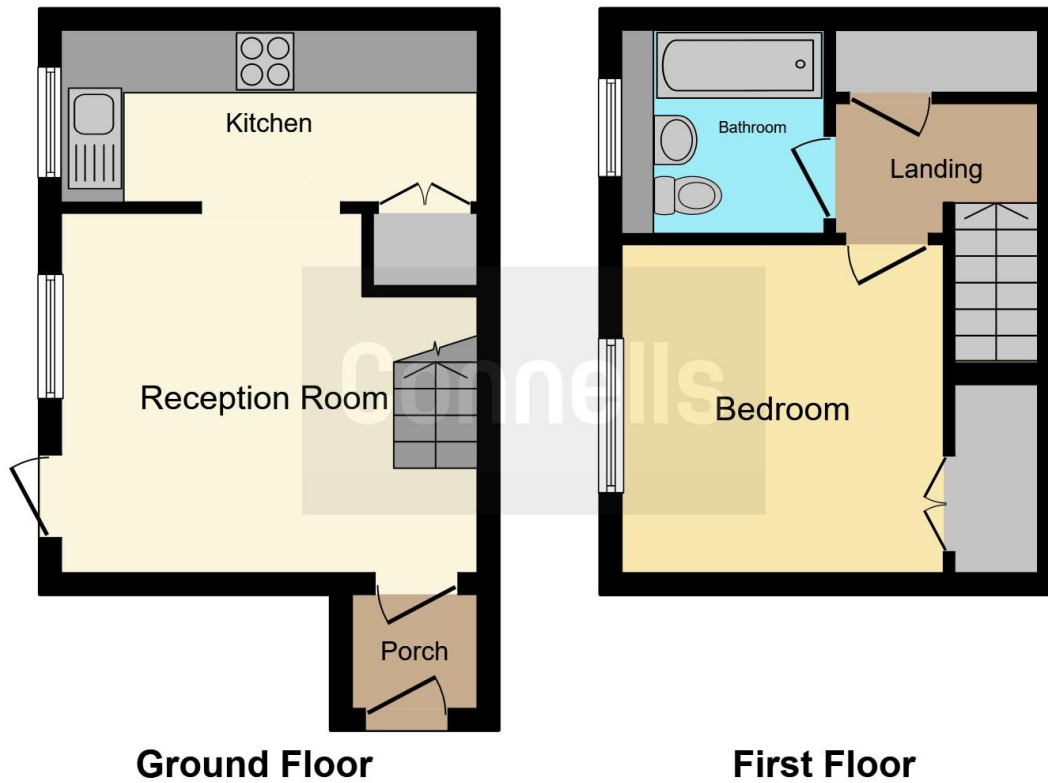

This floor plan is for illustrative purposes only. It is not drawn to scale. Any measurements, floor areas (including any total floor area), openings and orientation are approximate. No details are guaranteed, they cannot be relied upon for any purpose and they do not form part of any agreement. No liability is taken for any error, omission or misstatement. A party must rely upon its own inspection(s). Powered by www.focalagent.com

To view this property please contact Connells on

T 01993 778 281
E witney@connells.co.uk

13 Corn Street
 WITNEY OX28 6DB

EPC Rating: C

view this property online connells.co.uk/Property/WNY305410

Tenure: Freehold



1. MONEY LAUNDERING REGULATIONS Intending purchasers will be asked to produce identification documentation at a later stage and we would ask for your co-operation in order that there will be no delay in agreeing the sale. 2. These particulars do not constitute part or all of an offer or contract. 3. The measurements indicated are supplied for guidance only and as such must be considered incorrect. Potential buyers are advised to recheck measurements before committing to any expense. 4. We have not tested any apparatus, equipment, fixtures, fittings or services and it is in the buyers interest to check the working condition of any appliances.

Connells Residential is registered in England and Wales under company number 1489613, Registered Office is Cumbria House, 16-20 Hockliffe Street, Leighton Buzzard, Bedfordshire, LU7 1GN. VAT Registration Number is 500 2481 05.

See all our properties at www.connells.co.uk | www.rightmove.co.uk | www.zoopla.co.uk

Property Ref: WNY305410 - 0002