



Connells

Kysbie Close  
Abingdon



### Property Description

Three bedroom detached house in North Abingdon with driveway parking, garage and large rear garden.

Situated on the northern periphery of Abingdon, the property is only a short distance from a newly-opened supermarket, and just 350m from Tilsley Park, a very popular local amenity which boasts a gym and fitness centre, athletics track, floodlit football and hockey pitches, as well as a bar. There are also excellent primary and secondary schools nearby. The shops and services of Abingdon town centre are all within easy reach, and there are excellent transport links to Oxford which is 10.5km away. Didcot Parkway rail station, also only 14km away, offers regular fast connections to London Paddington (approx. 40mins).



## Room Measurements

### Ground Floor

#### Kitchen

9' 10" x 14' 9" ( 3.00m x 4.50m )

#### Living Room

14' 5" x 11' 6" ( 4.39m x 3.51m )

### First Floor

#### Bedroom One

9' 10" x 12' 9" ( 3.00m x 3.89m )

#### Bedroom Two

9' 2" x 8' 6" ( 2.79m x 2.59m )

#### Bedroom Three

6' 3" x 7' 6" ( 1.91m x 2.29m )

#### Bathroom

5' 7" x 8' 6" ( 1.70m x 2.59m )



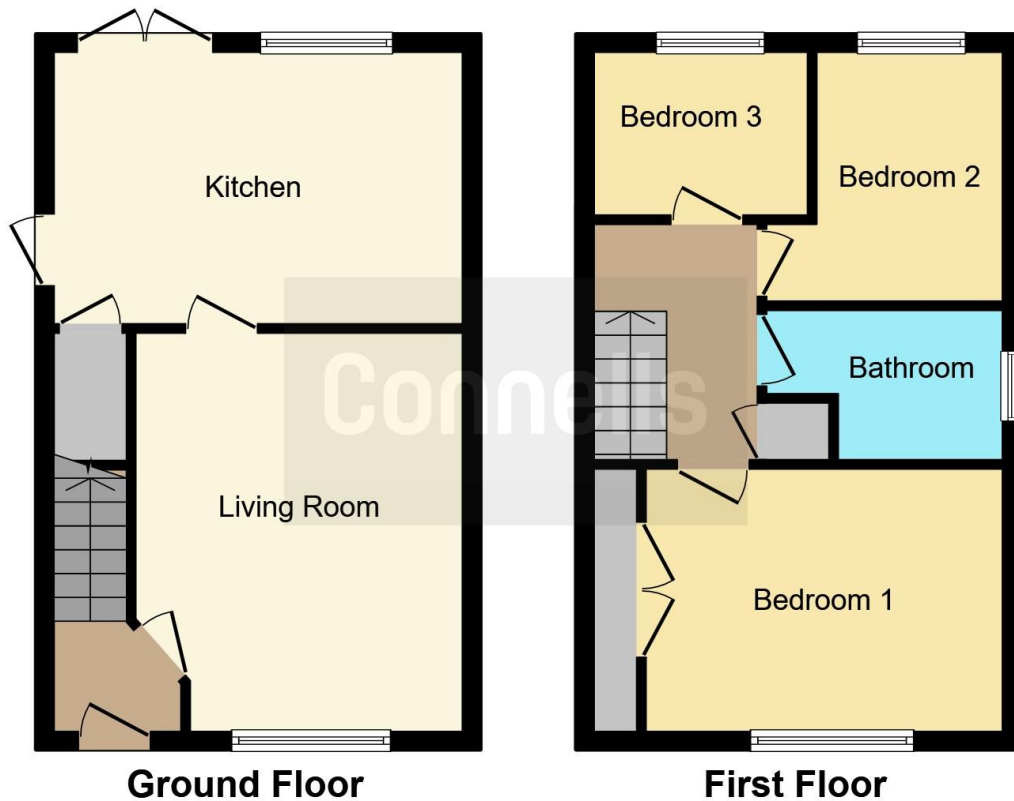

This floorplan is for illustrative purposes only and is not drawn to scale. Measurements, floor-areas, openings and orientations are approximate. They should not be relied upon for any purpose and do not form any part of an agreement. No liability is taken for any error or mis-statement. All parties must rely on their own inspections.

To view this property please contact Connells on

**T 01235 555611**  
**E [abingdon@connells.co.uk](mailto:abingdon@connells.co.uk)**

11 High Street  
 ABINGDON OX14 5BB

**EPC Rating: C**

**view this property online [connells.co.uk/Property/ABG304798](http://connells.co.uk/Property/ABG304798)**

Tenure: Freehold



1. MONEY LAUNDERING REGULATIONS Intending purchasers will be asked to produce identification documentation at a later stage and we would ask for your co-operation in order that there will be no delay in agreeing the sale. 2. These particulars do not constitute part or all of an offer or contract. 3. The measurements indicated are supplied for guidance only and as such must be considered incorrect. Potential buyers are advised to recheck measurements before committing to any expense. 4. We have not tested any apparatus, equipment, fixtures, fittings or services and it is in the buyers interest to check the working condition of any appliances.

Connells Residential is registered in England and Wales under company number 1489613, Registered Office is Cumbria House, 16-20 Hockliffe Street, Leighton Buzzard, Bedfordshire, LU7 1GN. VAT Registration Number is 500 2481 05.

**See all our properties at [www.connells.co.uk](http://www.connells.co.uk) | [www.rightmove.co.uk](http://www.rightmove.co.uk) | [www.zoopla.co.uk](http://www.zoopla.co.uk)**

Property Ref: ABG304798 - 0003