

for sale

£270,000 Freehold



## Honeysuckle Grove OXFORD OX4 7UL

Offered with No Onward Chain. This property has been recently modernised and offers spacious accommodation over two levels. Ideally situated for BMW and the Science Park. This would make an ideal home for a First Time Buyer.



Residential Sales & Lettings | Mortgage Services |  
Conveyancing | Surveyors | Land & New Homes

# Property Details

## Key Features

- No Onward Chain
- Well Presented Throughout
- Cul-De-Sac Location
- Ideal For First Time Buyers
- Easy Access to Ring Road, A34 and Motorways

## Measurements

**Lounge** 11' 10" Max x 16' 7" Max (3.61m Max x 5.05m Max)

**Kitchen** 7' 10" Max x 11' 9" Max (2.39m Max x 3.58m Max)

**Bedroom One** 9' 6" Max x 13' 5" Max (2.90m Max x 4.09m Max)

**Bedroom Two** 6' 9" Max x 10' 10" Max (2.06m Max x 3.30m Max)

**Bathroom** 8' Max x 4' 10" Max ( 2.44m Max x 1.47m Max )

## Location

Honeysuckle Grove is located in the popular Greater Leys area of Oxford. The Oxford Science Park, Kassam Stadium and BMW motor plant are all within easy reach and there is a regular bus service into the City Centre.

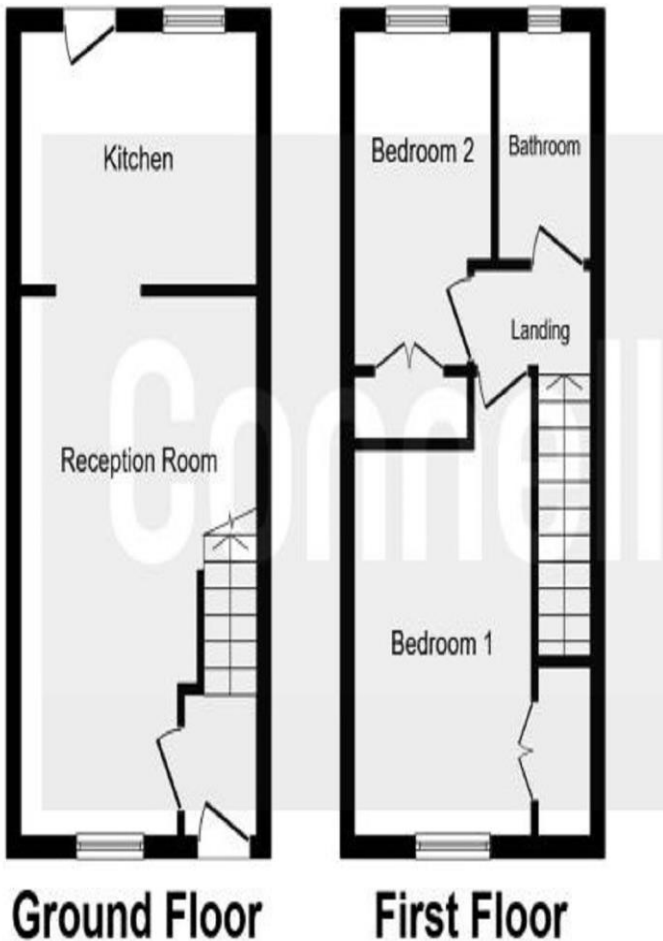

To view this property please contact Connells on

**T 01865 748 448**  
**E [cowley@connells.co.uk](mailto:cowley@connells.co.uk)**

60 Between Towns Road  
OXFORD OX4 3LR

**Tenure:** Freehold

**EPC Rating:** Awaiting

Property Ref: COW307772 - 0001

1. MONEY LAUNDERING REGULATIONS Intending purchasers will be asked to produce identification documentation at a later stage and we would ask for your co-operation in order that there will be no delay in agreeing the sale. 2. These particulars do not constitute part or all of an offer or contract. 3. The measurements indicated are supplied for guidance only and as such must be considered incorrect. Potential buyers are advised to recheck measurements before committing to any expense. 4. We have not tested any apparatus, equipment, fixtures, fittings or services and it is in the buyers interest to check the working condition of any appliances.