



Connells

Cherry Place
Haywards Heath

Cherry Place Haywards Heath RH16 4GY

for sale guide price
£425,000



Property Description

Guide price £425,000-£450,000

A well presented three bedroom townhouse with two bathrooms (one en suite) and a garage located in the highly sought after Bolnore Village, Haywards Heath.

This lovely property comprises of entrance hallway, kitchen/dining room, WC and integral garage to the ground floor. Upstairs is the living room (currently being used as a bedroom), third bedroom and family bathroom. On the second floor is another double bedroom and the main bedroom with en suite shower room. To the front is parking for one vehicle and at the rear is the garden which is laid to lawn with a patio area.

The property is conveniently situated close to the sought after Bolnore Village Primary School and local village shops whilst being approximately a 1 mile walk from Haywards Heath town centre and approximately 1.5 miles from Haywards Heath train station (14 minutes to Brighton and 45 minutes to London Victoria). The property also comes with a garage and allocated parking space.



Ground Floor

Entrance Hall

Cloakroom

Kitchen/Diner

15' 4" x 10' 4" (4.67m x 3.15m)

Garage (integral)

19' 3" x 8' 3" (5.87m x 2.51m)

First Floor

Landing/Living Room

15' 6" x 13' 8" (4.72m x 4.17m)

Bedroom 3

15' 6" x 9' (4.72m x 2.74m)

Bathroom

Second Floor

Bedroom 2

15' 6" x 11' 6" (4.72m x 3.51m)

Bedroom 1

15' 6" x 10' 4" (4.72m x 3.15m)

En-Suite Shower Room

Outside

Parking

Front Garden

Rear Garden







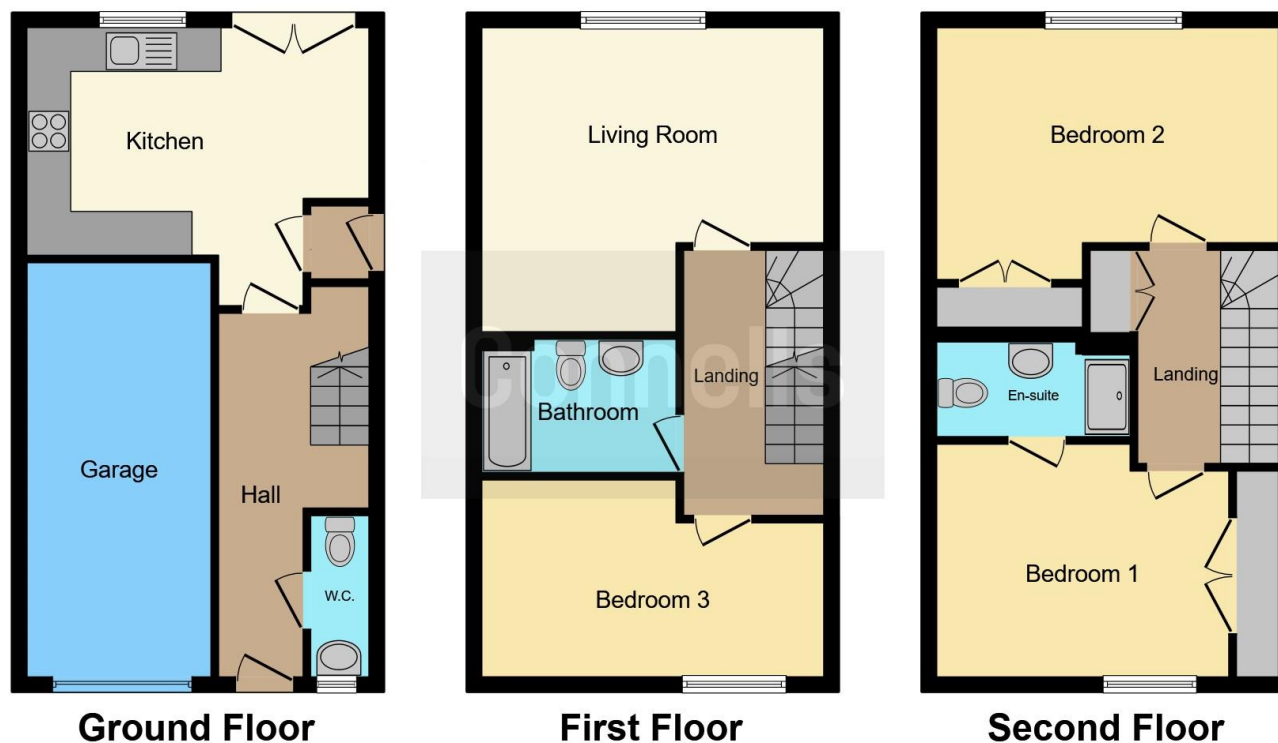

This floor plan is for illustrative purposes only. It is not drawn to scale. Any measurements, floor areas (including any total floor area), openings and orientation are approximate. No details are guaranteed, they cannot be relied upon for any purpose and they do not form part of any agreement. No liability is taken for any error, omission or misstatement. A party must rely upon its own inspection(s). Powered by www.focalagent.com

To view this property please contact Connells on

T 01444 441 441
E haywardsheath@connells.co.uk

135 South Road
 HAYWARDS HEATH RH16 4LY

EPC Rating: C

Tenure: Freehold

view this property online connells.co.uk/Property/HAY405220



1. MONEY LAUNDERING REGULATIONS Intending purchasers will be asked to produce identification documentation at a later stage and we would ask for your co-operation in order that there will be no delay in agreeing the sale. 2. These particulars do not constitute part or all of an offer or contract. 3. The measurements indicated are supplied for guidance only and as such must be considered incorrect. Potential buyers are advised to recheck measurements before committing to any expense. 4. We have not tested any apparatus, equipment, fixtures, fittings or services and it is in the buyers interest to check the working condition of any appliances.

Connells Residential is registered in England and Wales under company number 1489613, Registered Office is Cumbria House, 16-20 Hockliffe Street, Leighton Buzzard, Bedfordshire, LU7 1GN. VAT Registration Number is 500 2481 05.

See all our properties at www.connells.co.uk | www.rightmove.co.uk | www.zoopla.co.uk

Property Ref: HAY405220 - 0019