





Property Description

A modern and bright two bedroom coach house located in the popular Forge Wood development.

Being a coach house, the living accommodation is upstairs, and consists of a spacious living room running front to back, two good sized bedrooms, a bathroom and lastly the kitchen with integrated appliances.

Downstairs where the car port used to be located, is a secure garage with roller door. The seller also added an internal door so the garage can now be accessed from the entry hall. A private rear garden (rare for coach houses) is accessed via the garage.

Forge Wood is a new neighbourhood built on the North-East outskirts of Crawley and is within easy access to the M23, highly regarded schools and walking distance to Heathy Farm Pub and Restaurant. Bus routes serve Crawley Town Centre and Gatwick Airport.



Inside

Lounge

19' 5" x 10' 3" (5.92m x 3.12m)

Kitchen

10' 3" x 9' 3" (3.12m x 2.82m)

Bedroom One

11' 5" x 9' 7" (3.48m x 2.92m)

Bedroom Two

12' 3" x 9' 8" (3.73m x 2.95m)

Bathroom



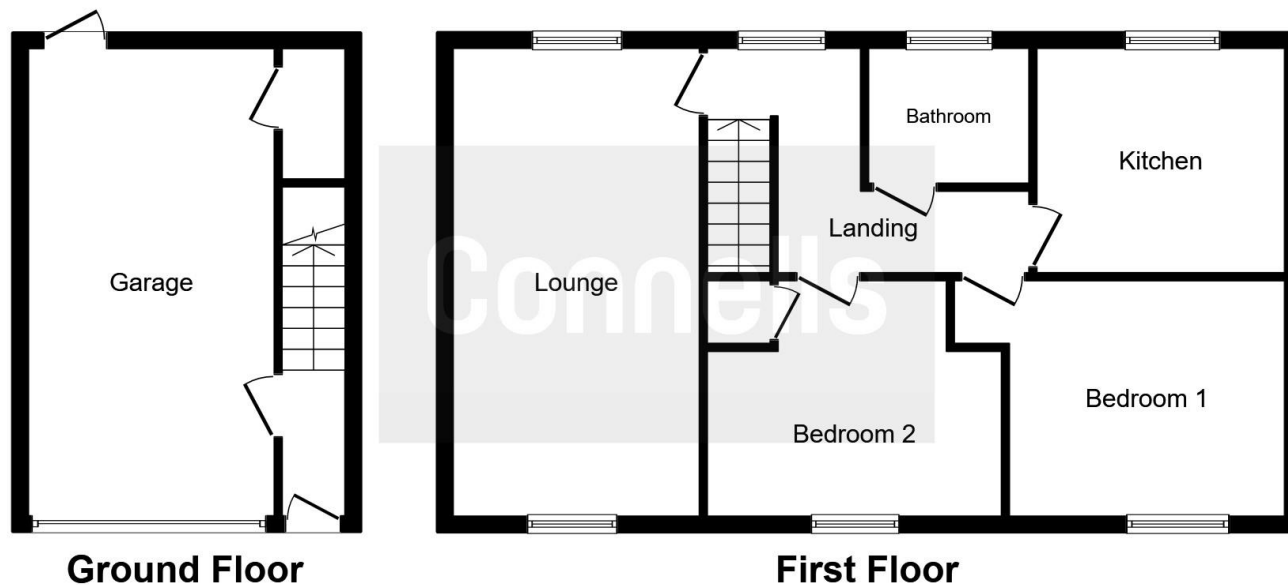

This floor plan is for illustrative purposes only. It is not drawn to scale. Any measurements, floor areas (including any total floor area), openings and orientation are approximate. No details are guaranteed, they cannot be relied upon for any purpose and they do not form part of any agreement. No liability is taken for any error, omission or misstatement. A party must rely upon its own inspection(s).
Plan produced for Connells. Powered by www.focalagent.com

To view this property please contact Connells on

T 01293 515 444
E crawley@connells.co.uk

57 High Street
CRAWLEY RH10 1BQ

EPC Rating: B

view this property online connells.co.uk/Property/ref-CWY407484

Tenure: Freehold



1. MONEY LAUNDERING REGULATIONS Intending purchasers will be asked to produce identification documentation at a later stage and we would ask for your co-operation in order that there will be no delay in agreeing the sale. 2. These particulars do not constitute part or all of an offer or contract. 3. The measurements indicated are supplied for guidance only and as such must be considered incorrect. Potential buyers are advised to recheck measurements before committing to any expense. 4. We have not tested any apparatus, equipment, fixtures, fittings or services and it is in the buyers interest to check the working condition of any appliances.

See all our properties at www.connells.co.uk | www.rightmove.co.uk | www.zoopla.co.uk

Property Ref: CWY407484 - 0003