



Connells

Wavertree Court Massetts Road
Horley

Wavertree Court Massetts Road Horley RH6 7BP

for sale guide price
£30,000



Property Description

Enjoy a stress-free lifestyle with this spacious one-bedroom retirement apartment, situated in the well-regarded Wavertree Court development in Horley.

Designed for comfort and peace of mind, the property offers a generous double bedroom with built-in wardrobes, a bright lounge, separate fitted kitchen, and a bathroom featuring both a bath and accessible wet room shower.

Wavertree Court is tailored for independent living with support when needed, offering 24-hour warden assistance, emergency pull cords in every room, a welcoming communal lounge, laundry room, mobility scooter storage and residents' parking. An on-site restaurant provides daily subsidised meals, adding ease and convenience to everyday living. Ideally located close to Horley town centre and excellent bus links.

Auctioneer's Comments

This property is offered through Modern Method of Auction. Should you view, offer or bid your data will be shared with the Auctioneer, iamsold Limited. This method requires both parties to complete the transaction within 56 days, allowing buyers to proceed with mortgage finance (subject to lending criteria, affordability and survey).

The buyer is required to sign a reservation agreement and make payment of a non-

refundable Reservation Fee of 4.5% of the purchase price including VAT, subject to a minimum of £6600.00 including VAT. This fee is paid in addition to purchase price and will be considered as part of the chargeable consideration for the property in the calculation for stamp duty liability. Buyers will be required to complete an identification process with iamsold and provide proof of how the purchase would be funded.

The property has a Buyer Information Pack containing documents about the property. The documents may not tell you everything you need to know, so you must complete your own due diligence before bidding. A sample of the Reservation Agreement and terms and conditions are contained within this pack. The buyer will also make payment of no more than £349 inc. VAT towards the preparation cost of the pack. Please confirm exact costs with the auctioneer.

The estate agent and auctioneer may recommend the services of other providers to you, in which they will be paid for the referral. These services are optional, and you will be advised of any payment, in writing before any services are accepted. Listing is subject to a start price and undisclosed reserve price that can change.

Entrance Hall

Lounge

24' 9" x 10' 8" max (7.54m x 3.25m max)

Kitchen

9' 7" max x 7' 7" max (2.92m max x 2.31m

max)

Bedroom One

17' 10" max x 10' 1" max (5.44m max x
3.07m max)

Bathroom





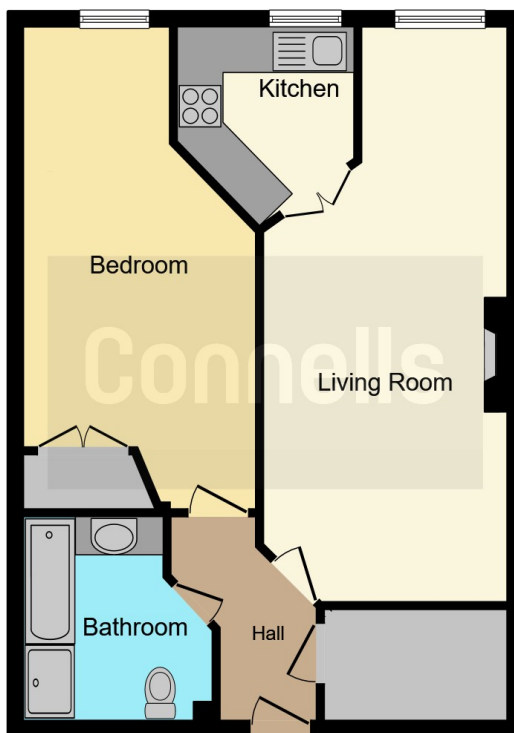

This floor plan is for illustrative purposes only. It is not drawn to scale. Any measurements, floor areas (including any total floor area), openings and orientation are approximate. No details are guaranteed, they cannot be relied upon for any purpose and they do not form part of any agreement. No liability is taken for any error, omission or misstatement. A party must rely upon its own inspection(s). Powered by www.focalagent.com

To view this property please contact Connells on

T 01293 785 346
E horley@connells.co.uk

30 High Street
 HORLEY RH6 7BB

EPC Rating: B

Council Tax
 Band: C

Service Charge:
 10000.00

Ground Rent:
 405.00

Tenure: Leasehold

view this property online connells.co.uk/Property/HLY404764

This is a Leasehold property with details as follows; Term of Lease 125 years from 01 Sep 2006. Should you require further information please contact the branch. Please Note additional fees could be incurred for items such as



1. MONEY LAUNDERING REGULATIONS Intending purchasers will be asked to produce identification documentation at a later stage and we would ask for your co-operation in order that there will be no delay in agreeing the sale. 2. These particulars do not constitute part or all of an offer or contract. 3. The measurements indicated are supplied for guidance only and as such must be considered incorrect. Potential buyers are advised to recheck measurements before committing to any expense. 4. We have not tested any apparatus, equipment, fixtures, fittings or services and it is in the buyers interest to check the working condition of any appliances.

Connells Residential is registered in England and Wales under company number 1489613, Registered Office is Cumbria House, 16-20 Hockliffe Street, Leighton Buzzard, Bedfordshire, LU7 1GN. VAT Registration Number is 500 2481 05.

See all our properties at www.connells.co.uk | www.rightmove.co.uk | www.zoopla.co.uk

Property Ref: HLY404764 - 0004