



Connells

Shangrila West Caravan Park Kingsmans Farm Road
Hullbridge Hockley



Property Description

GUIDE PRICE £100,00 - £125,000 ONE DOUBLE BEDROOM PARKHOME, benefiting from, fitted kitchen/dining room, feature lounge, fitted shower room, double bedroom, outside wrap around gardens, direct access driveway for two vehicles.

Entrance

Access via double glazed front door. Radiator.

Lounge

16' 3" x 9' 6" (4.95m x 2.90m)
Double glazed window to front. Double glazed French doors to side. Radiator.

Kitchen / Diner

13' 5" x 9' 9" (4.09m x 2.97m)
Two double glazed windows to sides. Kitchen is fitted with a range of wall mounted and base units, finished with worksurfaces, inset with sink/drain unit. Space and plumbing for appliances. Radiator.

Bedroom

10' 5" x 9' 6" (3.17m x 2.90m)
Double glazed window to side.. Fitted wardrobe. Radiator.

Shower Room

Double glazed window to side. Three piece suite comprising of shower cubicle, wash hand basin and low level flush W.C.

Outside

The property sits on its own wrap around garden plot. There is off street parking.







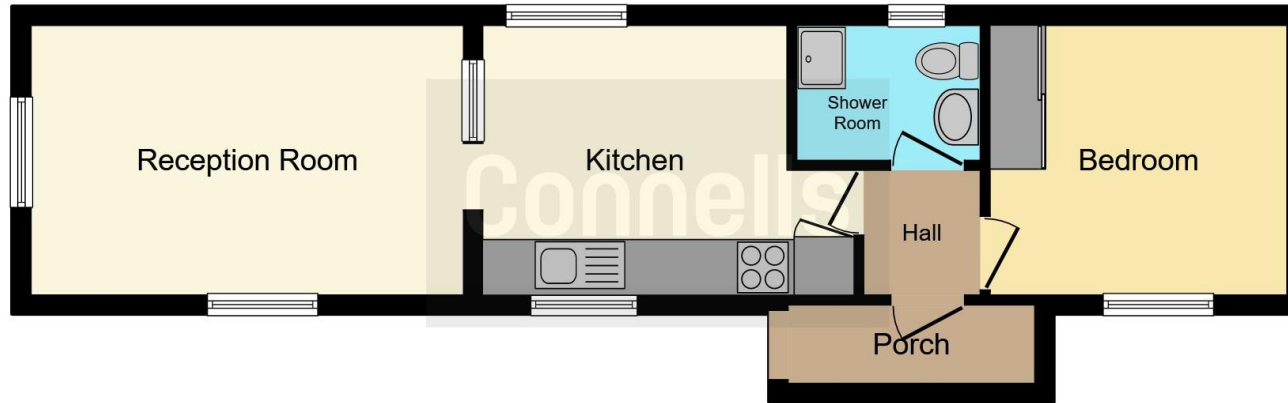

This floor plan is for illustrative purposes only. It is not drawn to scale. Any measurements, floor areas (including any total floor area), openings and orientation are approximate. No details are guaranteed, they cannot be relied upon for any purpose and they do not form part of any agreement. No liability is taken for any error, omission or misstatement. A party must rely upon its own inspection(s). Powered by www.focalagent.com

To view this property please contact Connells on

T 01268 777 767
E rayleigh@connells.co.uk

113-115 High Street
RAYLEIGH SS6 7QA

EPC Rating: Exempt

Tenure:

view this property online connells.co.uk/Property/RAY308382

We are currently awaiting Tenure details. For further information please contact the branch. Please note additional fees could be incurred for items such as leasehold packs.



1. MONEY LAUNDERING REGULATIONS Intending purchasers will be asked to produce identification documentation at a later stage and we would ask for your co-operation in order that there will be no delay in agreeing the sale. 2. These particulars do not constitute part or all of an offer or contract. 3. The measurements indicated are supplied for guidance only and as such must be considered incorrect. Potential buyers are advised to recheck measurements before committing to any expense. 4. We have not tested any apparatus, equipment, fixtures, fittings or services and it is in the buyers interest to check the working condition of any appliances.

Connells Residential is registered in England and Wales under company number 1489613, Registered Office is Cumbria House, 16-20 Hockliffe Street, Leighton Buzzard, Bedfordshire, LU7 1GN. VAT Registration Number is 500 2481 05.

See all our properties at www.connells.co.uk | www.rightmove.co.uk | www.zoopla.co.uk

Property Ref: RAY308382 - 0005