



Connells

Earl Mountbatten Drive
Billericay

Earl Mountbatten Drive
Billericay CM12 0ED

for sale guide price
£360,000



Property Description

Newly renovated and well presented two bedroom home sold with the added advantage of no onward chain.

The ground floor offers a good size lounge/diner which leads to the modern kitchen/breakfast room, there is a pleasant rear garden which leads to the garage and parking space at the rear of the property. The first floor benefits from two bedrooms, the master bedroom has built in wardrobes. there is also a brand new fitted stylish family bathroom.

This is an ideal property for first time buyers or investors, perfect for commuters as it is within easy reach of the town centre and just a short walk to Billericay station, offering direct links into London Liverpool Street. The property also benefits from being close to highly regarded local schools.



Lounge/Diner

13' 5" x 12' 7" (4.09m x 3.84m)

Kitchen

8' 5" x 12' 8" (2.57m x 3.86m)

Bedroom One

9' 11" x 12' 7" (3.02m x 3.84m)

Bedroom Two

12' x 6' 5" (3.66m x 1.96m)







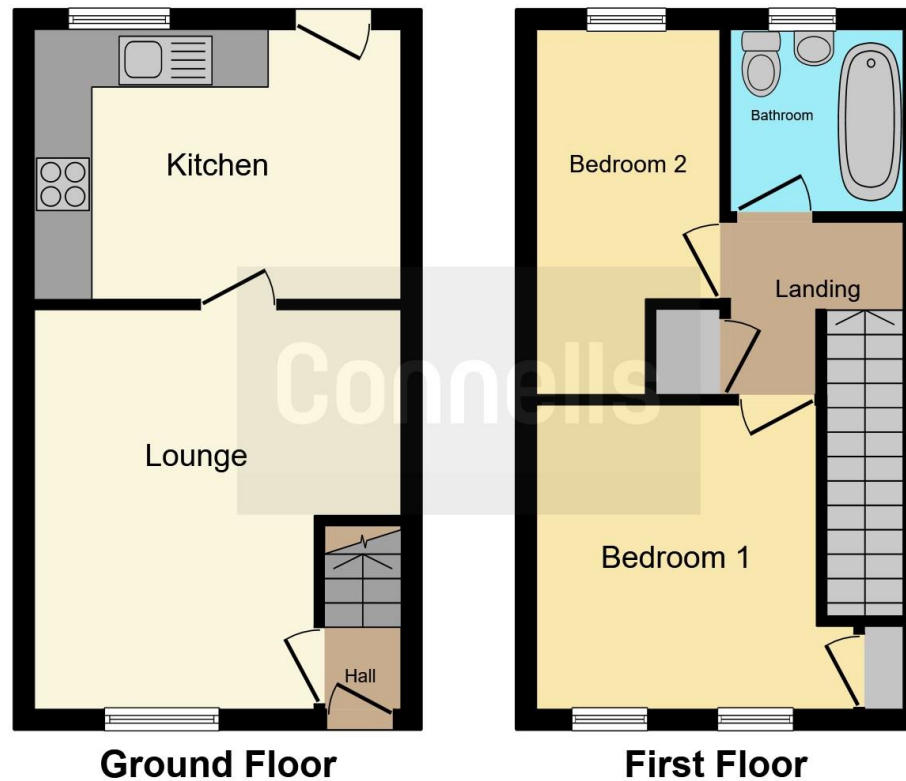

This floor plan is for illustrative purposes only. It is not drawn to scale. Any measurements, floor areas (including any total floor area), openings and orientation are approximate. No details are guaranteed, they cannot be relied upon for any purpose and they do not form part of any agreement. No liability is taken for any error, omission or misstatement. A party must rely upon its own inspection(s). Powered by www.focalagent.com

To view this property please contact Connells on

T 01277 655 555
E billericay@connells.co.uk

96 High Street
 BILLERICAY CM12 9BT

EPC Rating: C Council Tax
 Band: C

Tenure: Freehold

view this property online connells.co.uk/Property/BCY307827



1. MONEY LAUNDERING REGULATIONS Intending purchasers will be asked to produce identification documentation at a later stage and we would ask for your co-operation in order that there will be no delay in agreeing the sale. 2. These particulars do not constitute part or all of an offer or contract. 3. The measurements indicated are supplied for guidance only and as such must be considered incorrect. Potential buyers are advised to recheck measurements before committing to any expense. 4. We have not tested any apparatus, equipment, fixtures, fittings or services and it is in the buyers interest to check the working condition of any appliances.

Connells Residential is registered in England and Wales under company number 1489613, Registered Office is Cumbria House, 16-20 Hockliffe Street, Leighton Buzzard, Bedfordshire, LU7 1GN. VAT Registration Number is 500 2481 05.

See all our properties at www.connells.co.uk | www.rightmove.co.uk | www.zoopla.co.uk

Property Ref: BCY307827 - 0002