

for sale

£220,000



Kings Crescent HEREFORD HR1 1GY

A two bedroom end-terrace property with a two car driveway and low maintenance rear garden. Offered for sale with no onward chain and occupying a convenient location one mile from the City Centre and a short walk from Hereford Railway Station.

Kings Crescent HEREFORD HR1 1GY

Entrance Porch

Ceiling light point and door into the kitchen.

Kitchen

11' 11" x 12' 8" (3.63m x 3.86m)

Wall and base units, roll top work surfaces, one bowl sink and drainer, tiled splash backs, integrated oven, gas hob and cooker hood, plumbing for washing machine, space for tumble dryer, space for fridge freezer, radiator, double glazed window to front and ceiling light point.

Lounge

13' 10" max x 11' 1" (4.22m max x 3.38m)

Ceiling light point, radiator, sliding door to patio and stairs to first floor.

Landing

Ceiling light point, loft hatch and doors to the following.

Bedroom One

12' 9" x 12' (3.89m x 3.66m)

Double glazed window to front elevation, ceiling light point and radiator.

En Suite

Walk in shower, wash hand basin with vanity, ceiling light point and extractor fan.



Bedroom Two

9' 9" x 6' 1" (2.97m x 1.85m)

Double glazed window to rear elevation, ceiling light point, storage cupboard and radiator.

Bathroom

Bath, WC, wash hand basin, tiled splashbacks, double glazed obscure window to rear elevation, ceiling light point, and radiator.

Garden

A beautifully laid out garden with a small, well-manicured lawn alongside a sheltered patio area and a second patio space under a pergola. Further benefitting from outdoor lighting and a side gate giving access directly to the driveway.



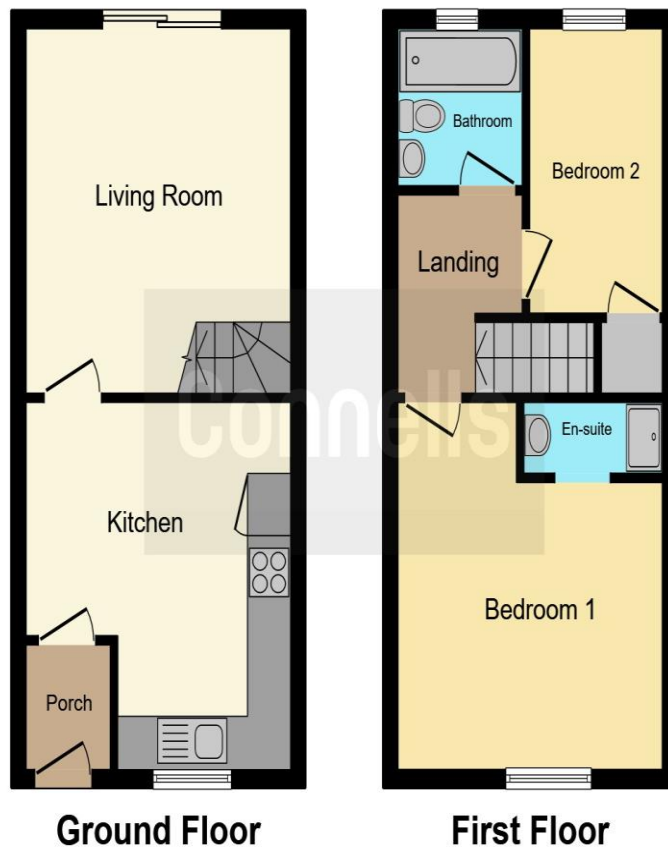

This floor plan is for illustrative purposes only. It is not drawn to scale. Any measurements, floor areas (including any total floor area), openings and orientation are approximate. No details are guaranteed, they cannot be relied upon for any purpose and they do not form part of any agreement. No liability is taken for any error, omission or misstatement. A party must rely upon its own inspection(s). Powered by www.focalagent.com

To view this property please contact Connells on

T 01432 267 511
E hereford@connells.co.uk

23 King Street
 HEREFORD HR4 9BX

Property Ref: HER315401 - 0003

Tenure: Freehold

EPC Rating: D

view this property online connells.co.uk/Property/HER315401



1. MONEY LAUNDERING REGULATIONS Intending purchasers will be asked to produce identification documentation at a later stage and we would ask for your co-operation in order that there will be no delay in agreeing the sale. 2. These particulars do not constitute part or all of an offer or contract. 3. The measurements indicated are supplied for guidance only and as such must be considered incorrect. Potential buyers are advised to recheck measurements before committing to any expense. 4. We have not tested any apparatus, equipment, fixtures, fittings or services and it is in the buyers interest to check the working condition of any appliances.

Connells Residential is registered in England and Wales under company number 1489613, Registered Office is Cumbria House, 16-20 Hockliffe Street, Leighton Buzzard, Bedfordshire, LU7 1GN. VAT Registration Number is 500 2481 05.

see all our properties at www.connells.co.uk | www.rightmove.co.uk | www.zoopla.co.uk