

For Sale

£160,000 Leasehold



Wheelwright Place Mile End Colchester CO4 5ZF

A stunning property situated in a sought-after area that would make the ideal home for any young professional or first-time buyer.



Residential Sales & Lettings | Mortgage Services |
Conveyancing | Surveyors | Land & New Homes

Property Details

Entrance Hall

Lounge / Kitchen 15' 5" x 11' 6" (4.70m x 3.51m)

Bathroom 8' 2" x 8' 2" (2.49m x 2.49m)

Bedroom 15' 5" x 8' 2" (4.70m x 2.49m)

Carport

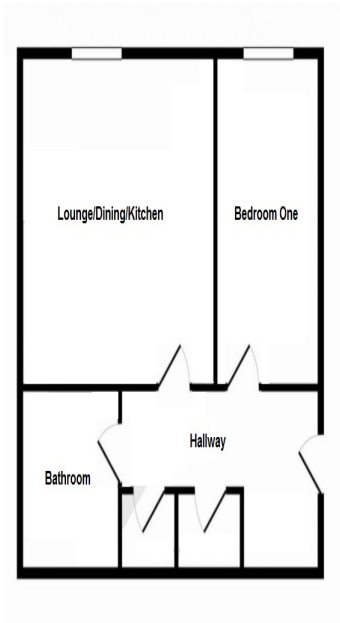

To view this property please contact Connells on

T 01206 547 431
E colchester@connells.co.uk

3a High Street
COLCHESTER CO1 1DA

Tenure: Leasehold

EPC Rating: C

Property Ref: CCH307881 - 0002

This is a Leasehold property with details as follows; Term of Lease 125 years from 01 Jul 2006. Should you require further information please contact the branch. Please Note additional fees could be incurred for these services as Leasehold sales

1. MONEY LAUNDERING REGULATIONS Intending purchasers will be asked to produce identification documentation at a later stage and we would ask for your co-operation in order that there will be no delay in agreeing the sale. 2. These particulars do not constitute part or all of an offer or contract. 3. The measurements indicated are supplied for guidance only and as such must be considered incorrect. Potential buyers are advised to recheck measurements before committing to any expense. 4. We have not tested any apparatus, equipment, fixtures, fittings or services and it is in the buyers interest to check the working condition of any appliances.

Connells Residential is registered in England and Wales under company number 1489613, Registered Office is Cumbria House, 16-20 Hockliffe Street, Leighton Buzzard, Bedfordshire, LU7 1GN. VAT Registration Number is 500 2481 05.

see all our properties at www.connells.co.uk | www.rightmove.co.uk | www.zoopla.co.uk