

for sale

guide price **£300,000**



## Glebe Avenue Braintree CM7 5RA

**\*\*Guide Price £300,000-£325,000\*\***

Brand new to the market is this charming three bedroom semi-detached house which perfectly balances comfort and convenience.





# Glebe Avenue Braintree CM7 5RA

## Entrance Hall

Stairs leading to the first floor, radiator, storage cupboard.

## Living Room

12' 3" max x 11' 6" ( 3.73m max x 3.51m )

Double glazed window to the front aspect, radiator, electric fireplace.

## Kitchen/Dining Room

18' 6" x 9' 7" ( 5.64m x 2.92m )

Inset stainless steel sink unit one and a half bowl with left hand drainer with cupboard under, working surfaces to the side with a matching range of wall mounted units with further drawers and cupboards's under, built in oven, hob and extractor fan, space for washing machine, dishwasher and fridge-freezer, radiator, double

glazed window to the rear aspect, double glazed patio doors to the rear aspect.

## First Floor Landing

Loft access, double glazed window to the side aspect.

## Bedroom One

12' 4" x 11' 6" ( 3.76m x 3.51m )

Double glazed window to the front aspect, radiator, two storage cupboards.

## Bedroom Two

12' 4" x 9' 3" ( 3.76m x 2.82m )

Double glazed window to the rear aspect, radiator., storage cupboard.





### **Bedroom Three**

8' 7" x 8' ( 2.62m x 2.44m )

Double glazed window to the front aspect, radiator, storage cupboard.

### **Family Bathroom**

Low level WC, pedestal hand wash basin, paneled bath with shower unit above, radiator, double glazed window to the side and rear aspect.

### **Rear Garden**

Commences with a decked area with the remainder of the garden laid to lawn, two brick built sheds, shed to remain, side access.



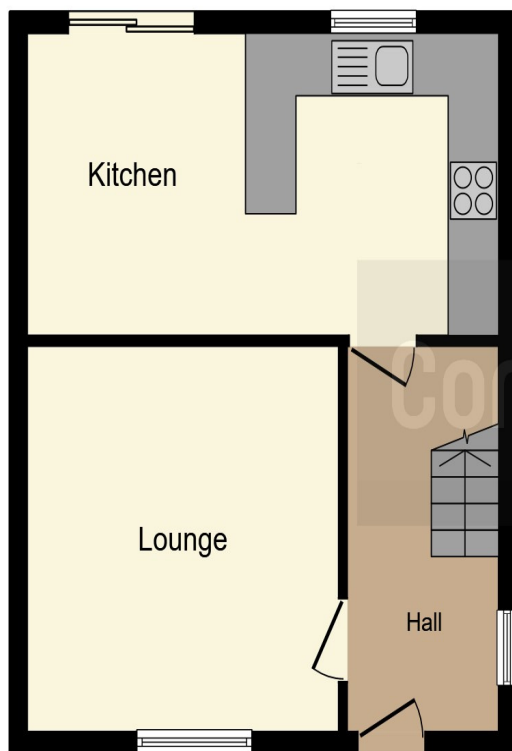

**Ground Floor**

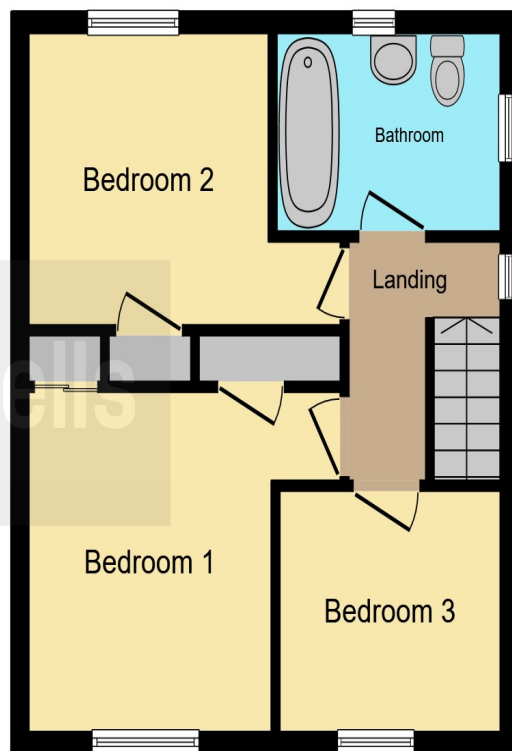

**First Floor**

This floor plan is for illustrative purposes only. It is not drawn to scale. Any measurements, floor areas (including any total floor area), openings and orientation are approximate. No details are guaranteed, they cannot be relied upon for any purpose and they do not form part of any agreement. No liability is taken for any error, omission or misstatement. A party must rely upon its own inspection(s). Powered by [www.focalagent.com](http://www.focalagent.com)

To view this property please contact Connells on

**T 01376 552 222**  
**E [braintree@connells.co.uk](mailto:braintree@connells.co.uk)**

17 Great Square  
 BRAINTREE CM7 1TX

Property Ref: BRT308159 - 0009

**Tenure:** Freehold

**EPC Rating:** D

**view this property online** [connells.co.uk/Property/BRT308159](http://connells.co.uk/Property/BRT308159)



1. MONEY LAUNDERING REGULATIONS Intending purchasers will be asked to produce identification documentation at a later stage and we would ask for your co-operation in order that there will be no delay in agreeing the sale. 2. These particulars do not constitute part or all of an offer or contract. 3. The measurements indicated are supplied for guidance only and as such must be considered incorrect. Potential buyers are advised to recheck measurements before committing to any expense. 4. We have not tested any apparatus, equipment, fixtures, fittings or services and it is in the buyers interest to check the working condition of any appliances.

Connells Residential is registered in England and Wales under company number 1489613, Registered Office is Cumbria House, 16-20 Hockliffe Street, Leighton Buzzard, Bedfordshire, LU7 1GN. VAT Registration Number is 500 2481 05.

see all our properties at [www.connells.co.uk](http://www.connells.co.uk) | [www.rightmove.co.uk](http://www.rightmove.co.uk) | [www.zoopla.co.uk](http://www.zoopla.co.uk)