

for sale

£260,000



## Derriads Green Chippenham SN14 0QR

Mid Terraced Family Home presented in good order throughout with Lounge, Kitchen/Diner, Two Double Bedrooms plus a Loft Room and Shower Room. Fully enclosed garden to the rear with a good size brick built shed/store.



# Derriads Green Chippenham SN14 0QR

## Description

Mature mid terraced family home presented in good order throughout and situated in a convenient location for all local amenities and within easy reach of Chippenham Town Centre where you will find a range of shops, bars and restaurants plus a mainline railway station providing access to Bath, Bristol and London. There are also great road links via junction 17 of the M4 motorway.

The property comprises Hallway, Lounge and Kitchen/Diner to the Ground Floor with two bedrooms and bathroom to the First Floor and a great size Loft Room to the Second Floor.





## Ground Floor

### **Entrance Hall**

Entrance door to front. Stairs to First Floor.

### **Lounge**

14' 1" x 12' 4" ( 4.29m x 3.76m )

Window to front. Understairs storage cupboard. Feature fireplace. Door to Kitchen.

### **Kitchen/Diner**

17' 4" max x 10' 9" max ( 5.28m max x 3.28m max )

Fitted with a matching range of base and wall units with complementary work surfaces over with inset sink and drainer. Plumbing for washing machine. Range style cooker. Appliance space. Door and window to rear.

## First Floor

### **Landing**

Stairs from Ground Floor. Doors to Bedrooms One and Two and Bathroom.

### **Bedroom One**

14' x 10' 5" ( 4.27m x 3.17m )

Window to front. Radiator.

### **Bedroom Two**

10' 4" x 9' 6" ( 3.15m x 2.90m )

Window to rear. Radiator.

## Second Floor

### **Loft Room**

Stairs from First Floor. Two velux style windows. Radiator.

### **Shower Room**

Suite comprising low level WC, wash hand basin and shower cubicle. Window to rear.

## Outside

### **Rear Garden**

Fully enclosed with lawn and patio areas. Large brick built store/shed.



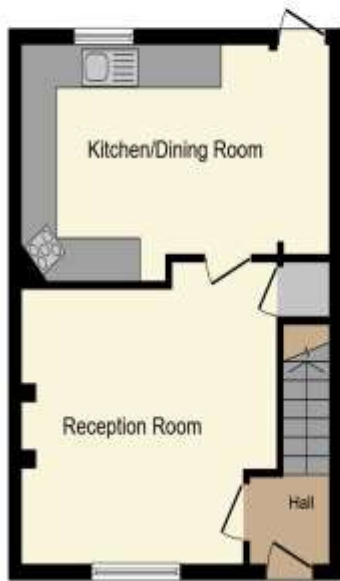

**Ground Floor**

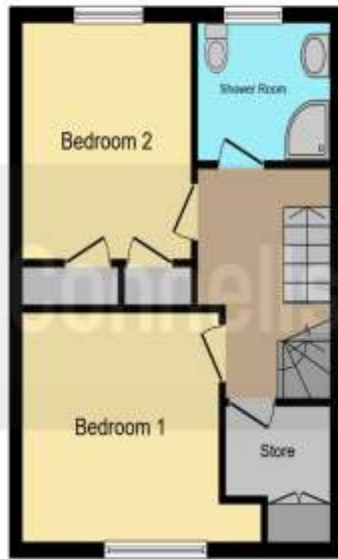

**First Floor**



**Second Floor**

This floor plan is for illustrative purposes only. It is not drawn to scale. Any measurements, floor areas (including any total floor area), openings and orientation are approximate. No details are guaranteed, they cannot be relied upon for any purpose and they do not form part of any agreement. No liability is taken for any error, omission or misstatement. A party must rely upon its own inspection(s). Powered by [www.focalagent.com](http://www.focalagent.com)

To view this property please contact Connells on

**T 01249 652 476**  
**E [chippenham@connells.co.uk](mailto:chippenham@connells.co.uk)**

59 Market Place  
 CHIPPENHAM SN15 3HL

Property Ref: CHM306200 - 0002

**Tenure:** Freehold

**EPC Rating:** E

**view this property online** [connells.co.uk/Property/CHM306200](http://connells.co.uk/Property/CHM306200)



1. MONEY LAUNDERING REGULATIONS Intending purchasers will be asked to produce identification documentation at a later stage and we would ask for your co-operation in order that there will be no delay in agreeing the sale. 2. These particulars do not constitute part or all of an offer or contract. 3. The measurements indicated are supplied for guidance only and as such must be considered incorrect. Potential buyers are advised to recheck measurements before committing to any expense. 4. We have not tested any apparatus, equipment, fixtures, fittings or services and it is in the buyers interest to check the working condition of any appliances.

Connells Residential is registered in England and Wales under company number 1489613, Registered Office is Cumbria House, 16-20 Hockliffe Street, Leighton Buzzard, Bedfordshire, LU7 1GN. VAT Registration Number is 500 2481 05.

see all our properties at [www.connells.co.uk](http://www.connells.co.uk) | [www.rightmove.co.uk](http://www.rightmove.co.uk) | [www.zoopla.co.uk](http://www.zoopla.co.uk)