



Connells

Bessborough Road
Harrow



Property Description

Connells are pleased to offer to the market this well-presented one bedroom ground floor flat.

This larger than usual flat offers naturally bright spacious reception room with modern décor and an eat-in kitchen/diner with access to lush communal gardens.

This spacious flat is situated on the lower slopes of Harrow on the Hill just a few minutes' walk from Harrow's Town Centre with its multiple shopping facilities and amenities as well as the Metropolitan Line/Chiltern line station which is perfect for commuters.

This would make an ideal property for first time buyers or investors.

Viewings are highly recommended.

Entrance Hall

Living Room

16' x 12' 7" (4.88m x 3.84m)

Kitchen

11' 5" x 9' 8" (3.48m x 2.95m)

Bedroom

11' 4" x 14' 8" (3.45m x 4.47m)

Bathroom





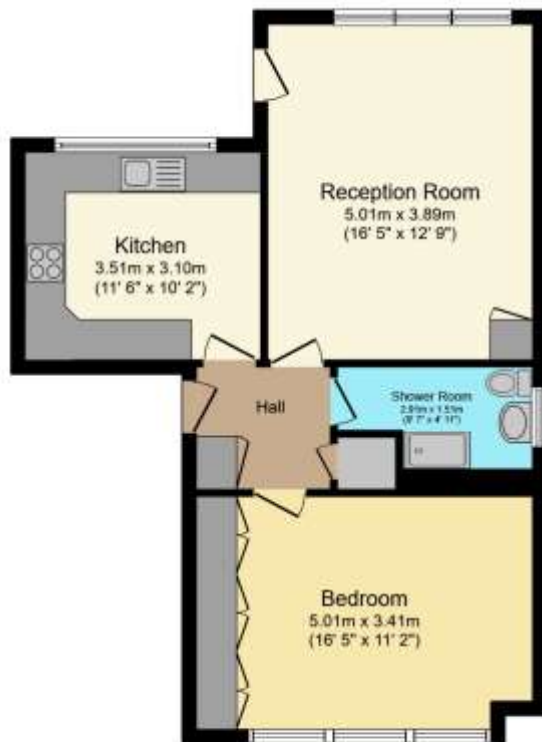

Total floor area 58.3 m² (628 sq.ft.) approx

This floor plan is for illustrative purposes only. It is not drawn to scale. Any measurements, floor areas (including any total floor area), openings and orientation are approximate. No details are guaranteed, they cannot be relied upon for any purpose and they do not form part of any agreement. No liability is taken for any error, omission or misstatement. A party must rely upon its own inspection(s). Powered by www.propertybox.io

Connells



To view this property please contact Connells on

T 020 8427 4321
E harrow@connells.co.uk

182 Station Road
 HARROW HA1 2RH

EPC Rating: D Council Tax
 Band: C

Service Charge:
 1800.00

Ground Rent:
 Ask Agent

Tenure: Leasehold

view this property online connells.co.uk/Property/HRW312425

This is a Leasehold property with details as follows; Term of Lease 999 years from 24 Jun 1962. Should you require further information please contact the branch. Please Note additional fees could be incurred for items such as Leasehold packs.



1. MONEY LAUNDERING REGULATIONS Intending purchasers will be asked to produce identification documentation at a later stage and we would ask for your co-operation in order that there will be no delay in agreeing the sale. 2. These particulars do not constitute part or all of an offer or contract. 3. The measurements indicated are supplied for guidance only and as such must be considered incorrect. Potential buyers are advised to recheck measurements before committing to any expense. 4. We have not tested any apparatus, equipment, fixtures, fittings or services and it is in the buyers interest to check the working condition of any appliances.

Connells Residential is registered in England and Wales under company number 1489613, Registered Office is Cumbria House, 16-20 Hockliffe Street, Leighton Buzzard, Bedfordshire, LU7 1GN. VAT Registration Number is 500 2481 05.

See all our properties at www.connells.co.uk | www.rightmove.co.uk | www.zoopla.co.uk

Property Ref: HRW312425 - 0004