



Connells

Symons Close
Tidworth



Property Description

This DECEPTIVE three storey town house offers a 19' main bedroom and two further double bedrooms. The property is located within access of Andover, the A303 and Salisbury.

Inner Hall

Access to lounge, kitchen and cloakroom, stairs to first floor landing.

Lounge

14' 9" x 11' 8" max (4.50m x 3.56m max)
Front aspect, built in cupboard.

Kitchen/ Breakfast Room

11' 7" x 8' 8" (3.53m x 2.64m)
Comprising a single drainer unit with mixer taps, range of wall and base units with roll top work surfaces, built in oven, inset gas hob unit with steel hood over, space for dishwasher, space for washing machine, further appliance space, rear aspect with French doors to garden.

Cloakroom

Comprising a WC and wash hand basin.

First Floor Landing

Staircase to second floor.

Bedroom Two

12' x 10' 6" (3.66m x 3.20m)
Front aspect.

Bedroom Three

12' x 8' 9" (3.66m x 2.67m)
Rear aspect

Bathroom

Comprising a panel enclosed bath with built in shower and glass screen, pedestal wash hand basin and WC.

Second Floor Landing

Built in storage cupboard.

Bedroom One

19' 5" x 8' 4" (5.92m x 2.54m)
Dual aspect with four Velux style windows and built in storage cupboard.

Outside

Rear Garden

Offering a good sized patio and an area of lawn there is also a storage shed and a pathway leading to a rear gate. The garden is enclosed by panel fencing.

Double Width Driveway

To the front.







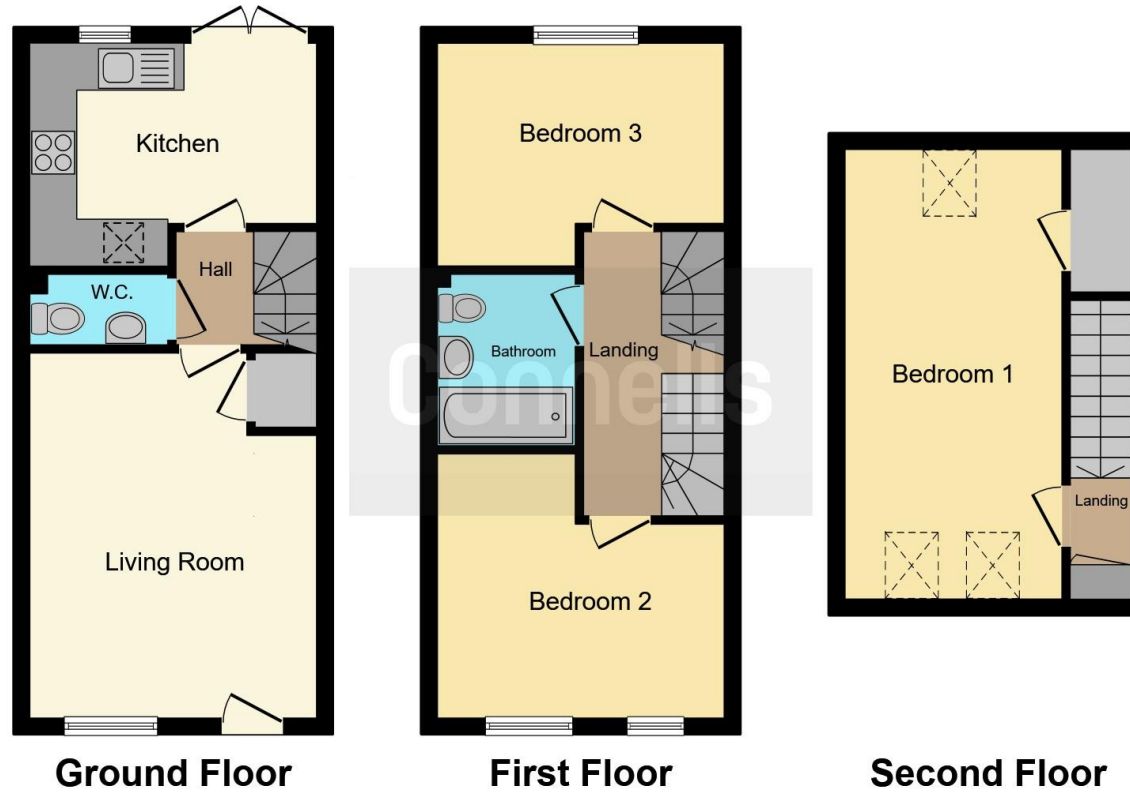

This floor plan is for illustrative purposes only. It is not drawn to scale. Any measurements, floor areas (including any total floor area), openings and orientation are approximate. No details are guaranteed, they cannot be relied upon for any purpose and they do not form part of any agreement. No liability is taken for any error, omission or misstatement. A party must rely upon its own inspection(s). Powered by www.focalagent.com

To view this property please contact Connells on

T 01980 622 662
E amesbury@connells.co.uk

Unit 3 23 Salisbury Street AMESBURY
 SALISBURY SP4 7AW

EPC Rating: B

Tenure: Freehold

view this property online connells.co.uk/Property/ABY308059



1. MONEY LAUNDERING REGULATIONS Intending purchasers will be asked to produce identification documentation at a later stage and we would ask for your co-operation in order that there will be no delay in agreeing the sale. 2. These particulars do not constitute part or all of an offer or contract. 3. The measurements indicated are supplied for guidance only and as such must be considered incorrect. Potential buyers are advised to recheck measurements before committing to any expense. 4. We have not tested any apparatus, equipment, fixtures, fittings or services and it is in the buyers interest to check the working condition of any appliances.

Connells Residential is registered in England and Wales under company number 1489613, Registered Office is Cumbria House, 16-20 Hockliffe Street, Leighton Buzzard, Bedfordshire, LU7 1GN. VAT Registration Number is 500 2481 05.

See all our properties at www.connells.co.uk | www.rightmove.co.uk | www.zoopla.co.uk

Property Ref: ABY308059 - 0002