



Connells

Pouncette Close
Amesbury Salisbury



Property Description

This LARGER style of one bedroom house offers a hallway, cloakroom, lounge and separate kitchen. Upstairs is a 16' bedroom and bathroom. As well as a larger garden to the rear, the property also benefits a double length driveway to the side. The A303 is just minutes away.

Entrance Hall

Doors to cloakroom, lounge and kitchen, stairs to first floor landing, stripped wood style floor.

Cloakroom

With wash hand basin and WC

Lounge

14' x 11' (4.27m x 3.35m)

Size incorporates a built in storage cupboard, rear aspect with door to garden.

Kitchen

8' 8" max x 8' 8" max (2.64m max x 2.64m max)

Comprising a single drainer sink unit with mixer taps, range of wall and base units with work surfaces over, wine rack, built in oven, gas hob unit with steel hood over, space for washing machine, further appliance space, built in and concealed fridge and freezer, front aspect.

Landing

Built in storage cupboard, further built in airing cupboard, access to loft space.

Bedroom

16' x 10' 7" plus recess (4.88m x 3.23m plus recess)

Large double wardrobe, front aspect.

Bathroom

Comprising a panel enclosed bath with wall mounted shower, pedestal wash hand basin and WC, heated towel rail.

Outside

Rear Garden

Low maintenance garden with patio and shingle and being enclosed by wall and panel fencing with gated access. There is also a floodlight and an external water supply.

Double Length Driveway

Directly to the side.







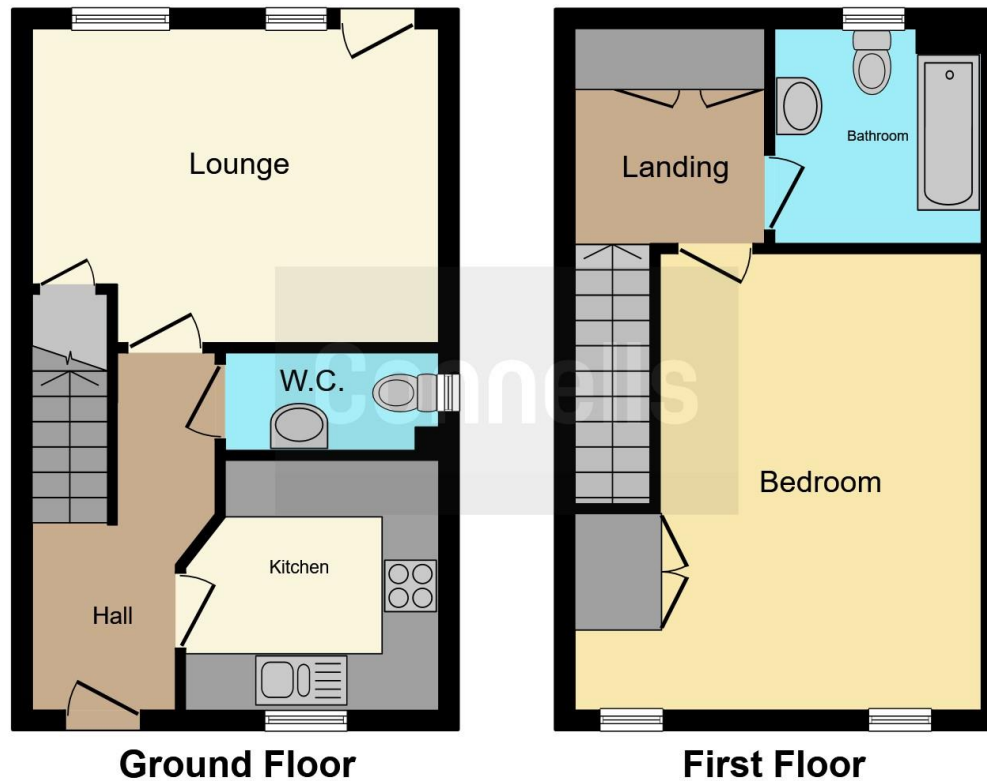

This floor plan is for illustrative purposes only. It is not drawn to scale. Any measurements, floor areas (including any total floor area), openings and orientation are approximate. No details are guaranteed, they cannot be relied upon for any purpose and they do not form part of any agreement. No liability is taken for any error, omission or misstatement. A party must rely upon its own inspection(s). Powered by www.focalagent.com

To view this property please contact Connells on

T 01980 622 662
E amesbury@connells.co.uk

Unit 3 23 Salisbury Street AMESBURY
 SALISBURY SP4 7AW

EPC Rating: C

Tenure: Freehold

view this property online connells.co.uk/Property/ABY307842



1. MONEY LAUNDERING REGULATIONS Intending purchasers will be asked to produce identification documentation at a later stage and we would ask for your co-operation in order that there will be no delay in agreeing the sale. 2. These particulars do not constitute part or all of an offer or contract. 3. The measurements indicated are supplied for guidance only and as such must be considered incorrect. Potential buyers are advised to recheck measurements before committing to any expense. 4. We have not tested any apparatus, equipment, fixtures, fittings or services and it is in the buyers interest to check the working condition of any appliances.

Connells Residential is registered in England and Wales under company number 1489613, Registered Office is Cumbria House, 16-20 Hockliffe Street, Leighton Buzzard, Bedfordshire, LU7 1GN. VAT Registration Number is 500 2481 05.

See all our properties at www.connells.co.uk | www.rightmove.co.uk | www.zoopla.co.uk

Property Ref: ABY307842 - 0005