



Castle Court Castle Street Salisbury SP1 3TS

for sale
£190,000



Property Description

Offering to the market this maisonette in Castle Court, Castle Street, Salisbury. This conveniently located property offers a lounge diner, kitchen, two bedrooms and a shower room. There is also a utility space and private garden. Located in the city centre the property has great access to all the amenities the city has to offer.

Salisbury offers a range of entertainment, shopping and cultural facilities including two cinemas, a theatre and numerous bars and restaurants. There is a twice weekly Charter market in the city centre. Salisbury has direct rail services to London Waterloo, Southampton and the West Country and is conveniently located for the New Forest and South Coast.



Ground Floor

Entrance hall with utility space to the right.
Stairs to first floor, Rear aspect.

First Floor

Lounge

19' x 9' 11" (5.79m x 3.02m)

Doors to stairs, bedroom two and inner hall
.Front aspect

Inner Hall

Doors to kitchen, lounge, shower room and
bedroom one.

Kitchen

10' 1" x 6' 9" (3.07m x 2.06m)

Comprising wall and base units with work
surfaces over, stainless steel sink drainer with
mixer tap, space for cooker, breakfast bar,
space for fridge freezer. Rear aspect.

Bedroom One

14' 11" max x 9' 9" max (4.55m max x 2.97m
max)

Front aspect.

Bedroom Two

8' 8" max x 6' 6" max (2.64m max x 1.98m
max)

Rear aspect.

Shower Room

Comprising shower cubicle with electric
shower, pedestal wash hand basin, WC.

Outside

Garden

Path to entrance door. Outside garden space
with room for garden furniture and raised
vegetable growing bed.







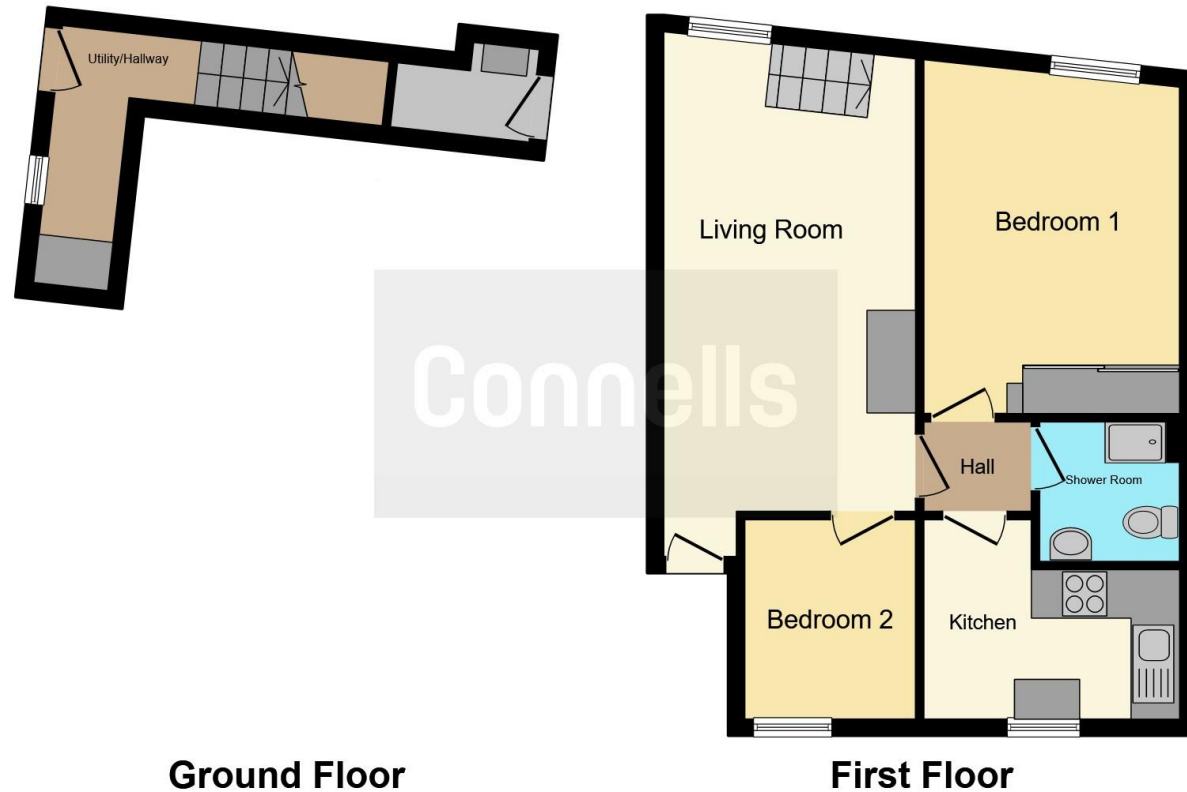

This floor plan is for illustrative purposes only. It is not drawn to scale. Any measurements, floor areas (including any total floor area), openings and orientation are approximate. No details are guaranteed, they cannot be relied upon for any purpose and they do not form part of any agreement. No liability is taken for any error, omission or misstatement. A party must rely upon its own inspection(s). Powered by www.focalagent.com

To view this property please contact Connells on

T 01722 328 562
E salisbury@connells.co.uk

46-50 Castle Street
 Salisbury SP1 3TS

EPC Rating: C

Tenure: Leasehold

view this property online connells.co.uk/Property/SAL307327

This is a Leasehold property with details as follows; Term of Lease 189 years from 14 Aug 1992. Should you require further information please contact the branch. Please Note additional fees could be incurred for items such as

1. MONEY LAUNDERING REGULATIONS Intending purchasers will be asked to produce identification documentation at a later stage and we would ask for your co-operation in order that there will be no delay in agreeing the sale. 2. These particulars do not constitute part or all of an offer or contract. 3. The measurements indicated are supplied for guidance only and as such must be considered incorrect. Potential buyers are advised to recheck measurements before committing to any expense. 4. We have not tested any apparatus, equipment, fixtures, fittings or services and it is in the buyers interest to check the working condition of any appliances.

Connells Residential is registered in England and Wales under company number 1489613, Registered Office is Cumbria House, 16-20 Hockliffe Street, Leighton Buzzard, Bedfordshire, LU7 1GN. VAT Registration Number is 500 2481 05.



See all our properties at www.connells.co.uk | www.rightmove.co.uk | www.zoopla.co.uk

Property Ref: SAL307327 - 0009