



Connells
01794
FOR SALE

Connells

Tottehale Close
North Baddesley Southampton



Property Description

This charming one-bedroom semi-detached house in North Baddesley (SO52 9NQ) is offered without chain, ideal for first-time buyers or investors. The property includes an entrance porch, fitted kitchen, lounge, bedroom with built-in wardrobe, and a bathroom. Features include a garden, allocated parking, and on-street parking. Close to local amenities, it offers excellent transport links via the M27, regular buses, and Romsey railway station. Local schools are highly rated, with North Baddesley Infant and Junior Schools rated "Good" and The Mountbatten School rated "Outstanding." Potential rental yield is approximately 4.85%, with an asking price of £198,000 and expected rent of £800 PCM.



Entrance Porch

The property is accessed via an entrance porch with a UPVC double glazed door to the front.

Lounge

- 16' 3" x 10' 9" (4.95m x 3.28m)
- Bay window to side aspect
 - Wood Laminate flooring
 - Radiator
 - Neutrally decorated

Kitchen

- 13' 6" x 5' 2" (4.11m x 1.57m)
- Wide range of wall base and drawer units above and below
 - Roll top work surfaces over
 - Space for a gas oven with gas hob
 - Localised tiling and extractor over hob
 - Tiled flooring
 - Stainless steel sink with hot and cold taps over
 - Double glazed window to rear aspect

Landing

Stairs descending to the lower level. Access is gained to bedroom and bathroom.

Bedroom One

- 10' 8" x 11' 3" (3.25m x 3.43m)
- Built-in wardrobe space
 - Floor laid to carpet

Bathroom

- 5' 2" x 7' 4" (1.57m x 2.24m)
- Bath with hot and cold taps over
 - Shower over bath
 - WC
 - Hand wash basin
 - Tiled floor and locally tiled walls
 - Wall-mounted radiator

Local Schools

The area is served by several well-regarded schools:

North Baddesley Infant School: Rated "Good" by Ofsted, providing quality education for younger children.

North Baddesley Junior School: Also rated "Good" by Ofsted, this school caters to older primary school children.

The Mountbatten School: A secondary school with an "Outstanding" rating from Ofsted, ensuring excellent education for older students.

Location

North Baddesley benefits from excellent transport links: Road: The village is conveniently located near the M27 motorway, providing easy access to Southampton, Portsmouth, and beyond. Bus: Regular bus services connect North Baddesley with Southampton city centre and other nearby towns. Rail: The nearest railway station is in Romsey, offering direct services to Southampton, Salisbury, and London.





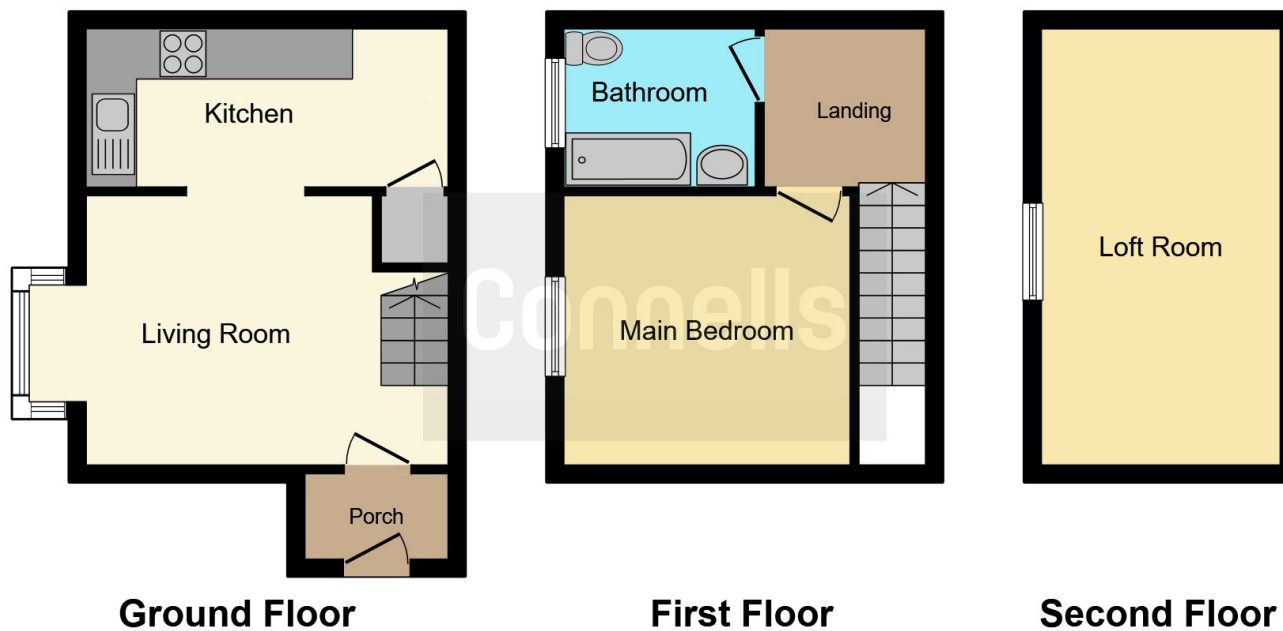

This floor plan is for illustrative purposes only. It is not drawn to scale. Any measurements, floor areas (including any total floor area), openings and orientation are approximate. No details are guaranteed, they cannot be relied upon for any purpose and they do not form part of any agreement. No liability is taken for any error, omission or misstatement. A party must rely upon its own inspection(s). Powered by www.focalagent.com

To view this property please contact Connells on

T 01794 830 833
E romsey@connells.co.uk

13a The Hundred
 ROMSEY SO51 8GD

EPC Rating: Awaited

Tenure: Freehold

view this property online connells.co.uk/Property/ROM306270



1. MONEY LAUNDERING REGULATIONS Intending purchasers will be asked to produce identification documentation at a later stage and we would ask for your co-operation in order that there will be no delay in agreeing the sale. 2. These particulars do not constitute part or all of an offer or contract. 3. The measurements indicated are supplied for guidance only and as such must be considered incorrect. Potential buyers are advised to recheck measurements before committing to any expense. 4. We have not tested any apparatus, equipment, fixtures, fittings or services and it is in the buyers interest to check the working condition of any appliances.

Connells Residential is registered in England and Wales under company number 1489613, Registered Office is Cumbria House, 16-20 Hockliffe Street, Leighton Buzzard, Bedfordshire, LU7 1GN. VAT Registration Number is 500 2481 05.

See all our properties at www.connells.co.uk | www.rightmove.co.uk | www.zoopla.co.uk

Property Ref: ROM306270 - 0005