



Connells

Stoke Heights
Fair Oak Eastleigh



Property Description

Welcome to your charming abode in the heart of Fair Oak!

This delightful mid-terraced house boasts a spacious lounge diner, perfect for entertaining or cosy nights in.

The kitchen, complete with an integral oven, seamlessly connects to the garden, offering a delightful space for al fresco dining or morning coffee.

Upstairs, you'll find two generously sized double bedrooms and a modern shower room, providing both comfort and convenience.

Outside, the rear garden beckons with a combination of patio, pergola, and lawn areas, ideal for relaxation or outdoor gatherings.

Convenience meets practicality with a garage in the block and off-road parking, ensuring ample space for your vehicles. Nestled in a desirable and tranquil residential area, this property is perfect for first-time buyers seeking a welcoming home or investors looking for a promising opportunity.

Don't miss your chance to make this Fair Oak gem your own!

Lounge

13' 2" x 11' 6" (4.01m x 3.51m)

Double glazed window to front aspect. Radiator. TV port. Laminate flooring. Under stairs cupboard.

Kitchen

11' 5" x 8' 4" (3.48m x 2.54m)

Double glazed window and door to rear aspect. Fitted kitchen with wall and base units. Integral oven and hob. Stainless steel sink and drainer. Space for fridge freezer. Space for washing machine. Radiator.



Bedroom 1

11' 6" x 8' 5" (3.51m x 2.57m)
Double glazed window to front aspect. Airing cupboard. Loft hatch. Carpet.

Bedroom 2

11' 5" x 7' 8" (3.48m x 2.34m)
Double glazed window to front aspect. Laminate flooring. Radiator.

Bathroom

WC. Vanity sink. Walk in shower. Extractor fan.

Outside

Rear garden. Patio area with stepping stones to rear. Lawn area. Rear access.

Garage In Block



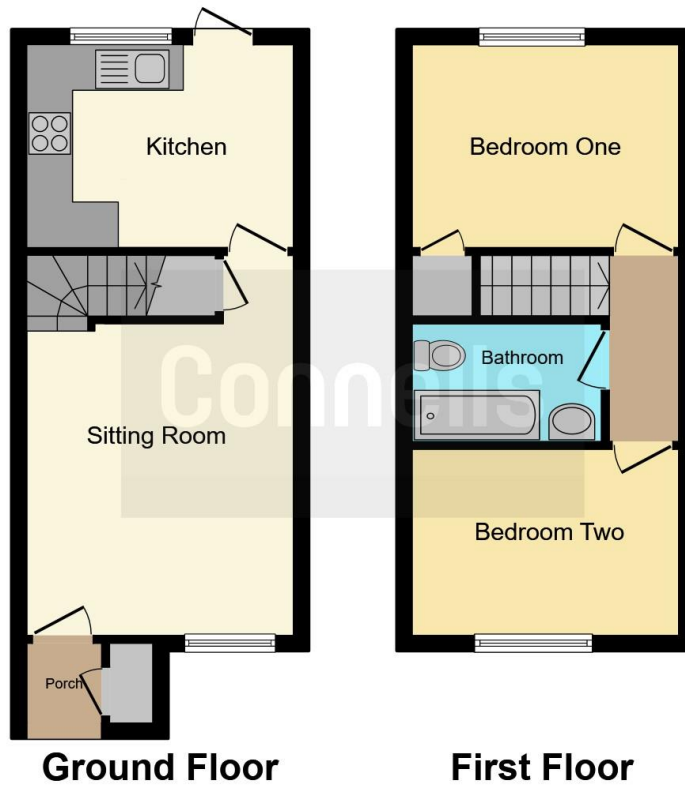

This floor plan is for illustrative purposes only. It is not drawn to scale. Any measurements, floor areas (including any total floor area), openings and orientation are approximate. No details are guaranteed, they cannot be relied upon for any purpose and they do not form part of any agreement. No liability is taken for any error, omission or misstatement. A party must rely upon its own inspection(s). Powered by www.focalagent.com

To view this property please contact Connells on

T 02380 618 343
E eastleigh@connells.co.uk

19 Market Street
 EASTLEIGH SO50 5RH

EPC Rating: C

view this property online connells.co.uk/Property/EGH308530

Tenure: Freehold



1. MONEY LAUNDERING REGULATIONS Intending purchasers will be asked to produce identification documentation at a later stage and we would ask for your co-operation in order that there will be no delay in agreeing the sale. 2. These particulars do not constitute part or all of an offer or contract. 3. The measurements indicated are supplied for guidance only and as such must be considered incorrect. Potential buyers are advised to recheck measurements before committing to any expense. 4. We have not tested any apparatus, equipment, fixtures, fittings or services and it is in the buyers interest to check the working condition of any appliances.

Connells Residential is registered in England and Wales under company number 1489613, Registered Office is Cumbria House, 16-20 Hockliffe Street, Leighton Buzzard, Bedfordshire, LU7 1GN. VAT Registration Number is 500 2481 05.

See all our properties at www.connells.co.uk | www.rightmove.co.uk | www.zoopla.co.uk

Property Ref: EGH308530 - 0004