



**Connells**

Mitchell House Southampton Road  
Eastleigh



# Mitchell House Southampton Road Eastleigh SO50 9SD

for sale guide price  
**£155,000**



## Property Description

This modern and well-maintained ground floor apartment is ideally located in the heart of Eastleigh town centre.

The property boasts a spacious open-plan lounge and kitchen, finished to a high standard and complete with integral appliances, creating a bright and practical living space.

There is a generous double bedroom and a stunning contemporary bathroom, both beautifully presented.

Situated just moments from Eastleigh's shops, restaurants and leisure facilities, the apartment also benefits from excellent transport links, making it perfect for commuters and those seeking convenience right on their doorstep.

## Entrance Hall

Built in airing cupboard. Telephone intercom.

## Lounge

Double glazed window to rear aspect with views over car park. Electric heaters x2. TV port.

## Kitchen

Modern fitted kitchen with wall and base units. Integrated Fridge freezer and dishwasher. Integral washer dryer. Electric hob and oven with extractor hood. Stainless steel sink and drainer.



## Bedroom

Double glazed window to rear aspect. Electric radiator. TV port.

## Bathroom

Shower over bath with shower screen. Vanity sink and unit with pull out drawers. Toilet. Electric towel rail. Part tiled. Extractor fan.



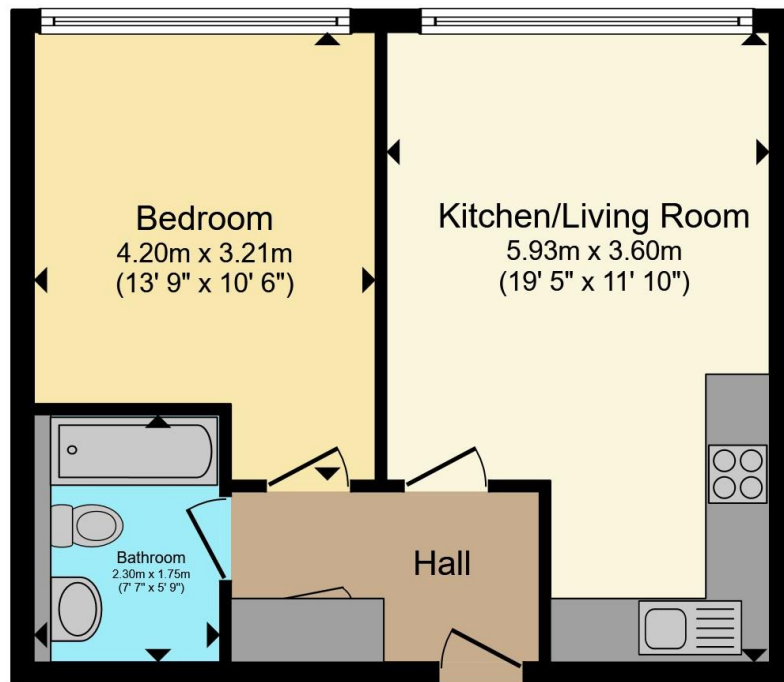

**Floor Plan**

Total floor area 41.0 m<sup>2</sup> (441 sq.ft.) approx

This floor plan is for illustrative purposes only. It is not drawn to scale. Any measurements, floor areas (including any total floor area), openings and orientation are approximate. No details are guaranteed, they cannot be relied upon for any purpose and they do not form part of any agreement. No liability is taken for any error, omission or misstatement. A party must rely upon its own inspection(s). Powered by [www.propertybox.io](http://www.propertybox.io)

**Connells**



To view this property please contact Connells on

**T 02380 618 343**  
**E [eastleigh@connells.co.uk](mailto:eastleigh@connells.co.uk)**

19 Market Street  
 EASTLEIGH SO50 5RH

EPC Rating: D

Council Tax  
 Band: A

Service Charge:  
 1008.44

Ground Rent:  
 148.00

Tenure: Leasehold

**view this property online [connells.co.uk/Property/EGH309483](http://connells.co.uk/Property/EGH309483)**

This is a Leasehold property with details as follows; Term of Lease 125 years from 01 Oct 2019. Should you require further information please contact the branch. Please Note additional fees could be incurred for items such as Leasehold packs.



1. MONEY LAUNDERING REGULATIONS Intending purchasers will be asked to produce identification documentation at a later stage and we would ask for your co-operation in order that there will be no delay in agreeing the sale. 2. These particulars do not constitute part or all of an offer or contract. 3. The measurements indicated are supplied for guidance only and as such must be considered incorrect. Potential buyers are advised to recheck measurements before committing to any expense. 4. We have not tested any apparatus, equipment, fixtures, fittings or services and it is in the buyers interest to check the working condition of any appliances.

Connells Residential is registered in England and Wales under company number 1489613, Registered Office is Cumbria House, 16-20 Hockliffe Street, Leighton Buzzard, Bedfordshire, LU7 1GN. VAT Registration Number is 500 2481 05.

**See all our properties at [www.connells.co.uk](http://www.connells.co.uk) | [www.rightmove.co.uk](http://www.rightmove.co.uk) | [www.zoopla.co.uk](http://www.zoopla.co.uk)**

Property Ref: EGH309483 - 0002