



Connells

Windermere Avenue
Southampton



Property Description

****CASH BUYERS ONLY****Connells are delighted to bring to market this charming three-bedroom semi-detached house located in the sought-after and convenient area of Millbrook. This property boasts numerous features such as double-glazing windows and gas central heating, ensuring warmth and energy efficiency throughout the year. It also benefits from a sizeable driveway allowing ample off-road parking.

Downstairs you will find a spacious living room that accommodates both relaxation and dining, offering space for a dining table if you wish. The kitchen provides plenty of cupboard space, ensuring your cooking experience is easy and your kitchen remains clutter-free. Adjacent to the kitchen, there is an additional W/C and a utility room, perfect for extra storage. This area then leads out onto the beautiful garden, which features well-kept flowerbeds, and two sheds for even more storage!

Upstairs is comprised of three well-sized bedrooms, two of which include built-in storage, and all boast neutral decor. The modern wet room is equipped with a shower, hand washing basin, and toilet.

Situated just a short drive away from Shirley high street where there are a range of shops, supermarkets, bars, and restaurants as well as other leisure facilities. Southampton General hospital is also nearby. Totton and Millbrook train stations are both within two miles of the house and M3 and M27 motorway links are less than a 5-minute drive away.

Hallway

Living Room

21' 8" x 11' 7" (6.60m x 3.53m)

Kitchen

11' 8" x 8' 3" (3.56m x 2.51m)

Hallway

Toilet W/C

Utility Room

9' 3" x 5' 2" (2.82m x 1.57m)

Stairs Leading to First Floor

Landing

Wet Room

6' 6" x 5' 4" (1.98m x 1.63m)

Bedroom 1

13' 5" x 10' 4" (4.09m x 3.15m)

With Built-In Storage

Bedroom 2

13' 5" x 11' (4.09m x 3.35m)

Bedroom 3

8' 9" x 7' 8" (2.67m x 2.34m)

With Built-In Storage







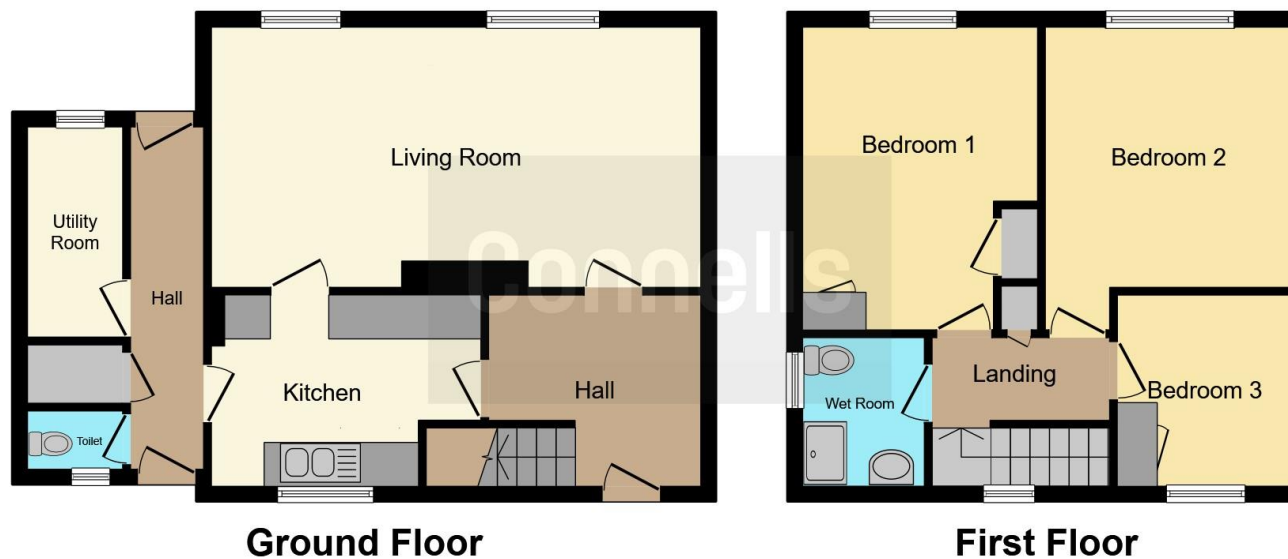

This floor plan is for illustrative purposes only. It is not drawn to scale. Any measurements, floor areas (including any total floor area), openings and orientation are approximate. No details are guaranteed, they cannot be relied upon for any purpose and they do not form part of any agreement. No liability is taken for any error, omission or misstatement. A party must rely upon its own inspection(s). Powered by www.focalagent.com

To view this property please contact Connells on

T 02380 789 351
E shirley@connells.co.uk

409 Shirley Road Shirley
 SOUTHAMPTON SO15 3JD

EPC Rating: D

view this property online connells.co.uk/Property/SSR311325

Tenure: Freehold



1. MONEY LAUNDERING REGULATIONS Intending purchasers will be asked to produce identification documentation at a later stage and we would ask for your co-operation in order that there will be no delay in agreeing the sale. 2. These particulars do not constitute part or all of an offer or contract. 3. The measurements indicated are supplied for guidance only and as such must be considered incorrect. Potential buyers are advised to recheck measurements before committing to any expense. 4. We have not tested any apparatus, equipment, fixtures, fittings or services and it is in the buyers interest to check the working condition of any appliances.

Connells Residential is registered in England and Wales under company number 1489613, Registered Office is Cumbria House, 16-20 Hockliffe Street, Leighton Buzzard, Bedfordshire, LU7 1GN. VAT Registration Number is 500 2481 05.

See all our properties at www.connells.co.uk | www.rightmove.co.uk | www.zoopla.co.uk

Property Ref: SSR311325 - 0005