

for sale

£240,000



Fearney Mead Mill End Rickmansworth WD3 8QF

A spacious one/two bedroom apartment located a short distance from Rickmansworth town centre. The property is in good decorative order and benefits from a recently refitted kitchen and bathroom, an entryphone system, double glazing, gas central heating, a study alcove and a long lease.



Fearney Mead Mill End Rickmansworth WD3 8QF

Entrance Hall

Front door, radiator, entryphone system, airing cupboard, walk in storage cupboard housing meters, wood laminate flooring.

Study Alcove

5' 8" x 4' 8" (1.73m x 1.42m)
Wood laminate flooring.

Lounge / Dining Room

10' 5" x 16' (3.17m x 4.88m)
Double glazed window to front aspect, television point, radiator, wood laminate flooring, archway to kitchen.

Kitchen

11' 2" x 10' 5" (3.40m x 3.17m)

Wall and base units, work surfaces, stainless steel sink and drainer, tiling to walls, integrated stainless steel oven, hob, extractor hood, plumbing for washing machine, space for fridge/freezer, double glazed window to front aspect, ceramic tiled floor.

Bedroom One

11' 11" x 8' 11" (3.63m x 2.72m)

Double glazed window to front aspect, fitted wardrobes with sliding doors and wood laminate flooring.

Bathroom

Double glazed window to rear aspect, bath with power shower over, pedestal wash hand basin, low level WC, chrome heated towel rail, fully tiled walls and tiled floor.



Exterior

Resident's Parking.



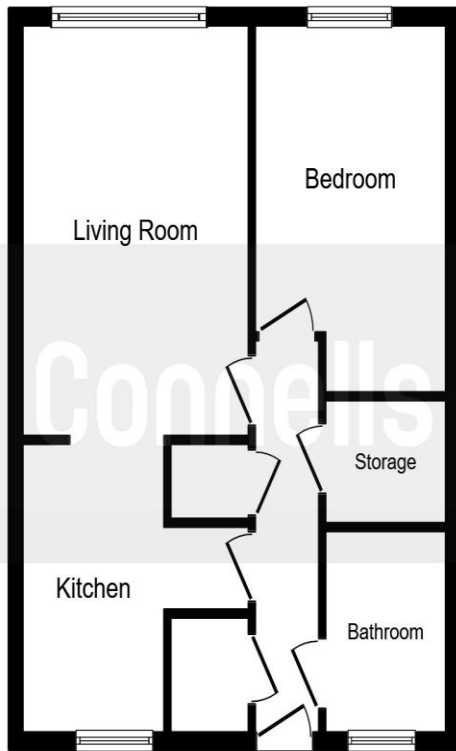

Floor Plan

This floor plan is for illustrative purposes only. It is not drawn to scale. Any measurements, floor areas (including any total floor area), openings and orientation are approximate. No details are guaranteed, they cannot be relied upon for any purpose and they do not form part of any agreement. No liability is taken for any error, omission or misstatement. A party must rely upon its own inspection(s).
Plan produced for Connells. Powered by www.focalagent.com

To view this property please contact Connells on

T 01923 230 403
E watford@connells.co.uk

6 The Parade
WATFORD WD17 1AA

Property Ref: WTF310881 - 0003

Tenure: Leasehold

EPC Rating: D

view this property online connells.co.uk/Property/ref-WTF310881

Lease details are currently being compiled. For further information please contact the branch. Please note additional fees could be incurred for items such as leasehold packs.



1. MONEY LAUNDERING REGULATIONS Intending purchasers will be asked to produce identification documentation at a later stage and we would ask for your co-operation in order that there will be no delay in agreeing the sale. 2. These particulars do not constitute part or all of an offer or contract. 3. The measurements indicated are supplied for guidance only and as such must be considered incorrect. Potential buyers are advised to recheck measurements before committing to any expense. 4. We have not tested any apparatus, equipment, fixtures, fittings or services and it is in the buyers interest to check the working condition of any appliances.